



# RAFFLES GIRLS' PRIMARY SCHOOL

## SEMESTRAL ASSESSMENT (2)

2005

Name: \_\_\_\_\_ Class: P3 \_\_\_\_\_ Index No: \_\_\_\_\_

Your Score Out of 100 marks		
	Class	Level
Highest score		
Average score		
Parent's Signature		

October 2005

**MATHEMATICS**

ATT: 1 h 45 min

### Section A (20 × 2 marks)

For each question, four options are given. Choose the correct answer and write its number (1, 2, 3 and 4) in the bracket provided.

1. Complete the number pattern below.

4599, \_\_\_\_\_, 4579, 4569

- (1) 4499
- (2) 4589
- (3) 4609
- (4) 4699

( )

2. The sum of 46 and 1463 is \_\_\_\_\_.

- (1) 1409
- (2) 1417
- (3) 1509
- (4) 1923

( )

3. Express 7 m 9 cm in cm:

- (1) 79
- (2) 709
- (3) 790
- (4) 7900

( )

4. What is the mass of the bag of tomatoes?

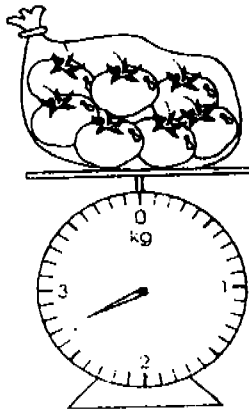

- (1) 2 kg 7 g  
(2) 2 kg 70 g  
(3) 2 kg 700 g  
(4) 2 kg 1000 g

( )

5. What is the volume of the water in the beaker?

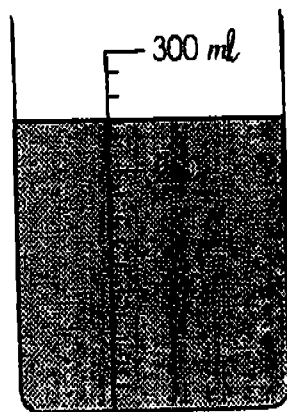

- (1) 220 ml  
(2) 230 ml  
(3) 240 ml  
(4) 250 ml

( )

6. What is the total amount of money shown below?

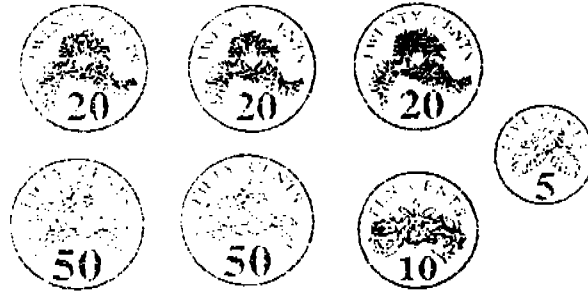

- (1) \$0.75
- (2) \$1.25
- (3) \$1.75
- (4) \$2.25

( )

7.

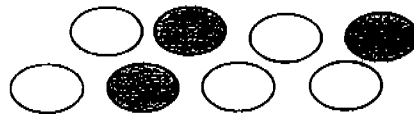

What fraction of the figure above is shaded?

(1)  $\frac{3}{7}$

(2)  $\frac{3}{8}$

(3)  $\frac{1}{3}$

(4)  $\frac{1}{2}$

( )

18

8. Which one of the following angles is **smaller than a right angle**?

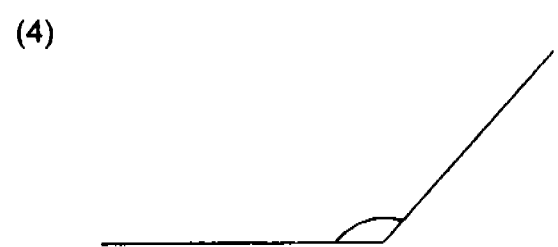
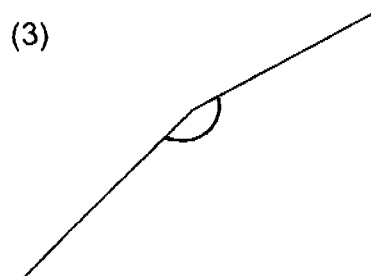
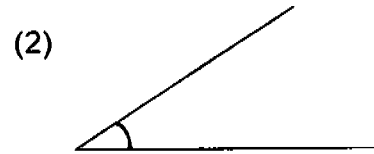
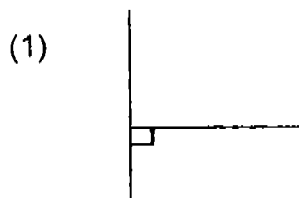

( )

9. When 255 is added to 1150, the digit \_\_\_\_\_ is in the hundreds place.

- (1) 1
- (2) 0
- (3) 5
- (4) 4

( )

10. Which of the following numbers are arranged in **descending** order?

- (1) 1250, 1200, 1150, 1300
- (2) 2800, 2850, 2900, 2950
- (3) 3280, 3260, 3240, 3220
- (4) 4020, 4040, 4060, 4100

( )

11. Add 45 tens to 1518.  
What is the answer?

- (1) 1518
- (2) 1563
- (3) 1968
- (4) 2068

( )

12. A puppy has a mass of 3 kg. A kitten is 856 g lighter than the puppy. What is the mass of the kitten in kg and g?

- (1) 2 kg 144 g
- (2) 2 kg 254 g
- (3) 3 kg 144 g
- (4) 3 kg 856 g

( )

13. Paul bought 3 bottles of tomato sauce at \$1.50 each.  
If he had given the cashier \$10, how much change would he receive?

- (1) \$ 5.50
- (2) \$ 6.50
- (3) \$ 7.00
- (4) \$ 7.50

( )

14. The graph below shows the number of fruits in Tommy's shop.

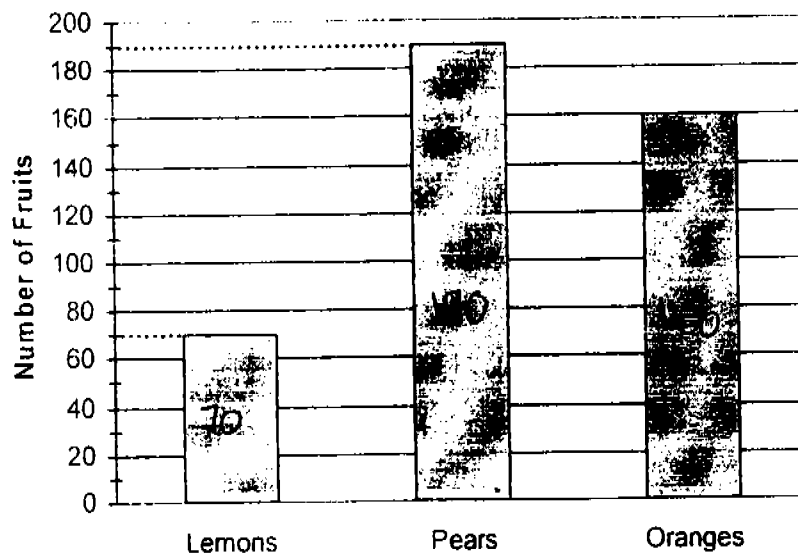

How many more oranges were there in the shop than lemons?

- (1) 70
- (2) 90
- (3) 100
- (4) 120

( )

15.  $\frac{3}{12}$  has the same value as \_\_\_\_\_.

- (1)  $\frac{1}{2}$
- (2)  $\frac{1}{4}$
- (3)  $\frac{2}{3}$
- (4)  $\frac{5}{6}$

( )

16. Ben's clock is running 20 minutes fast.  
What time should it be now?

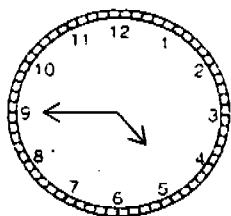

- (1) 20 minutes past 4
- (2) 25 minutes past 4
- (3) 5 minutes past 5
- (4) 15 minutes past 5

( )

17. Find the perimeter of the figure below.

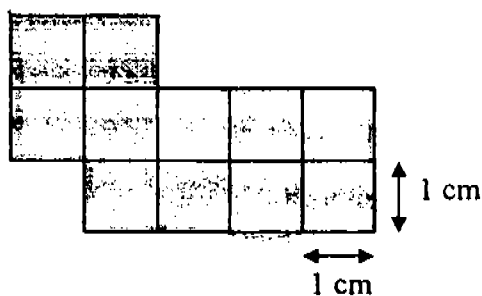

- (1) 13 cm
- (2) 14 cm
- (3) 15 cm
- (4) 16 cm

( )

18. ~~Divide~~ half of 50 by 4.  
What is the quotient?

- (1) 1
- (2) 6
- (3) 12
- (4) 4

( )

19. An English lesson began at 1.45 p.m. and ended at 3 p.m.  
How long was the lesson?

- (1) 1 h 15 min
- (2) 1 h 45 min
- (3) 2 h 15 min
- (4) 3 h 45 min

( )

20. What is the perimeter of the figure?

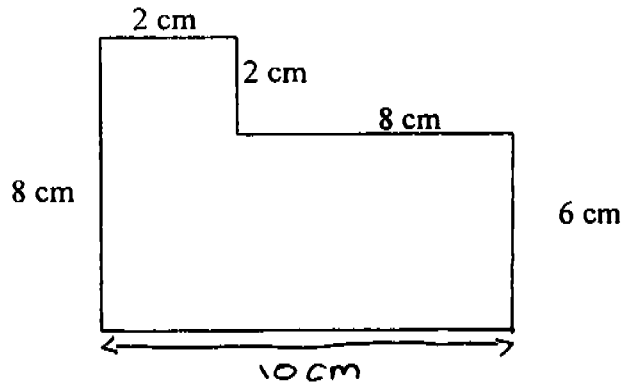

- (1) 26 cm
- (2) 34 cm
- (3) 36 cm
- (4) 38 cm

( )



Section B (20 × 2 marks)

Work out each sum carefully and write its correct answer in the box provided.

21. In 8905, the digit  is in the thousands place:

22. What is the difference between 599 and 995?

23. What is the product of 46 and 7?

24. The graph below shows the number of books borrowed from the National Library in the first 4 months of last year.

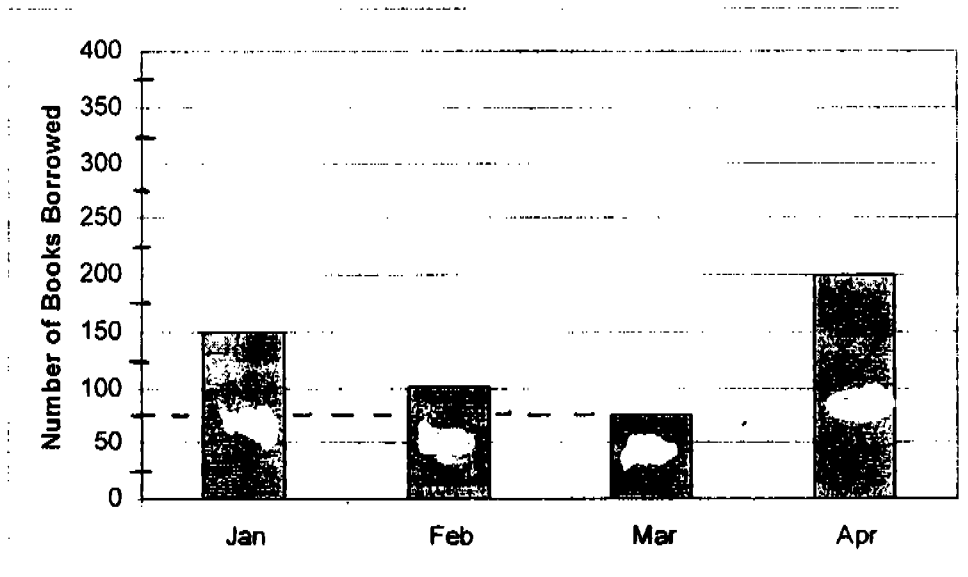

The total number of books borrowed in the first two months was .

25. Arrange the following fractions beginning with the ~~smallest~~ smallest in value:

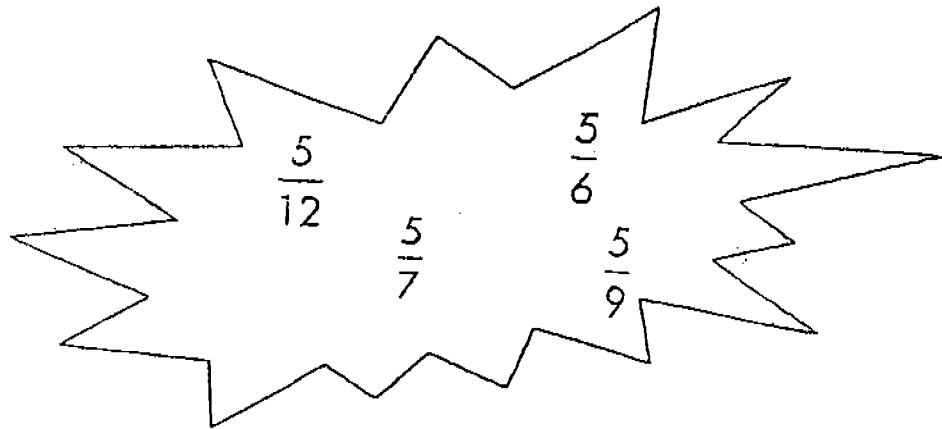

26.  $100 \text{ s} =$   min  s.

27. Find the area of this figure.

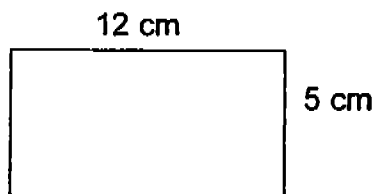
  $\text{cm}^2$ 

28. What is 10 more than 50 hundreds?  
Write your answer in words.

29.  $15\text{ m } 176\text{ cm} = \boxed{\phantom{00000}}$  cm

30. Subtract 500 g from 9 kg 50 g.

The answer is  $\boxed{\phantom{000}}\text{ kg } \phantom{000}\text{ g}$

31. Add 750 ml to 6250 ml.

Write your answer in litres.

$\boxed{\phantom{0000}}$  litres

32. 4 fifty-cent coins and 8 twenty-cent coins equal \$  $\boxed{\phantom{000}}$

33. The graph below shows the number of stickers collected by four girls.

Number of stickers collected by 4 girls	
Betty	$\boxed{\phantom{00}} \quad \boxed{\phantom{00}} \quad \boxed{\phantom{00}} \quad \boxed{\phantom{00}} \quad \boxed{\phantom{00}}$
Lucy	$\boxed{\phantom{00}} \quad \boxed{\phantom{00}} \quad \boxed{\phantom{00}} \quad \boxed{\phantom{00}} \quad \boxed{\phantom{00}} \quad \boxed{\phantom{00}}$
Joyce	$\boxed{\phantom{00}} \quad \boxed{\phantom{00}} \quad \boxed{\phantom{00}} \quad \triangle \quad \boxed{\phantom{00}} \quad \boxed{\phantom{00}}$
Ashley	$\boxed{\phantom{00}} \quad \boxed{\phantom{00}}$

Each  $\boxed{\phantom{00}}$  stands for 10 stickers

The total number of stickers collected by the girls was  $\boxed{\phantom{00000}}$

34. Fill in the missing number in the box.

$$\frac{4}{12} = \frac{\boxed{\phantom{000}}}{6}$$

35. There are  right angles in the figure given below.

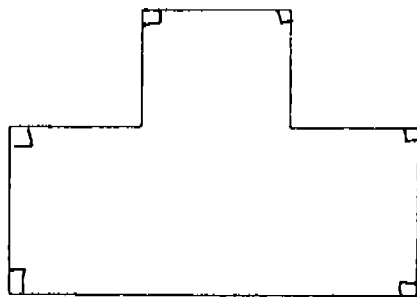

36. Study the number pattern carefully. Write the missing number in the box.

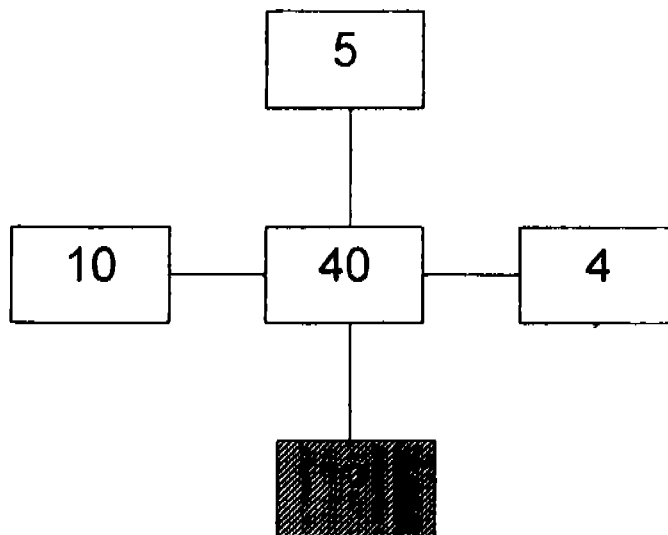

37.  $1600 - 900 = 1000 - \boxed{\phantom{000}}$

What is the number in the box?

38.  $81 \div 9 = 6 + \boxed{\phantom{00}}$

Write the missing number in the box.

39. Bottle A can hold 2 l 500 ml of water. Bottle B can hold 800 ml more. How much water can the two bottles hold altogether?

     l      ml

40. Jane ate 2 sweets out of a box of 10 sweets. What fraction of sweets were left in the box? Give your answer in its simplest form.

Section C (20 marks)

In this section, show all your working clearly in the space provided.  
The number of marks awarded to each question is shown in the brackets at the end of the question.

Working

41. On Thursday, Sam travelled **twice** as far as he travelled on Wednesday.  
If he travelled a **total distance** of 276 km on the two days, how far did he travel on Thursday? (3 m)

42. Joseph is 2 years 5 months **older** than his brother.  
If his brother is 12 years 9 months old, how old is Joseph? (3 m)

43. A salesman was given 5000 pens to sell.  
He sold 2551 pens in June and 1360 in July.  
How many more pens had he left to sell after July? (3 m)

44. The perimeter of a square field is 48 m. Find the area of  
the square field. (3 m)

45. Andrea was fixing wheels to 244 toy cars in a factory.  
Each car was to have 4 wheels.  
Andrea was given only 640 wheels.  
How many more wheels would Andrea need to have ? (4 m)

46. 4 belts and 2 wallets cost a total of \$64.  
Find the cost of a wallet if a belt is cheaper than a wallet by \$5. (4 m)

--- End ---

Setters: Mrs Clara Tang  
Mr Lim Choon Hock



**Raffles Girls Primary School**  
**Primary 3 Maths SA2 Exam (2005)**

*Exam Solutions*

**Answer Sheets**

Q1	Q2	Q3	Q4	Q5
2	3	2	3	3
Q6	Q7	Q8	Q9	Q10
3	2	2	4	3
Q11	Q12	Q13	Q14	Q15
3	1	1	2	2
Q16	Q17	Q18	Q19	Q20
2	4	2	1	3

- |   |                           |
|---|---------------------------|
| 21. 8   | 34. $\frac{2}{6}$         |
| 22. 396   | 35. 6                     |
| 23. 322   | 36. 8                     |
| 24. 250   | 37. 300                   |
| 25. $\frac{5}{12}, \frac{5}{9}, \frac{5}{7}, \frac{5}{6}$ | 38. 3                     |
| 26. 1 minutes 40 seconds                                  | 39. 5l 800ml              |
| 27. 60cm <sup>2</sup>                                     | 40. $\frac{4}{5}$         |
| 28. Five thousand and ten                                 | 41. Sam traveled 184km    |
| 29. 1676  | 42. 15 years 2 months old |
| 30. 8kg 550g  | 43. 1089                  |
| 31. 7l  | 44. 144m <sup>2</sup>     |
| 32. \$3.60  | 45. 336                   |
| 33. 185   | 46. \$14.00               |