

STAPLE HERE

FOR OFFICIAL USE

--	--	--	--	--	--	--	--

G

1330/402

NATIONAL QUALIFICATIONS 2010
TUESDAY, 18 MAY
10.35 AM – 12.05 PM

GRAPHIC COMMUNICATION
STANDARD GRADE
General Level

Fill in these boxes and read what is printed below.

Full name of centre				Town			
<input type="text"/>				<input type="text"/>			
Forename(s)				Surname			
<input type="text"/>				<input type="text"/>			
Date of birth		Scottish candidate number		Number of seat			
Day	Month	Year					
<input type="text"/>	<input type="text"/>	<input type="text"/>	<input type="text"/>	<input type="text"/>	<input type="text"/>	<input type="text"/>	<input type="text"/>

1 95 marks are allocated to this paper: 35 marks for Knowledge and Interpretation
60 marks for Drawing Abilities

- 2 Answer all questions.
- 3 Read each question carefully before you answer.
- 4 Written answers may be in **ink** or **pencil**.
- 5 Drawings and sketches **must be in pencil**.
- 6 Sketches need only be in line form—do not spend time rendering.
- 7 Dimensions are given in millimetres or as stated.
- 8 Orthographic drawings are in third angle projection.
- 9 For each question, the element being tested and the mark allocation are shown in brackets, eg (DA 5) means a question on Drawing Abilities worth 5 marks.
- 10 **At the end of the examination**

check that your name is on every sheet;
put the sheets in correct numerical order;
place this sheet on top of the others;
join all sheets together by **stapling** at the top left-hand corner;

	KI	DA
1		
2		
3		
4		
5		
6		
7		
8		
9		
Total Marks		



[BLANK PAGE]

Drawings of a van are shown opposite. State the single CAD command that would be used to create the following details.

- (a) The straight edge shown at **A**.
Command
- (b) The rounded corner shown at **B**.
Command
- (c) The curved surface shown at **C**.
Command
- (d) The angled corner shown at **D**.
Command
- (e) The circumference of the wheel shown at **E**.
Command
- (f) The name of the view shown at **F**.
Command
- (g) The gap in the line **X** shown at **G**.
Command
- (h) The identical wheel shown at **H**.
Command
- (i) The identical features around the wheel shown at **I**.
Command
- (j) The enlarged view of the wheel shown at **J**.
Command

Total (KI 10)

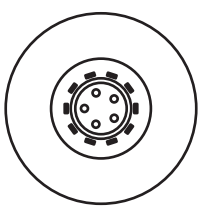
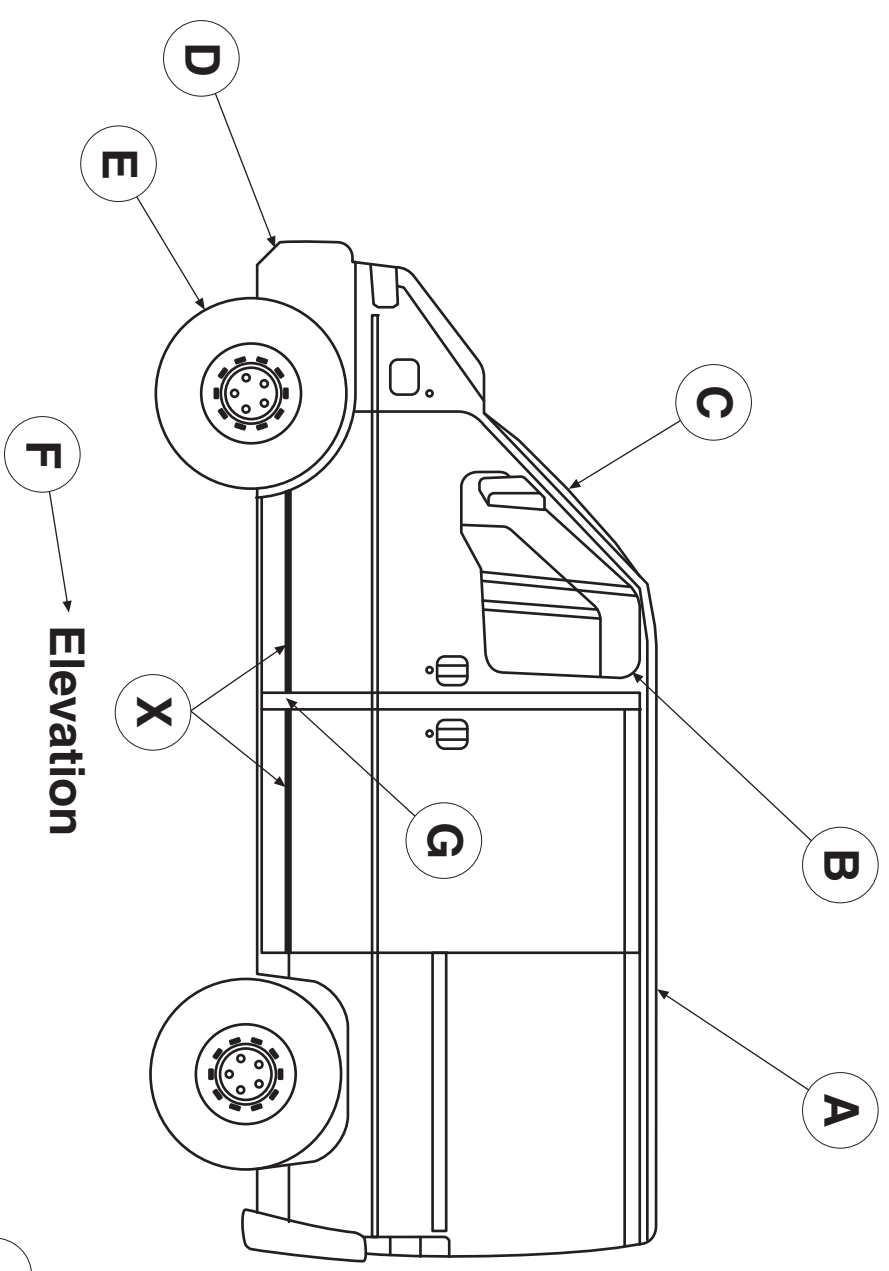

Wheel **H**

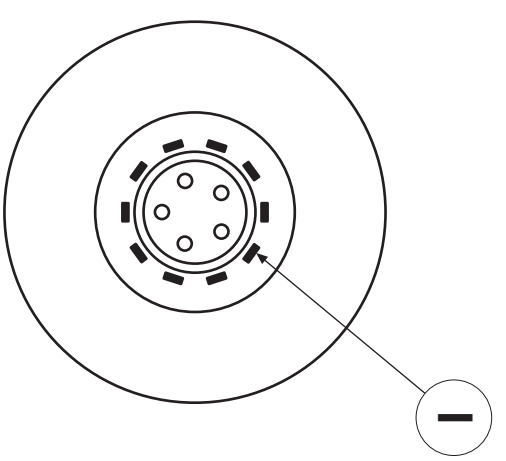

Enlarged Wheel **J**

Study the building drawings opposite.

(a) Identify the symbols **A, B, C, D** and **E** on the Floor Plan of the Kitchen.

- A.....
- B.....
- C.....
- D.....
- E.....

KI 5

(b) Identify the symbols **F, G** and **H** on the Floor Plan of the Bathroom.

- F.....
- G.....
- H.....

Total (KI 8)

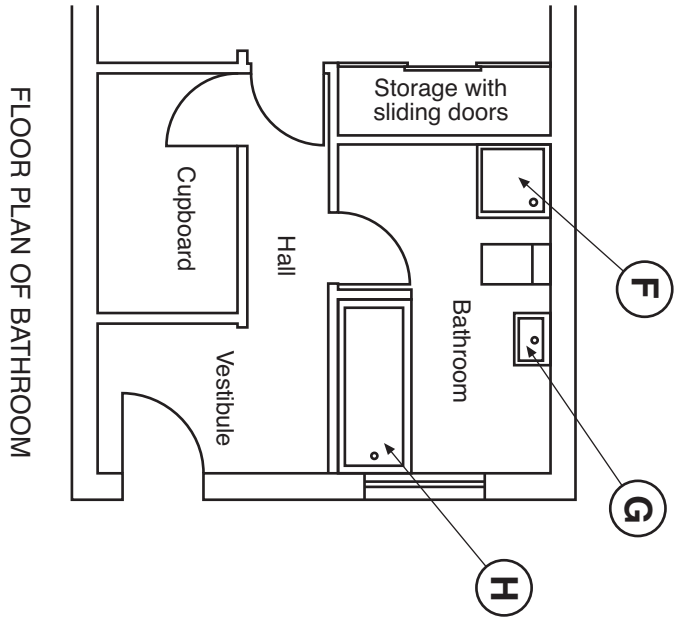
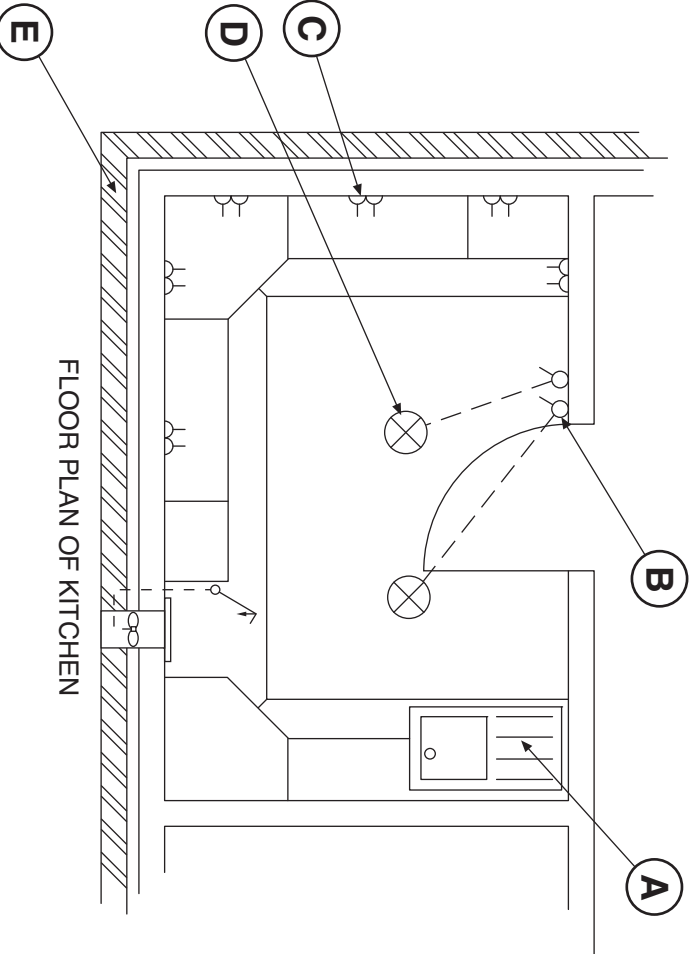

Four pictorial drawings are given opposite.

(a) State the names given to the types of pictorial shown at **P, Q, R** and **S**.

P

R **Q** **KI 4**

(b) State the name given to **Line L** on **View S**.

S **Answer** **KI 1**

(c) State the name given to **Points 1** and **2** on **View S**.

Answer **KI 1**

(d) State the angles used at **M** and **N** on **View R**.

Angle M **Angle N** **KI 2**

Total (KI 8)

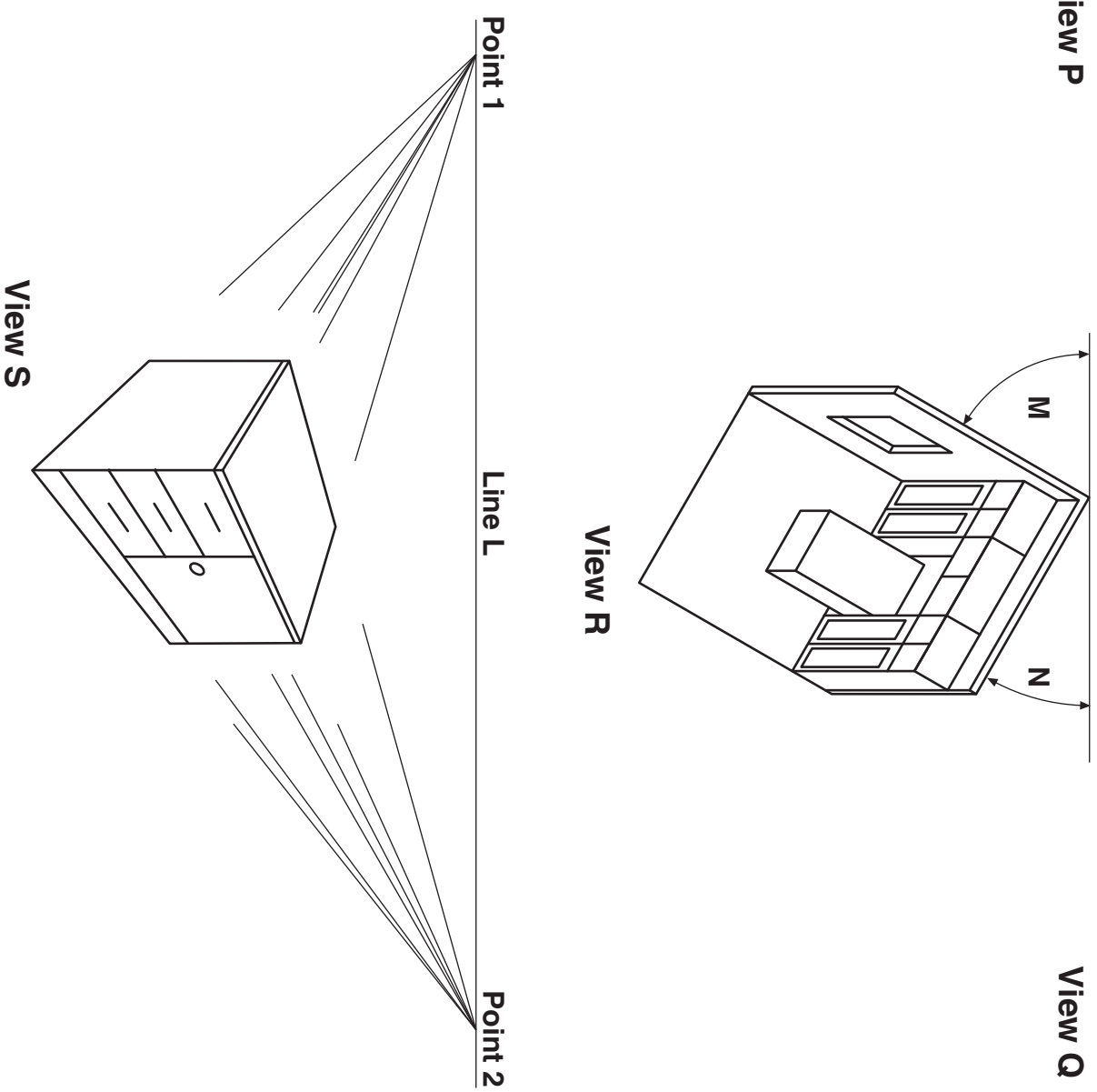
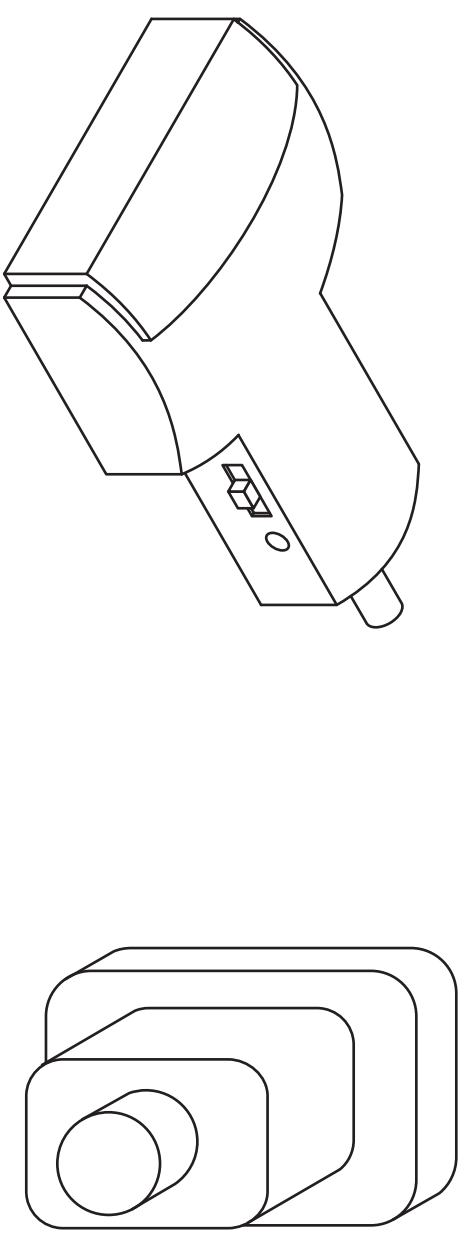

Colour can be used for many different reasons.

- (a) State what is added to red to make it a shade of red.

Answer **KI 1**

- (b) State what is added to red to make it a tint of red.

Answer **KI 1**

- (c) State **two** tertiary colours that contain blue.

Colour Colour **KI 2**

- (d) State what must be added to a primary colour in order to obtain a tertiary colour.

Answer **KI 1**

- (e) Colours can be used to create different moods and feelings. State what colour is associated with the following.

- (i) To represent happiness.

Colour

- (ii) To represent that something is cool.

Colour

- (iii) To represent something that is safe for the environment.

Colour

- (iv) To represent that something is dangerous.

Colour **KI 4**

Total (KI 9)

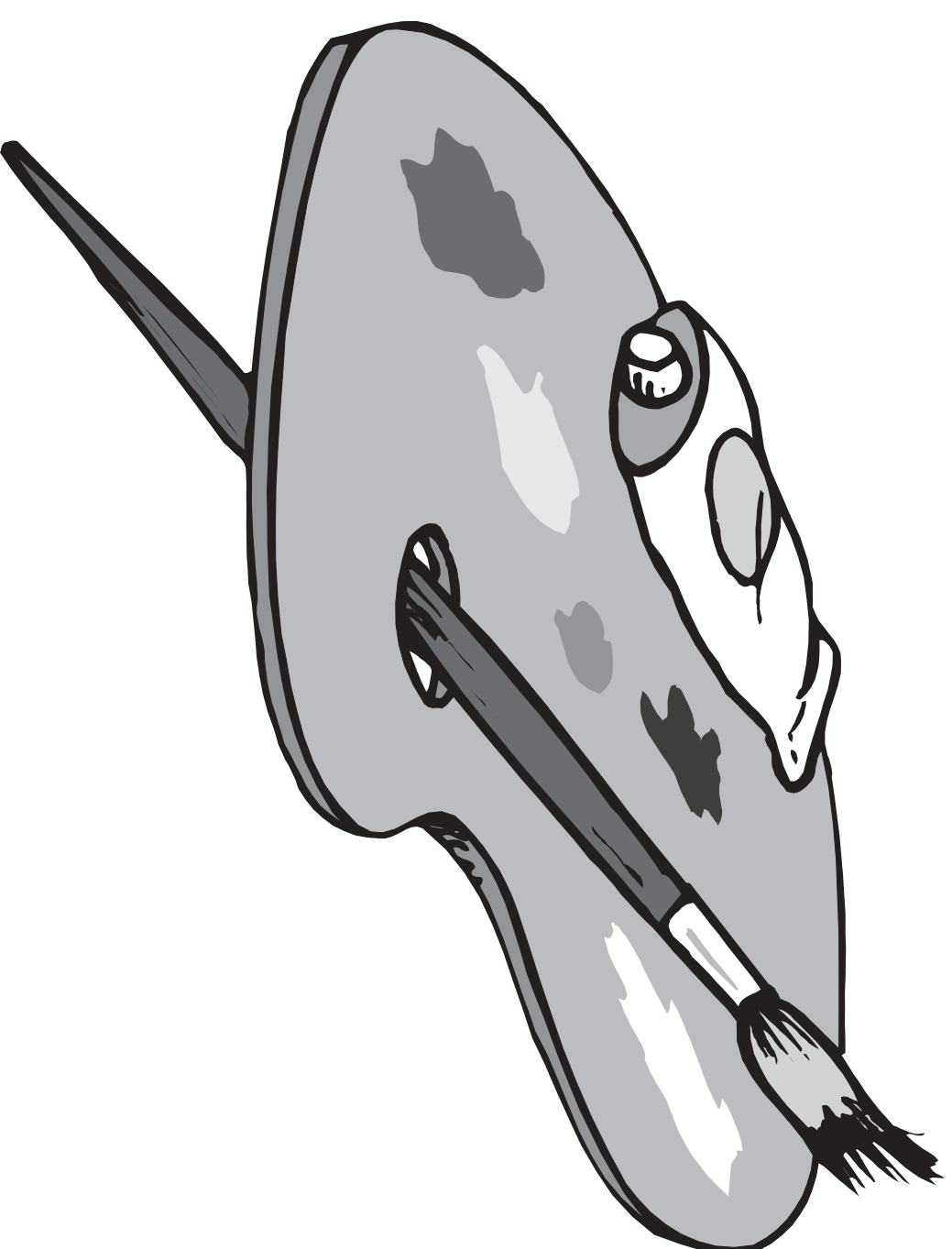

The elevation and pictorial view of a bicycle computer are given.

Draw:

- (a) the plan projected from the elevation;
- (b) the end elevation.

Show hidden detail.

DA 6

DA 6

Total (DA 12)

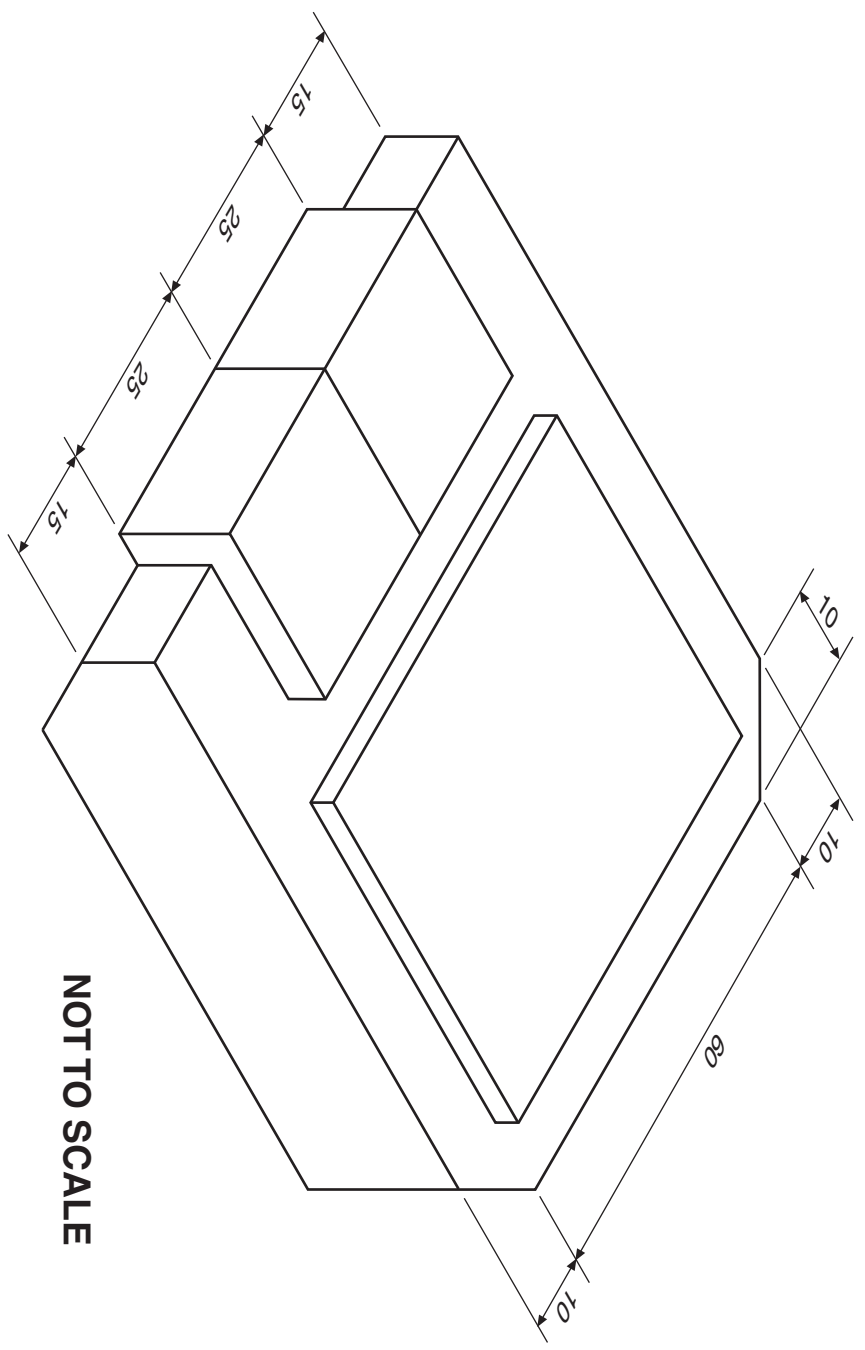

PLAN

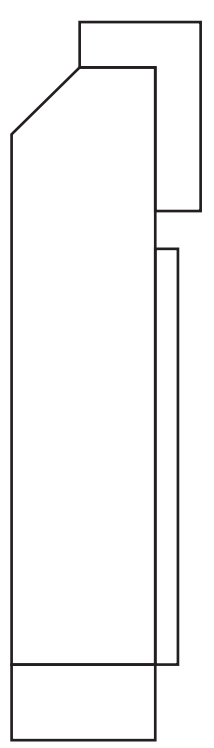

END ELEVATION

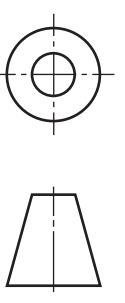

ELEVATION

a	
b	
c	
d	
e	
f	
g	
h	
i	
j	
k	
l	
m	
n	

VP1
+

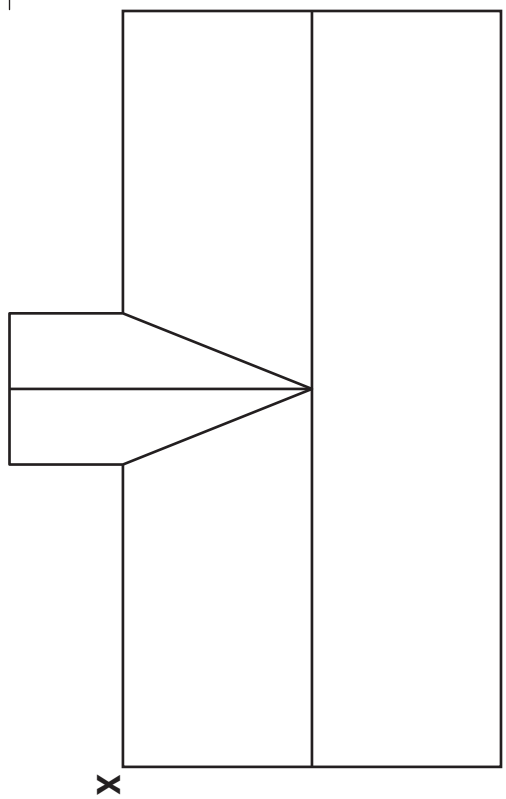

PLAN

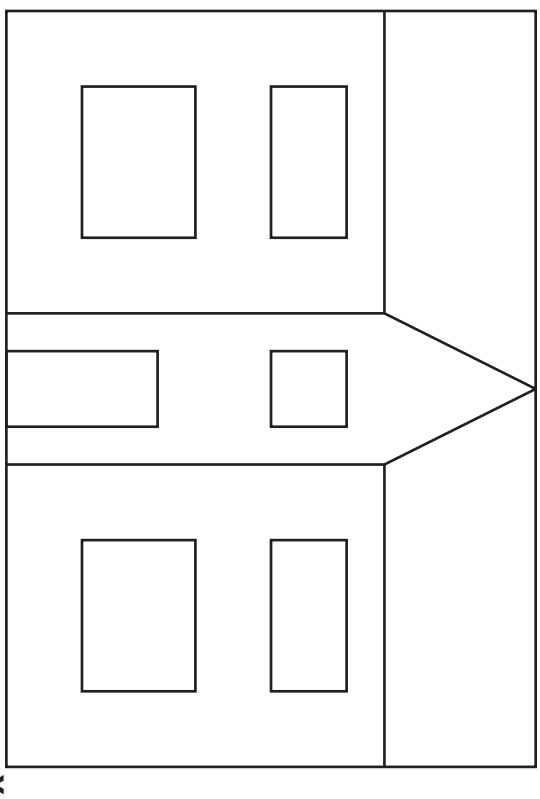

[1330/402]

ELEVATION

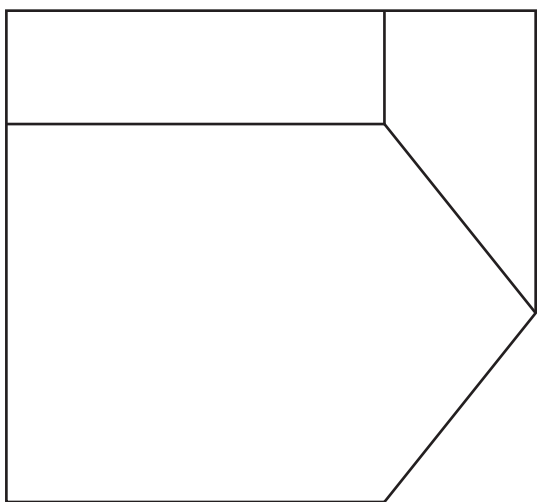

END ELEVATION

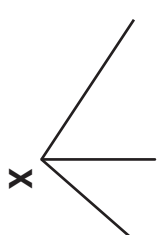

VP2
+

The elevation, end elevation and plan of a detached house are given.

Sketch in good proportion, a 2-point perspective view of the house, using points, **VP1**, **VP2** and starting point **X**.

Do not show hidden detail.

A straight edge may be used.

Total (DA 12)

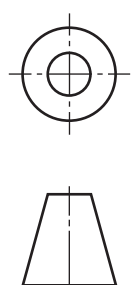

a	
b	
c	
d	
e	
f	
g	
h	
i	
j	
k	
l	
m	
n	

VP2
+

The elevation, end elevation and plan of a corner of a room are given.
A pictorial view is also shown.

Draw a planometric view of the room using the given start **X**.
Take all sizes from the given views.

Do not show hidden detail.

Total (DA14)

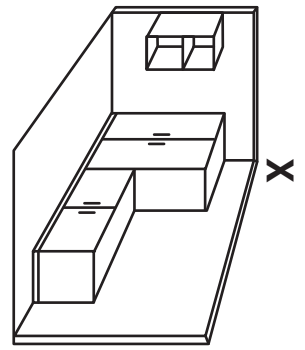

PICTORIAL VIEW

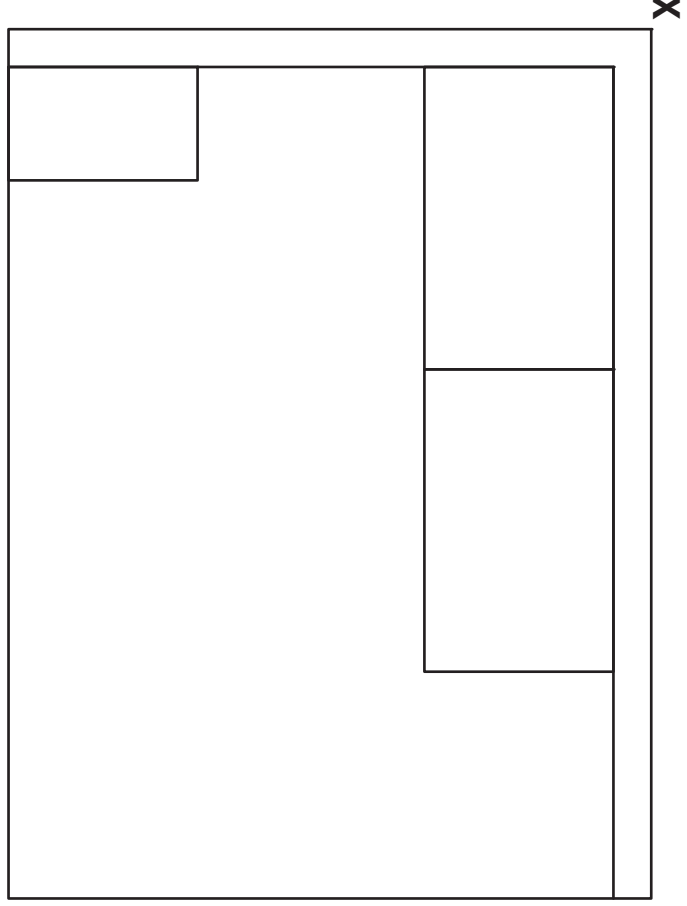
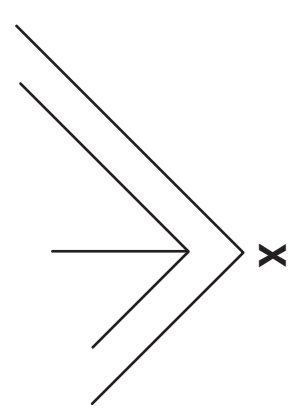

PLAN

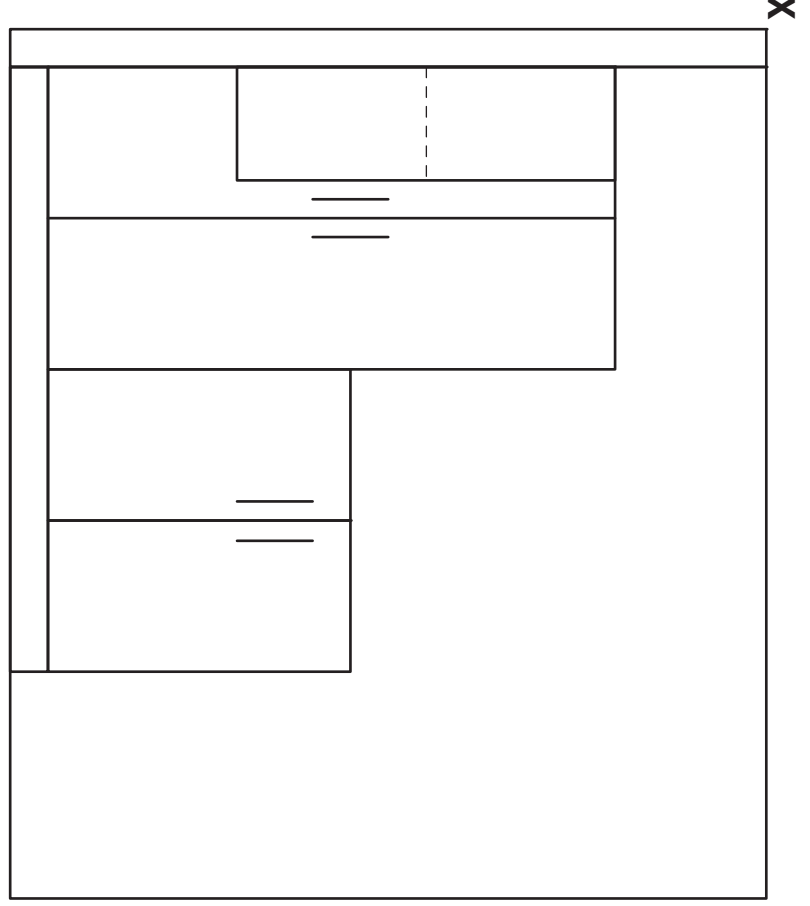

ELEVATION

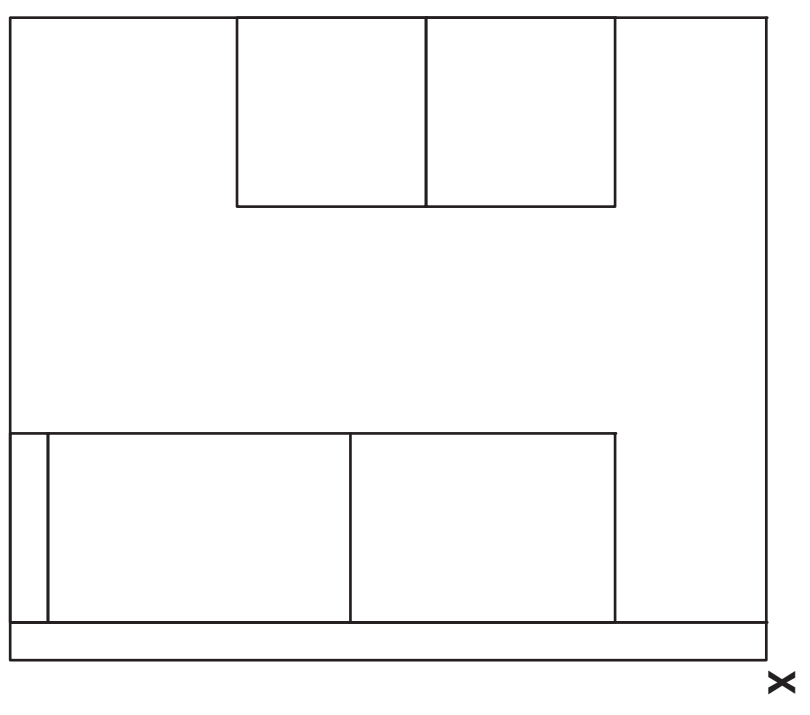

END ELEVATION

[1330/402]

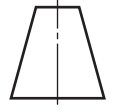
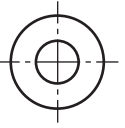

a	
b	
c	
d	
e	
f	
g	
h	
i	
j	
k	
l	
m	
n	

Candidate's Name _____

The elevation and end elevation of a pipe support are given.

Draw an oblique view, using the given start X.

Do not show hidden detail.

Lines at 45° should be drawn half full size. Total (DA 12)

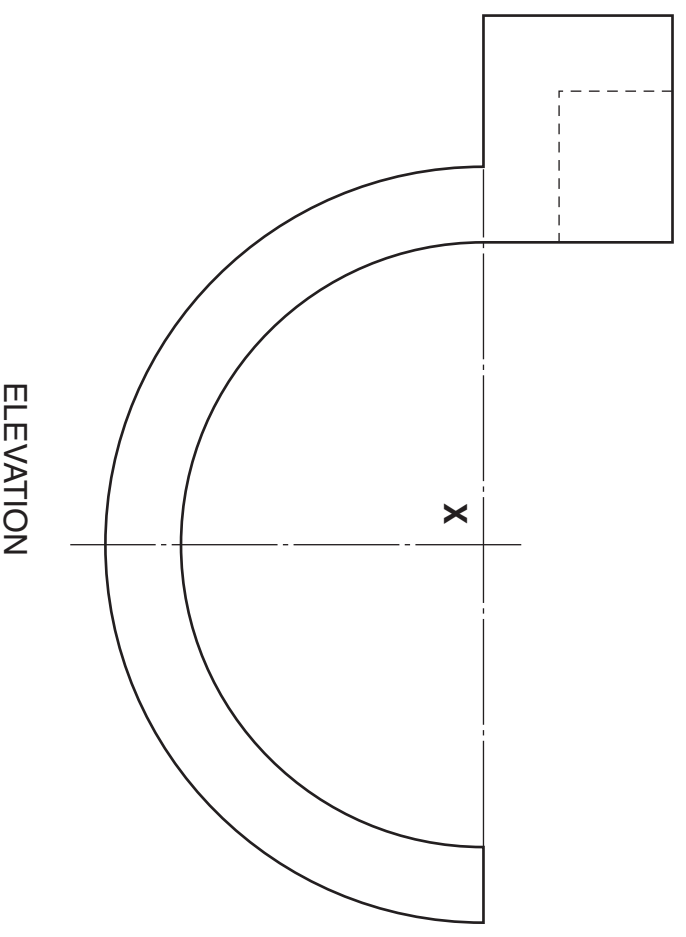

ELEVATION

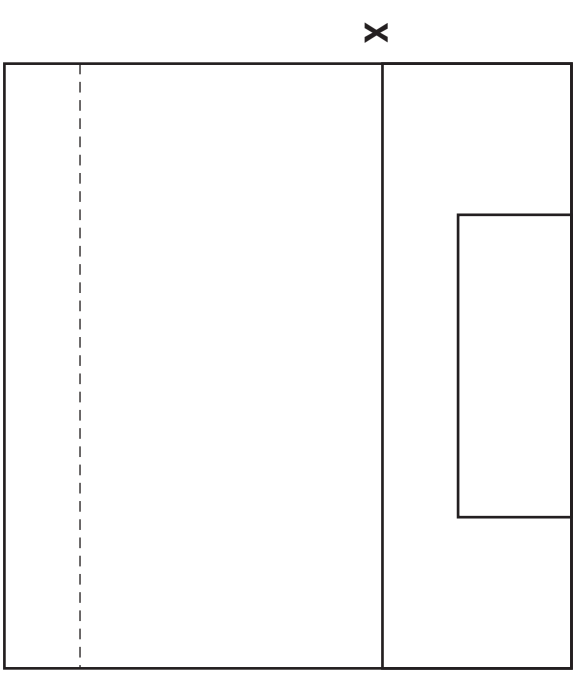

END ELEVATION

[1330/402]

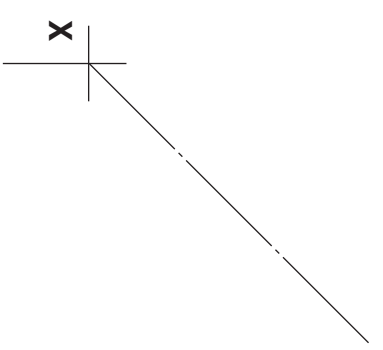
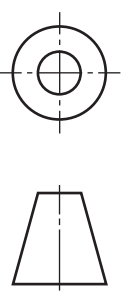

a	
b	
c	
d	
e	
f	
g	
h	
i	
j	
k	
l	
m	
n	

An incomplete plan and elevation of a “tea light” holder are given. A pictorial view of the holder is also shown.

- Draw:**
- (a) the complete plan; DA 2
 - (b) the end elevation. DA 8
- Show hidden detail. Total (DA 10)**

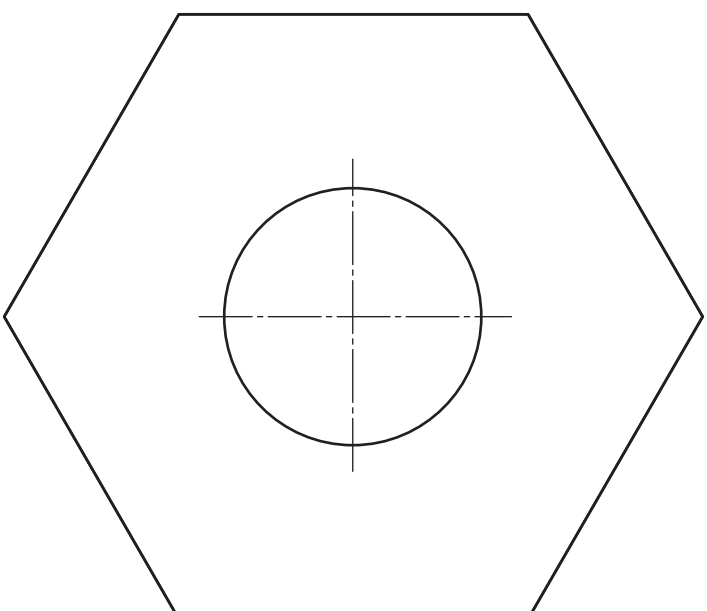

PLAN

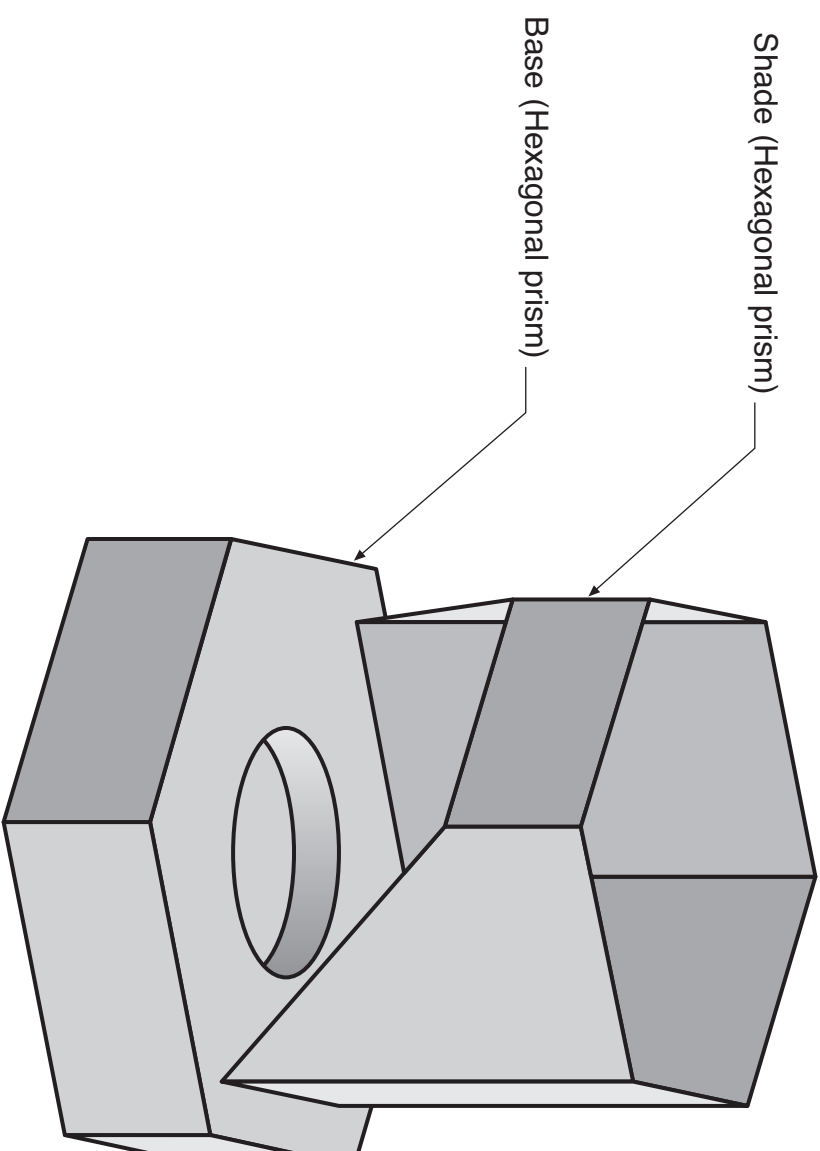

PICTORIAL VIEW

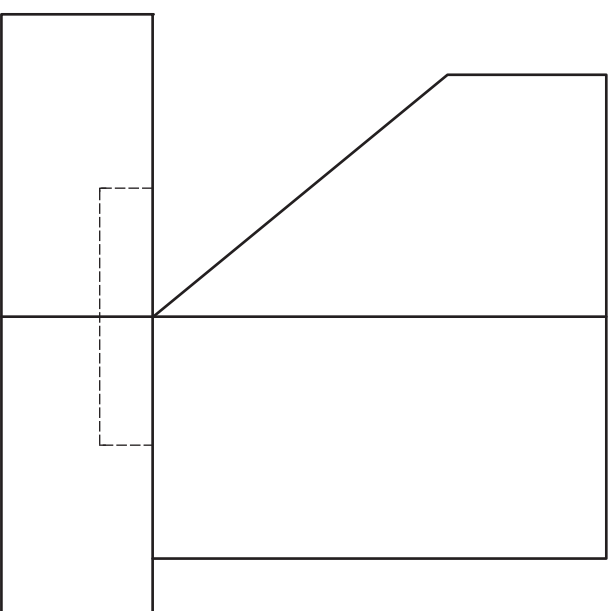

ELEVATION

END ELEVATION

a	
b	
c	
d	
e	
f	
g	
h	
i	
j	
k	
l	
m	
n	

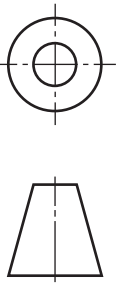

[BLANK PAGE]