

STAPLE HERE

G

FOR OFFICIAL USE

--	--	--	--	--	--

**1330/29/01**

NATIONAL TUESDAY, 15 MAY  
 QUALIFICATIONS 10.35 AM – 12.05 PM  
 2012

GRAPHIC  
 COMMUNICATION  
 STANDARD GRADE  
 General Level

Fill in these boxes and read what is printed below.

Full name of centre			Town		
<input type="text"/>			<input type="text"/>		
Forename(s)			Surname		
<input type="text"/>			<input type="text"/>		
Date of birth					
Day	Month	Year	Scottish candidate number		Number of seat
<input type="text"/>	<input type="text"/>	<input type="text"/>	<input type="text"/>	<input type="text"/>	<input type="text"/>

1 95 marks are allocated to this paper: 35 marks for Knowledge and Interpretation  
 60 marks for Drawing Abilities

- 2 Answer all questions.
- 3 Read each question carefully before you answer.
- 4 Written answers may be in **ink** or **pencil**.
- 5 Drawings and sketches **must be in pencil**.
- 6 Sketches need only be in line form—do not spend time rendering.
- 7 Dimensions are given in millimetres or as stated.
- 8 Orthographic drawings are in third angle projection.
- 9 For each question, the element being tested and the mark allocation are shown in brackets, eg (DA 5) means a question on Drawing Abilities worth 5 marks.
- 10 **At the end of the examination**
  - check that your name is on every sheet;
  - put the sheets in correct numerical order;
  - place this sheet on top of the others;
  - join all sheets together by **stapling** at the top left-hand corner;
  - before leaving the examination room, you must give these sheets to the Invigilator (if you do not you may lose all the marks for this paper).

	KI	DA
1		
2		
3		
4		
5		
6		
7		
8		
9		
Total Marks		



**[BLANK PAGE]**

The building industry uses plans and symbols to communicate information.

(a) State the name of the plan types shown at **A**, **B** and **C**.

**Plan A** .....

**Plan B** .....

**Plan C** .....

KI 3

(b) State the name of the BSi symbols **D**, **E**, **F**, **G**, **H** and **I**.

**D** .....

**E** .....

**F** .....

**G** .....

**H** .....

**I** .....

KI 6

(c) (i) State which of the following scales would be suitable for **Plan B**.

- 1:10    1:50    1:200    1:1250

**Scale** .....

(ii) Identify the symbol **X** shown on **Plan B**.

Symbol **X** .....

KI 2

Total (KI 11)

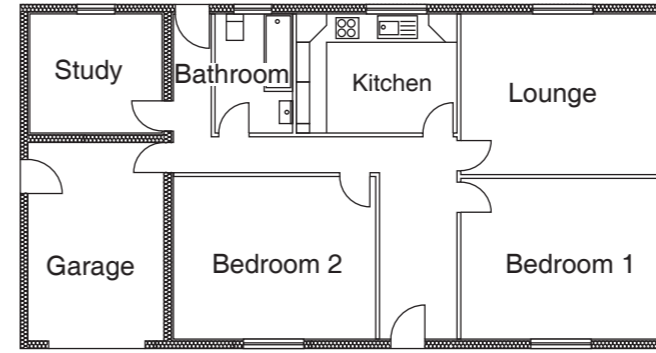

Plan A

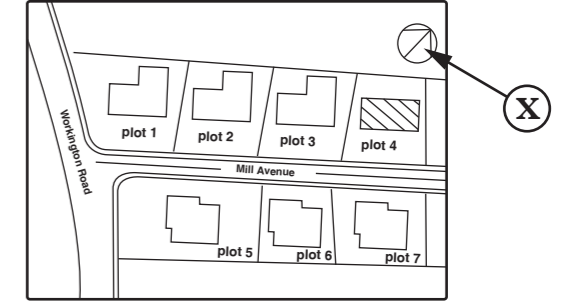

Plan B

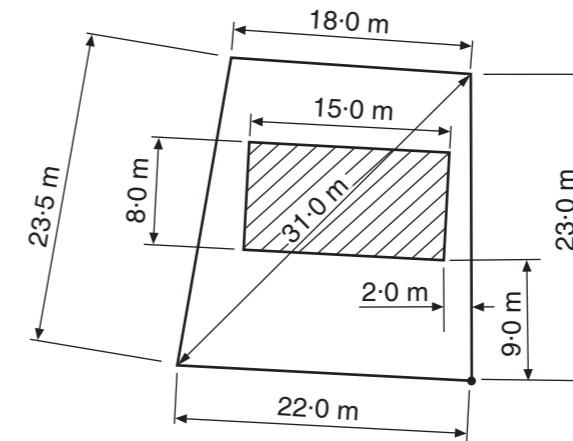

Plan C

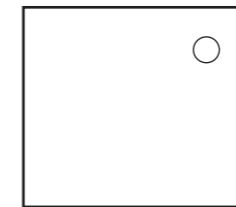

D

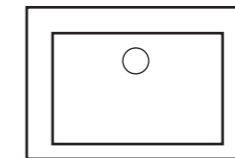

E

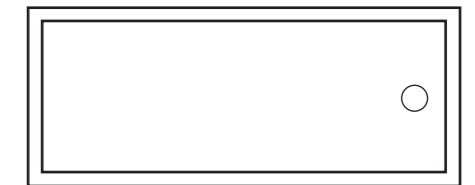

F

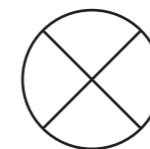

G



H



I

Knowledge of colour theory can be very useful to an interior designer as colours can be associated with different moods or situations.

(a) State which colour would represent:

(i) something that is happy;

**Colour** .....

(ii) something that is reliable;

**Colour** .....

(iii) something that is safe for the environment;

**Colour** .....

(iv) something that is dangerous.

**Colour** ..... **KI 4**

(b) State a tertiary colour that contains red and is in contrast with yellow.

**Answer** ..... **KI 1**

(c) State a tertiary colour that contains blue and is in harmony with green.

**Answer** ..... **KI 1**

(d) State **two** tertiary colours that contain orange.

**Colour** ..... **Colour** ..... **KI 2**

(e) State what must be added to a primary colour in order to obtain a tertiary colour.

**Answer** ..... **KI 1**

**Total (KI 9)**

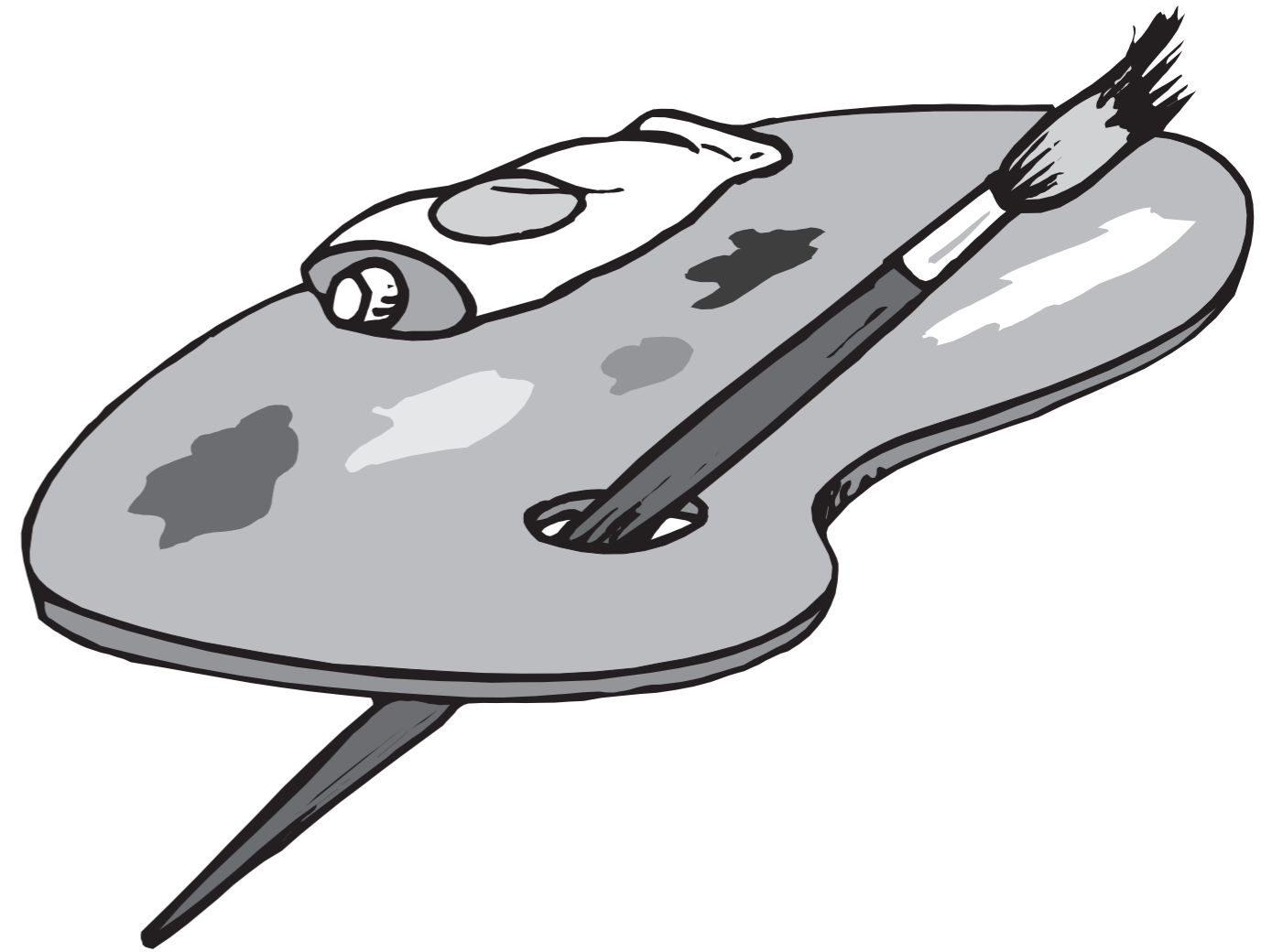

The following drawings show the results of applying 9 CAD commands.  
State the **single** CAD command used in each case.

1

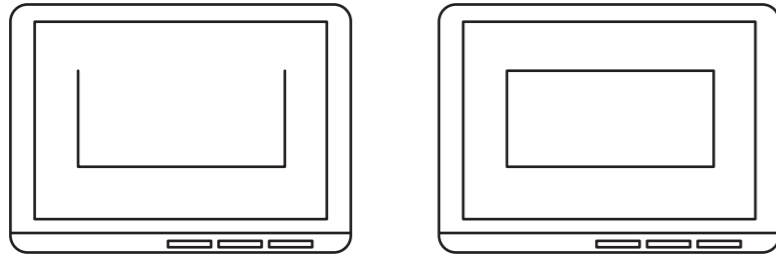

COMMAND

2

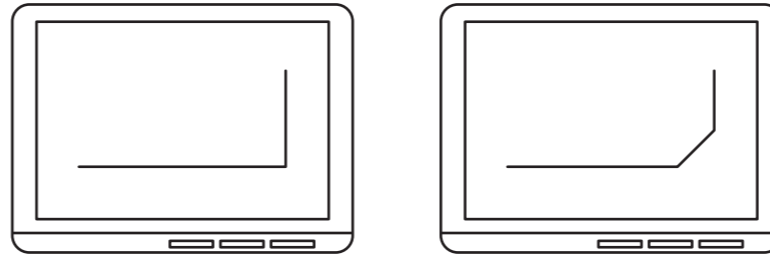

COMMAND

3

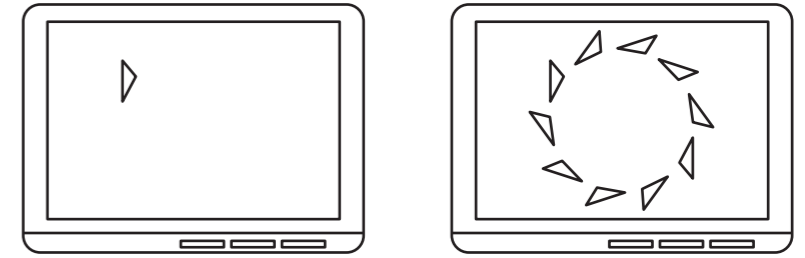

COMMAND

4

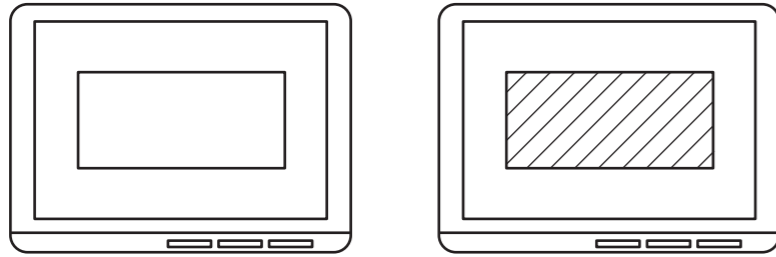

COMMAND

5

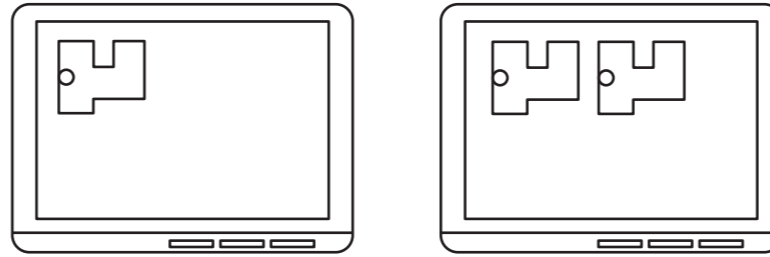

COMMAND

6

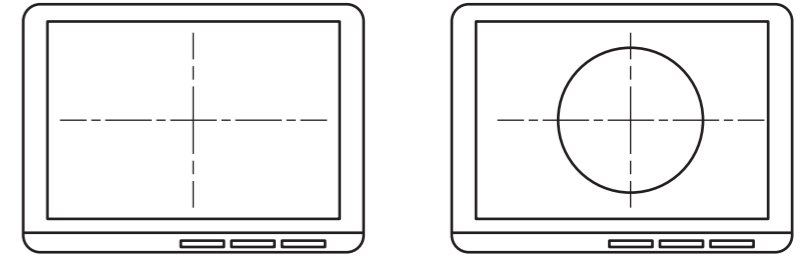

COMMAND

7

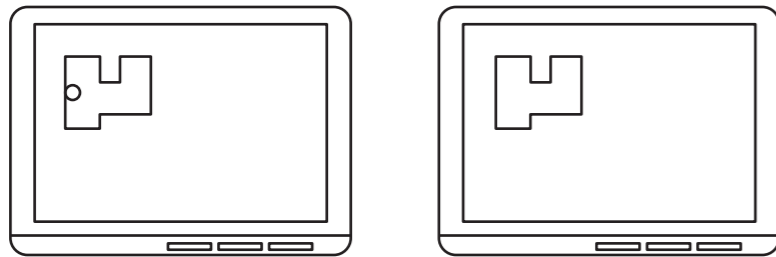

COMMAND

8

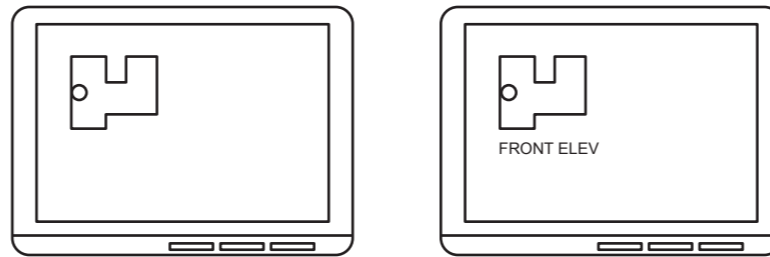

COMMAND

9

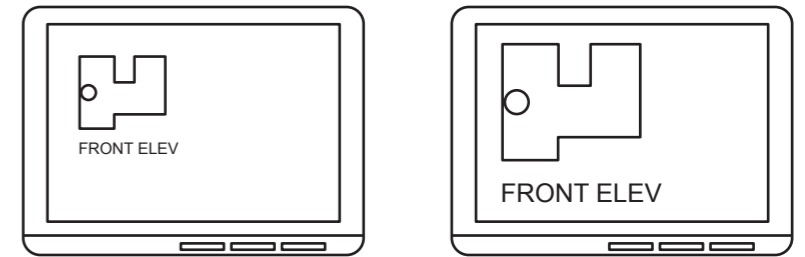

COMMAND

Total (KI 9)

Study the views shown opposite and answer the following questions.

(a) State the names of the types of view shown at **A**, **B** and **C**.

**View A** .....

**View B** .....

**View C** .....

**KI 3**

(b) State the name of **one** other view in which you would see all three dimensions.

**Answer** ..... **KI 1**

(c) State the **Angle X** on **View A**.

**Angle** ..... **KI 1**

(d) State the general name given to the types of view shown at **A**, **B** and **C**.

**Answer** ..... **KI 1**

**Total (KI 6)**

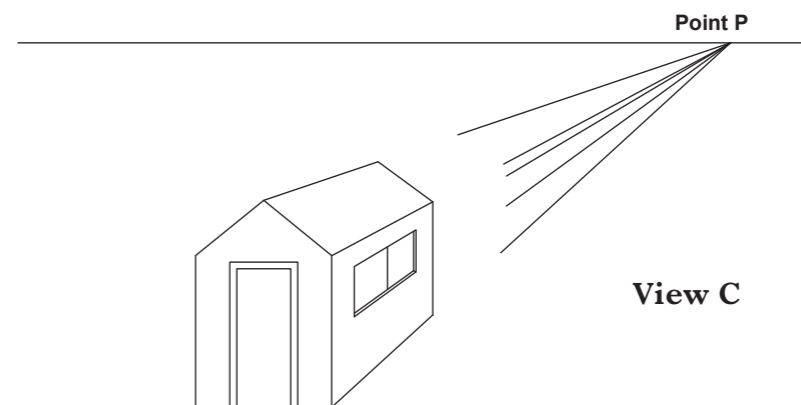
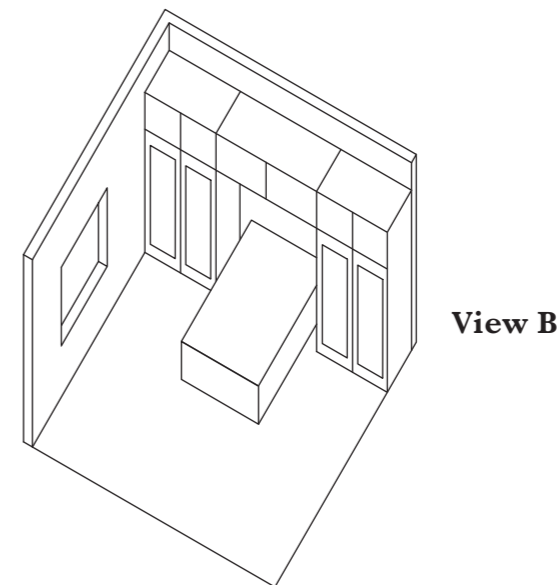
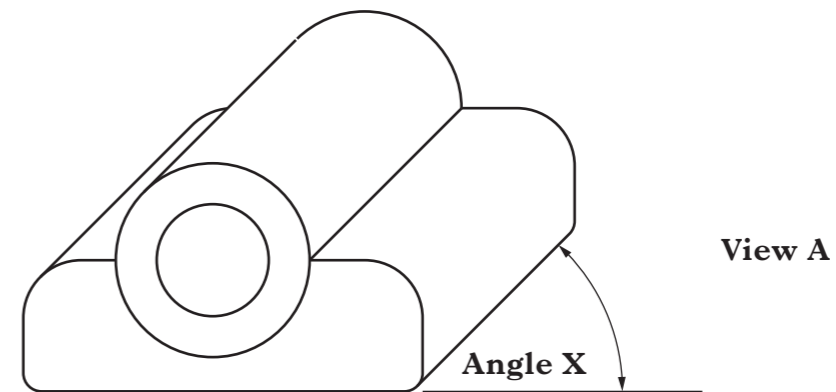

5

The pictorial view of one part of a drawing board swivel bracket is shown. The elevation and plan are also given.

Draw the end elevation.

Show hidden detail.

Total (DA 10)

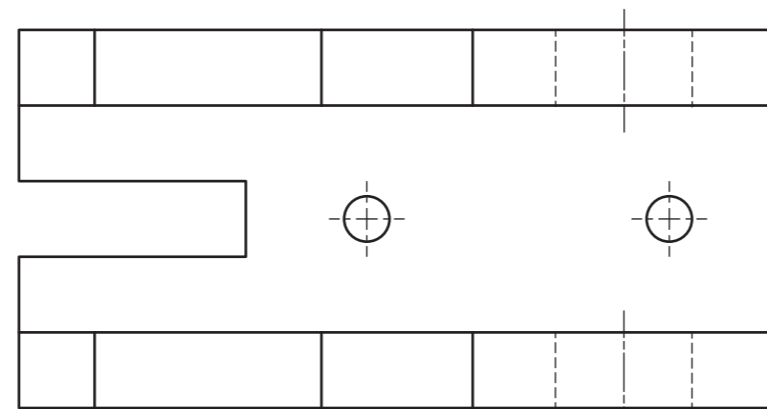

PLAN

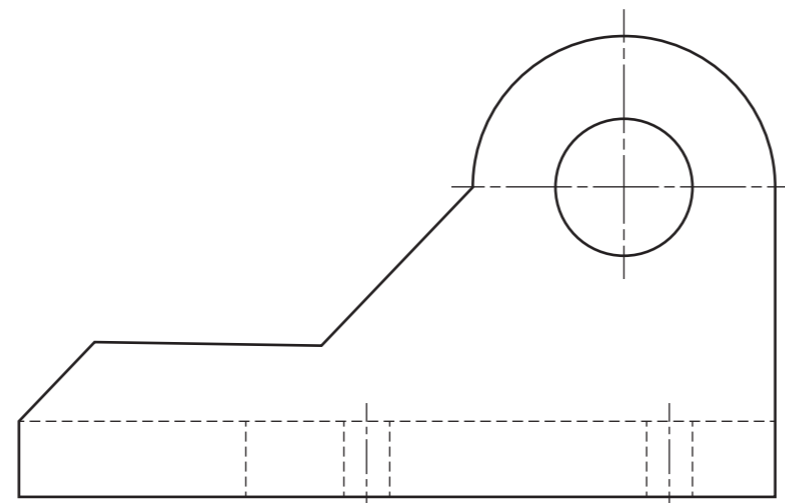

ELEVATION

END ELEVATION

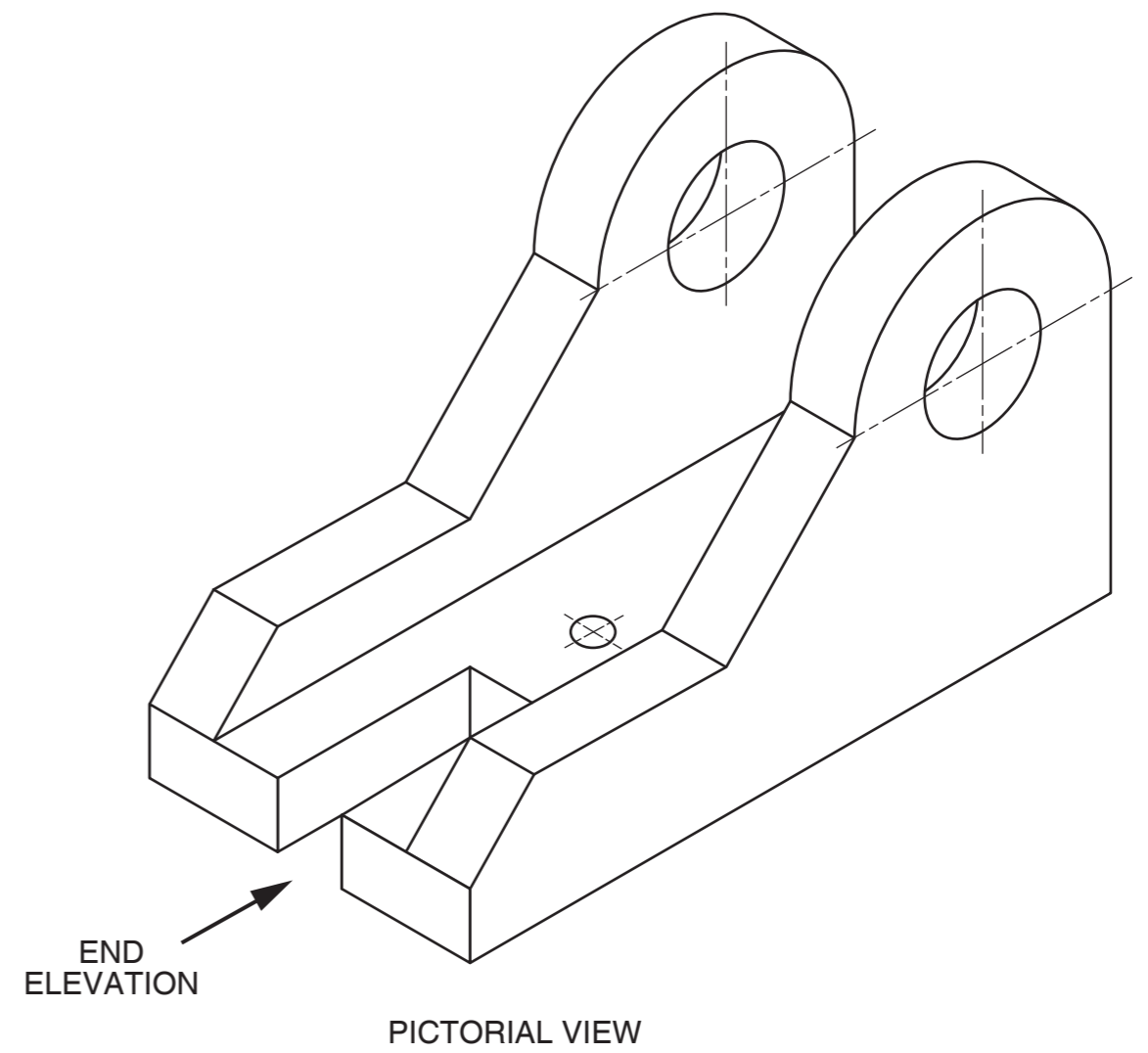

5

<i>a</i>	
<i>b</i>	
<i>c</i>	
<i>d</i>	
<i>e</i>	
<i>f</i>	
<i>g</i>	
<i>h</i>	
<i>i</i>	
<i>j</i>	
<i>k</i>	
<i>l</i>	
<i>m</i>	
<i>n</i>	

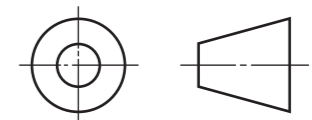

Candidate's Name \_\_\_\_\_

The elevation and end elevation of a digital camera are given.

Draw an **oblique view** of the camera, using the given start **X**.

Do not show hidden detail.

Lines at 45° should be drawn half full size.

Total (DA 13)

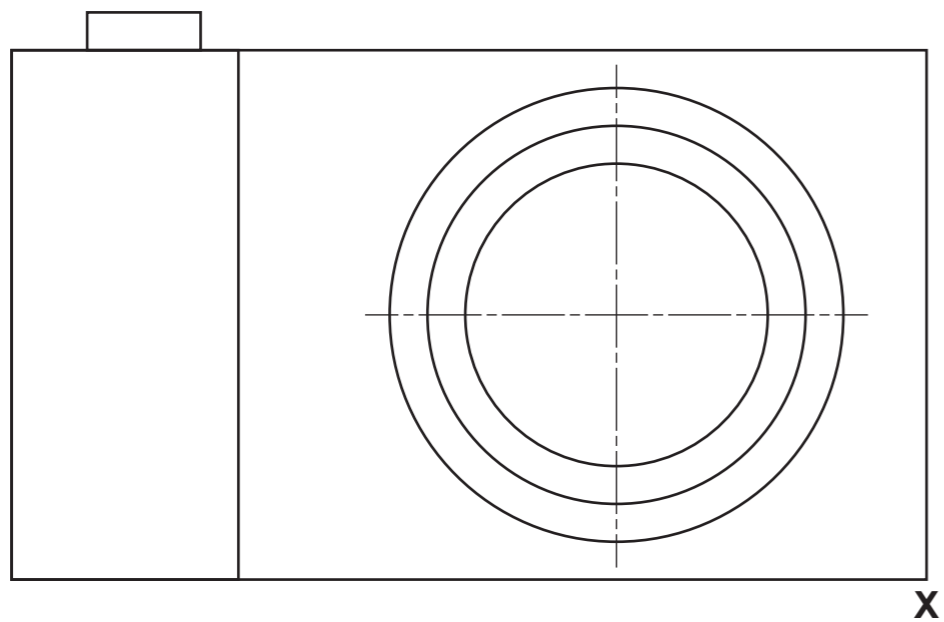

ELEVATION

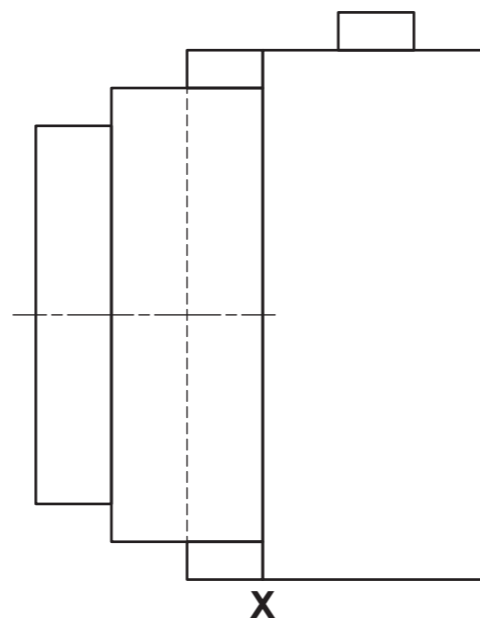

END ELEVATION

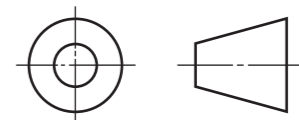

<i>a</i>	
<i>b</i>	
<i>c</i>	
<i>d</i>	
<i>e</i>	
<i>f</i>	
<i>g</i>	
<i>h</i>	
<i>i</i>	
<i>j</i>	
<i>k</i>	
<i>l</i>	
<i>m</i>	
<i>n</i>	



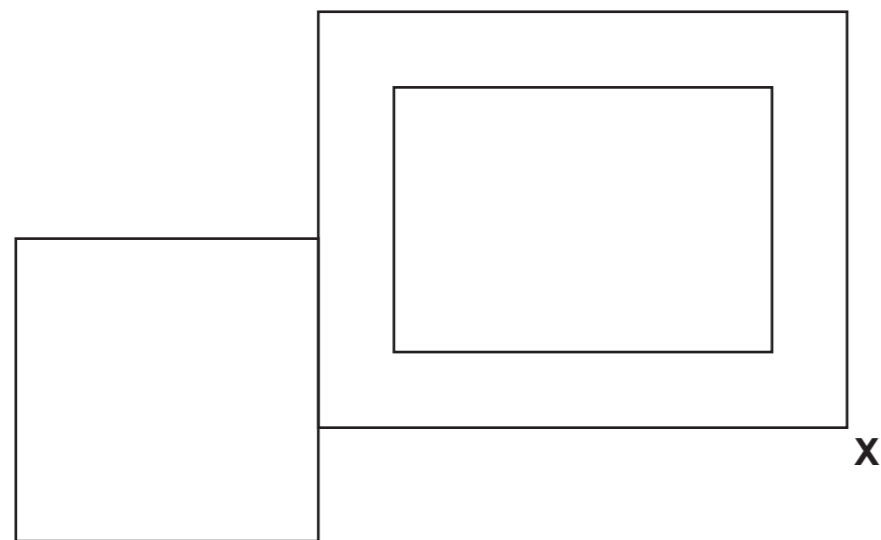

PLAN

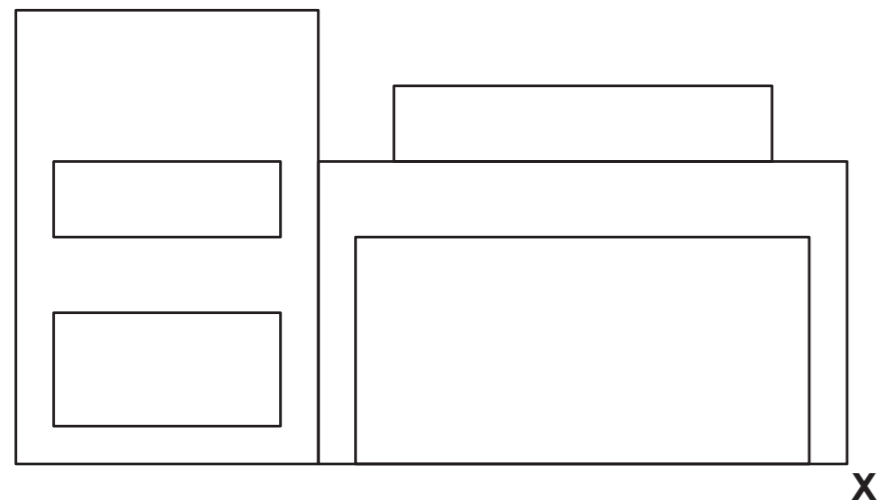

ELEVATION

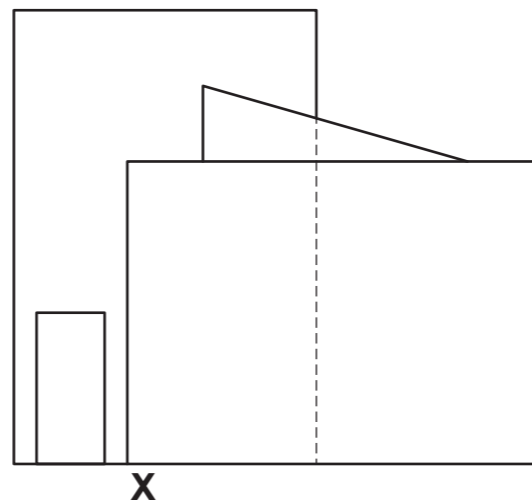

END ELEVATION



The elevation, end elevation and plan of a tyre depot are given. **Sketch**, in good proportion, a 2-point perspective view of the depot building, using vanishing points **VP1**, **VP2** and starting point **X**.

**Do not show hidden detail.**

**A straight edge may be used.**

**Total (DA 12)**

<i>a</i>	
<i>b</i>	
<i>c</i>	
<i>d</i>	
<i>e</i>	
<i>f</i>	
<i>g</i>	
<i>h</i>	
<i>i</i>	
<i>j</i>	
<i>k</i>	
<i>l</i>	
<i>m</i>	
<i>n</i>	

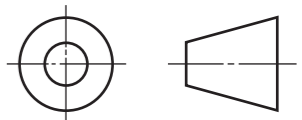

The plan and end elevation of a perfume bottle and label are given. A pictorial view of the bottle and label are also shown. The label wraps around all six sides of the bottle.

**Draw:**

(a) the elevation of the bottle with label; **Do not shade the label.** DA 6

(b) the development of the label, using the given start **X**. DA 7

**Show hidden detail.**

**Total (DA 13)**

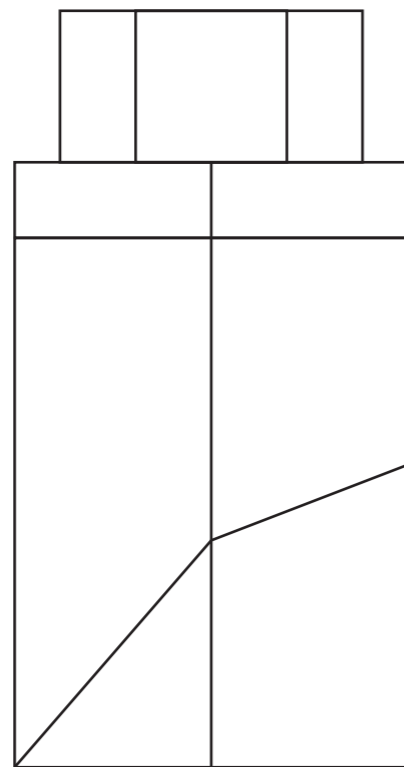
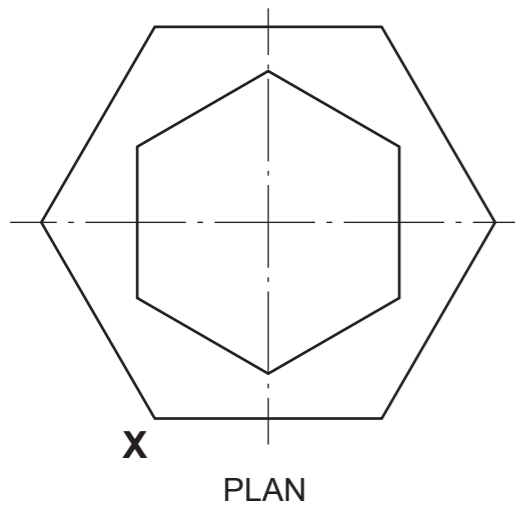

ELEVATION

END ELEVATION

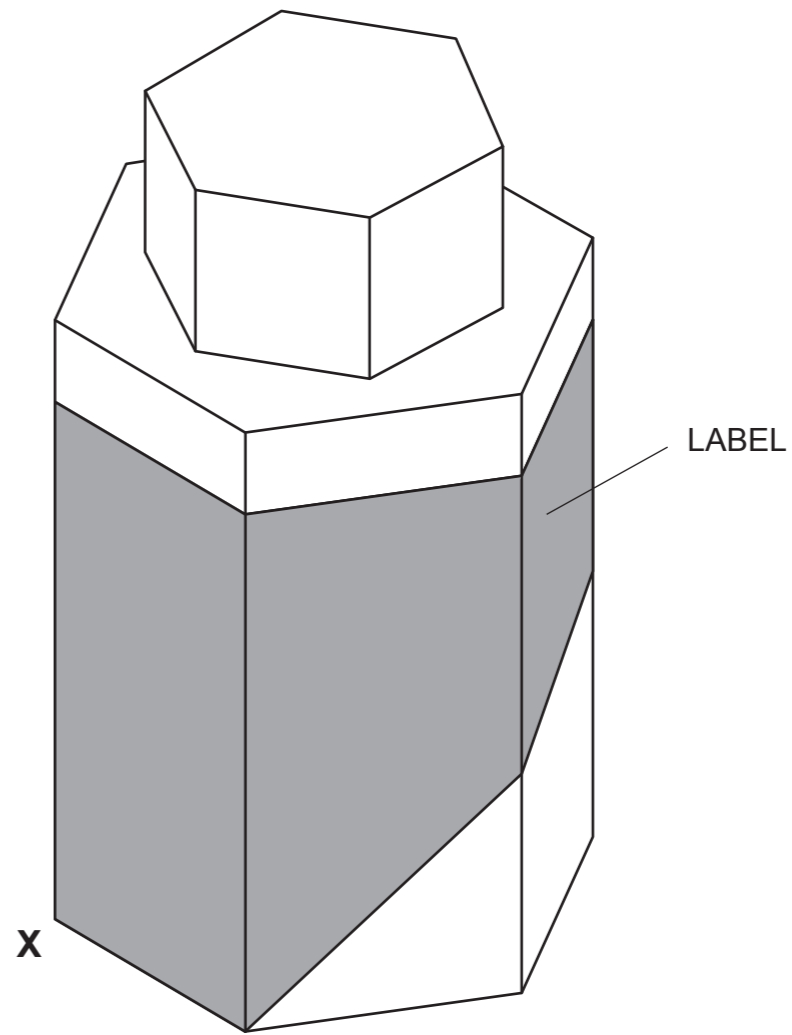
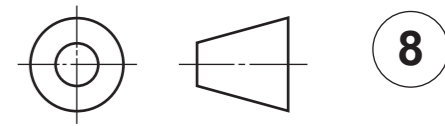

PICTORIAL VIEW

<i>a</i>	
<i>b</i>	
<i>c</i>	
<i>d</i>	
<i>e</i>	
<i>f</i>	
<i>g</i>	
<i>h</i>	
<i>i</i>	
<i>j</i>	
<i>k</i>	
<i>l</i>	
<i>m</i>	
<i>n</i>	

DEVELOPMENT OF LABEL

Candidate's Name \_\_\_\_\_

The elevation of a golf tee marker in the form of a rectangular based pyramid is given. A pictorial view is also shown.

**Draw:**

- (a) the plan of the tee marker projected from the elevation;
- (b) the end elevation;
- (c) the true shape of the marker name plate.

**DA 6**

**DA 4**

**DA 2**

**Total (DA 12)**

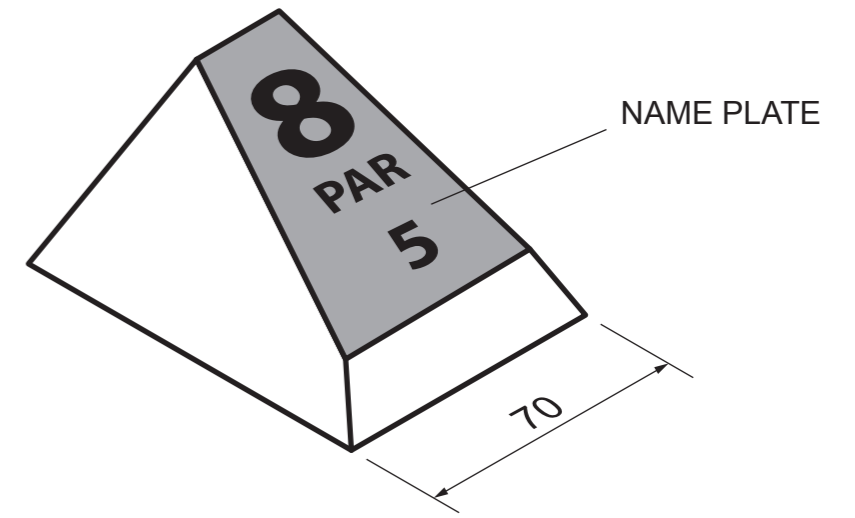
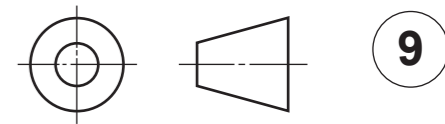

PICTORIAL VIEW  
(NOT TO SCALE)



PLAN

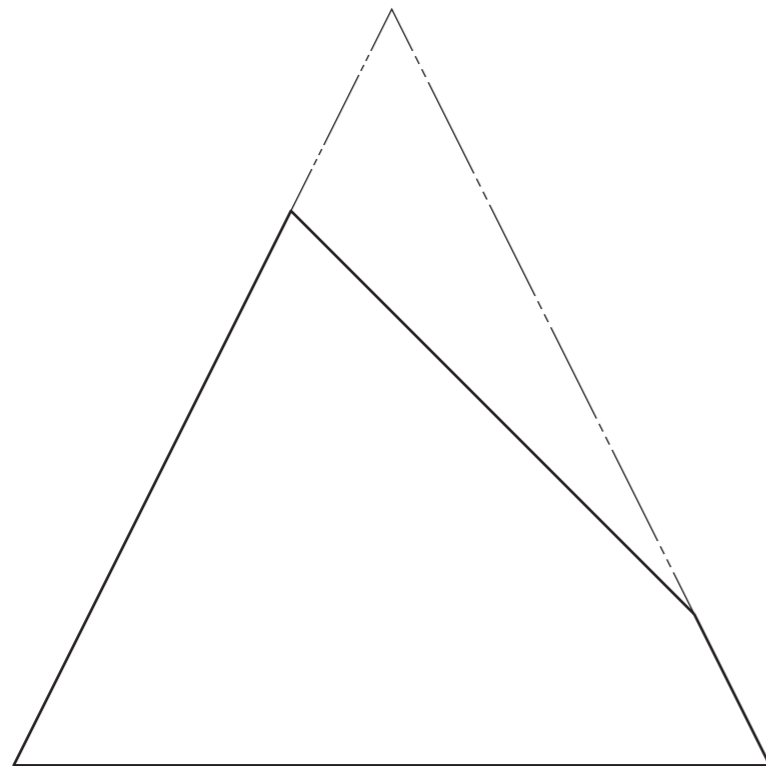

ELEVATION

TRUE SHAPE

END ELEVATION

[END OF QUESTION PAPER]

<i>a</i>	
<i>b</i>	
<i>c</i>	
<i>d</i>	
<i>e</i>	
<i>f</i>	
<i>g</i>	
<i>h</i>	
<i>i</i>	
<i>j</i>	
<i>k</i>	
<i>l</i>	
<i>m</i>	
<i>n</i>	

Candidate's Name \_\_\_\_\_

**[BLANK PAGE]**