

STAPLE HERE

FOR OFFICIAL USE

--	--	--	--	--	--	--

X033/201

NATIONAL QUALIFICATIONS 2010
THURSDAY, 27 MAY
1.00 PM – 3.30 PM

GRAPHIC COMMUNICATION
INTERMEDIATE 2

Fill in these boxes and read what is printed below.

Full name of centre				Town	
Forename(s)				Surname	
Date of birth	Day	Month	Year	Scottish candidate number	Number of seat
	<input type="text"/>	<input type="text"/>	<input type="text"/>	<input type="text"/>	<input type="text"/>

70 marks are allocated to this paper

- 1 Answer all questions.
- 2 Read each question carefully before you answer.
- 3 Written answers may be in ink or pencil.
- 4 Drawings and sketches must be in pencil.
- 5 Dimensions are given in millimetres or as stated.
- 6 Orthographic drawings are in third angle projection.

At the end of the examination

check that your name is on every sheet;
put the sheets in correct numerical order;
place this sheet on top of the others;
join all sheets together by stapling at the top left-hand corner;
before leaving the examination room, you must give these sheets to the Invigilator
(if you do not you may lose all the marks for this paper).

Question	Marks
1	
2	
3	
4	
5	
6	
7	
8	
9	
Total Marks	



[BLANK PAGE]

1

The elevation and end elevation of a round pin are shown below.

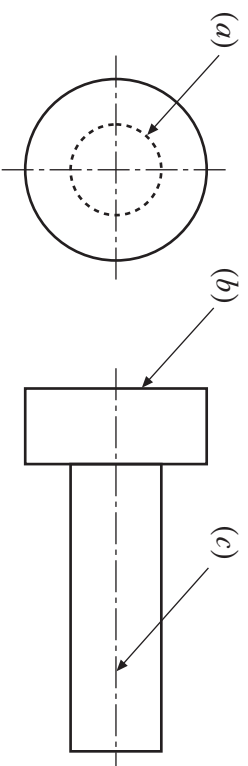

Elevation

End Elevation

Identify, according to British Standards, the three line types shown.

(a)

(b)

(c)

(3 marks)

3

Identify the architectural symbols shown below.



(a)



(b)

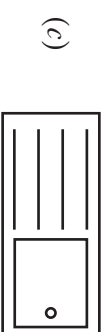

(c)



(d)

(4 marks)

2

keyboard • monitor • hard drive • plotter • scanner

Using the list shown above, select,

(a) a storage device

(b) an input device

(c) an output device

(3 marks)

4

A clothing firm has produced a new line in Health and Safety work wear.

- (a) Yellow was chosen for the manufacture of safety vests. State the reason for this.
.....
- (b) What would be added to yellow to make a yellow **hint**?
.....
- (c) State a **secondary** receding colour that would make the vest stand out in a display.
.....
- (d) State how you would produce a **secondary** colour.
.....
- (e) State a tertiary colour that would **harmonise** with yellow.
.....

(5 marks)

5

Stages in the production of a CAD drawing of a mobile phone are shown below.

Identify the **single** command used to produce each stage.

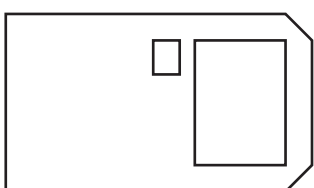
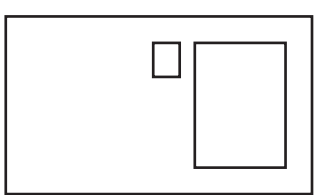

(a)

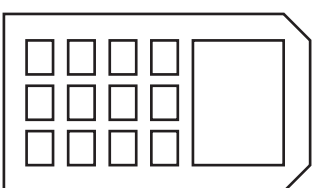
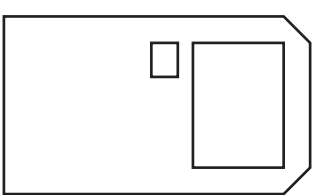

(b)

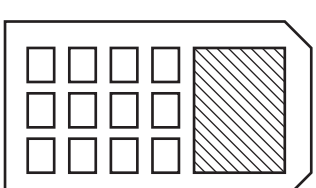
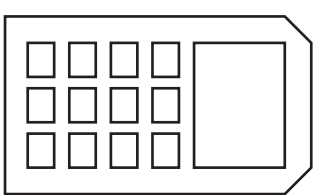

(c)

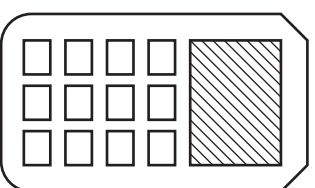
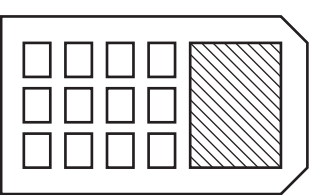

(d)

(4 marks)

The elevation and end elevation of a name card holder are given.

Draw, full size, the plan.

Show all hidden detail.

(10 marks)

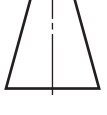
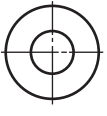

<i>a</i>	
<i>b</i>	
<i>c</i>	
<i>d</i>	
<i>e</i>	
<i>f</i>	
<i>g</i>	
<i>h</i>	
<i>i</i>	
<i>j</i>	
<i>k</i>	
<i>l</i>	
<i>m</i>	
<i>n</i>	

Plan

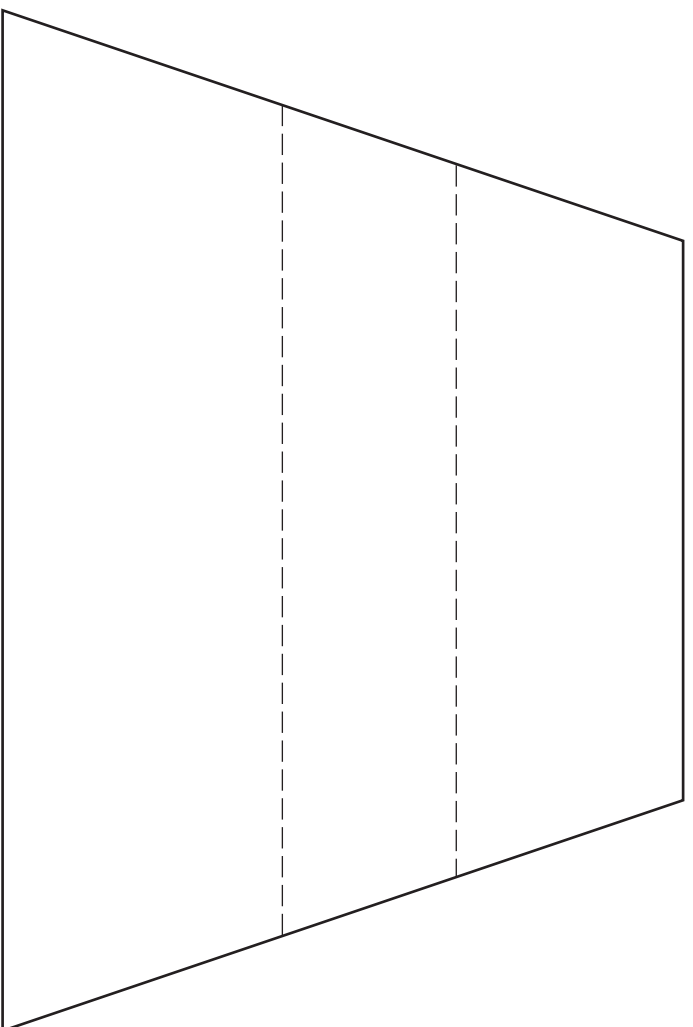

Elevation

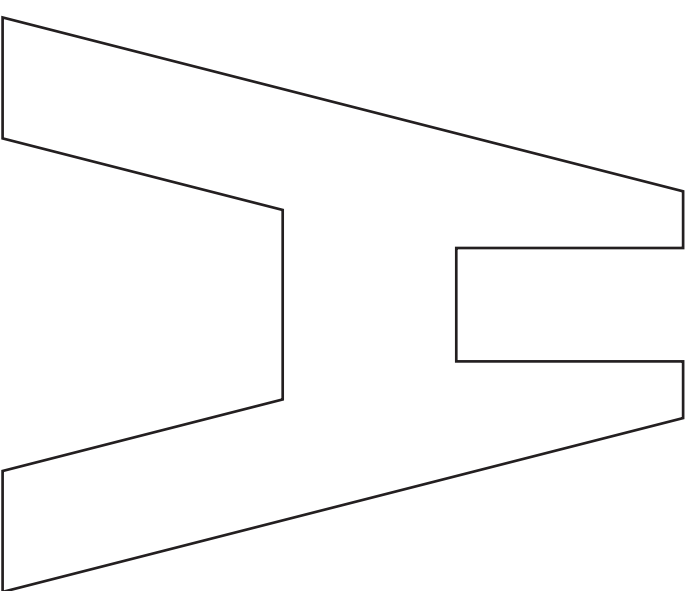

End Elevation

The plan and end elevation of a litter bin on a stand are given.

Draw, full size:

- (a) the elevation;
- (b) the true shape of the sloping surface;
- (c) the development of the curved surface of the bin excluding the stand, open along the seam **A-A**.

Show all hidden detail (15 marks)

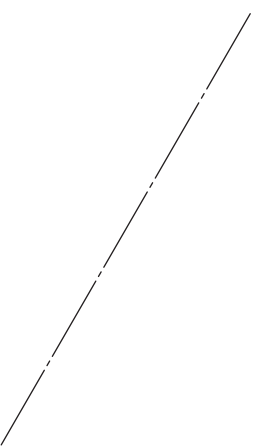
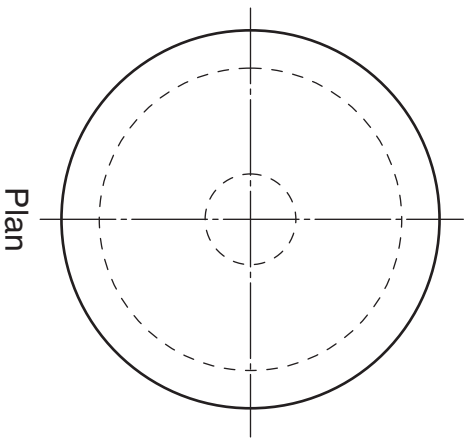

True Shape

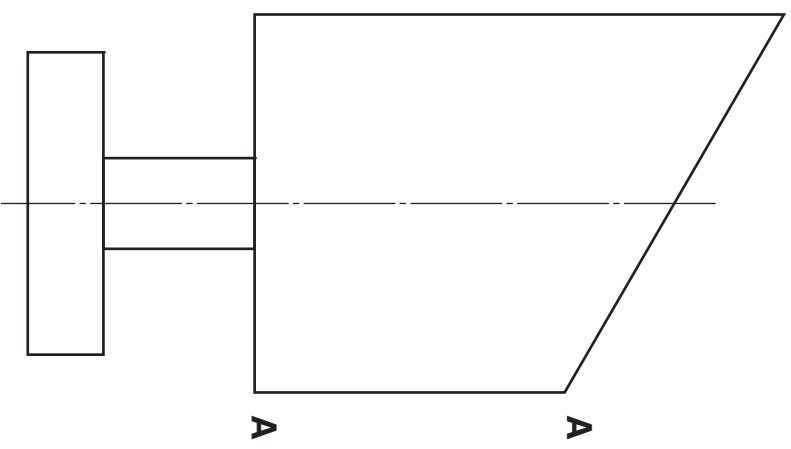

Elevation

End Elevation



Development



a	
b	
c	
d	
e	
f	
g	
h	
i	
j	
k	
l	
m	
n	

The elevation and plan of a kitchen are given.

Draw, in the position indicated, the planometric view of the kitchen.

Show all door and drawer handles.

Do not show hidden detail.

(14 marks)

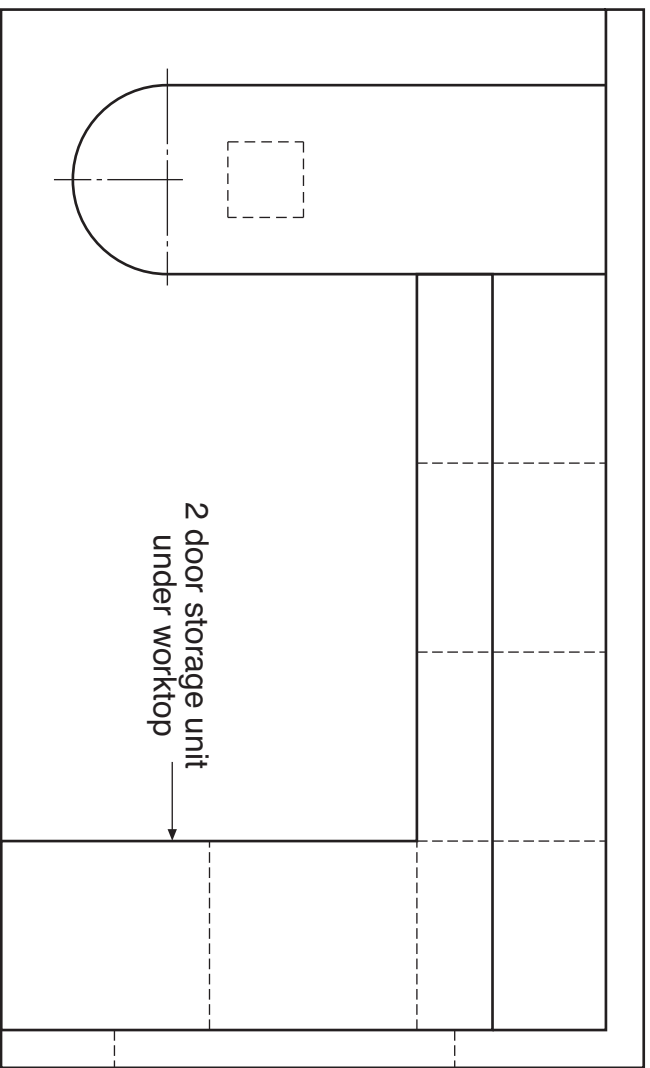

X
Plan

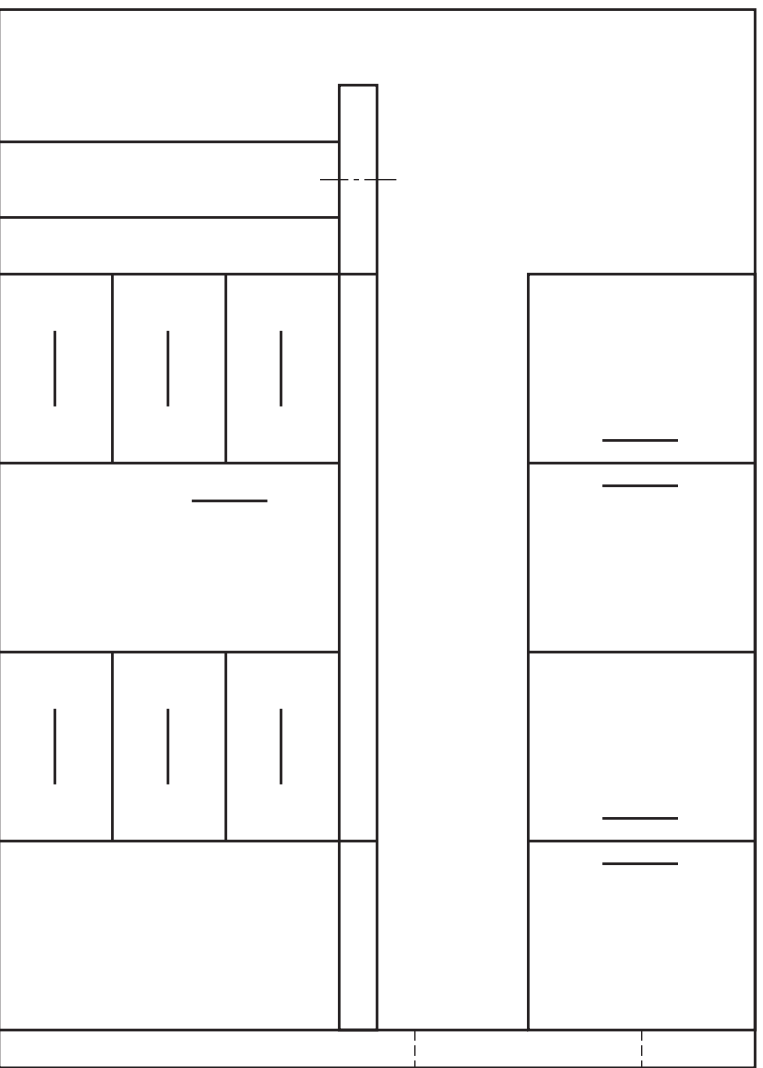

X
Elevation

[X033/2011]

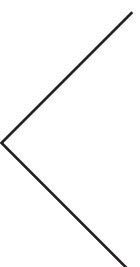
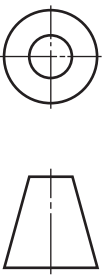

Planometric View

Candidate's Name _____

a	
b	
c	
d	
e	
f	
g	
h	
i	
j	
k	
l	
m	
n	

The elevation and plan of the parts that make up a rubber ink stamp are given. A pictorial view is shown opposite.

Draw **full size** to the given dimensions:

(a) the fully assembled plan;

Show all hidden detail.

(b) the sectional elevation on **A-A** of the assembly.

Do not show hidden detail.

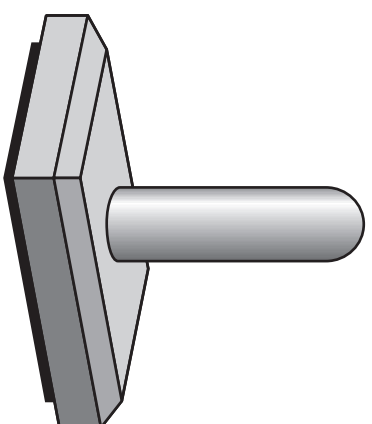

(12 marks)

Handle

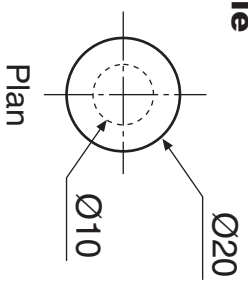

Base

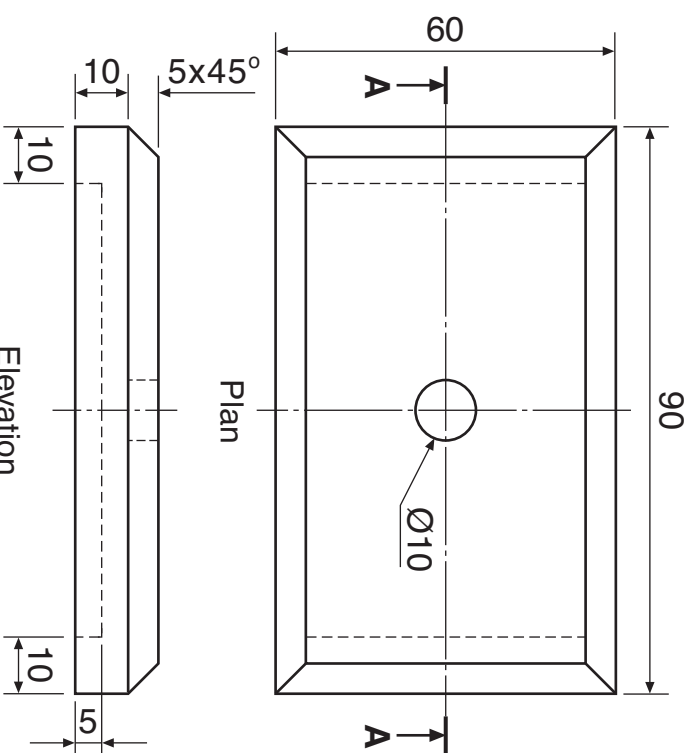

Stamp

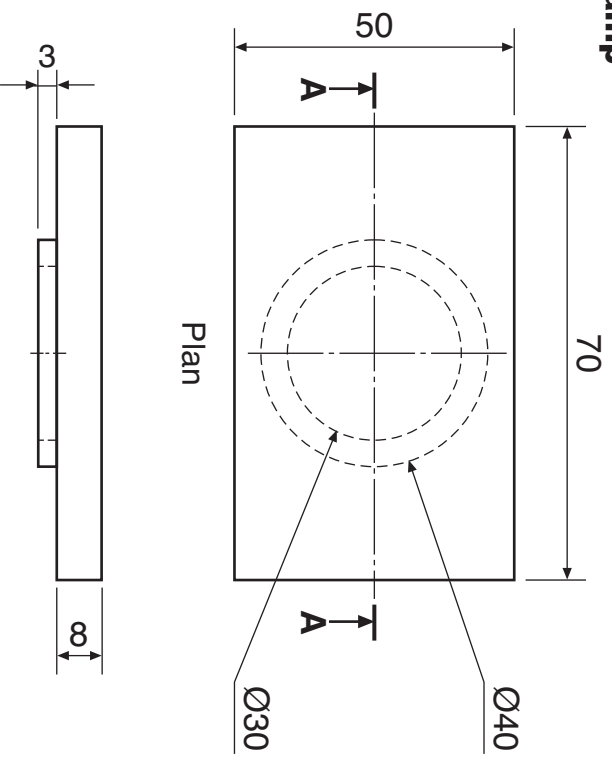

a	
b	
c	
d	
e	
f	
g	
h	
i	
j	
k	
l	
m	
n	

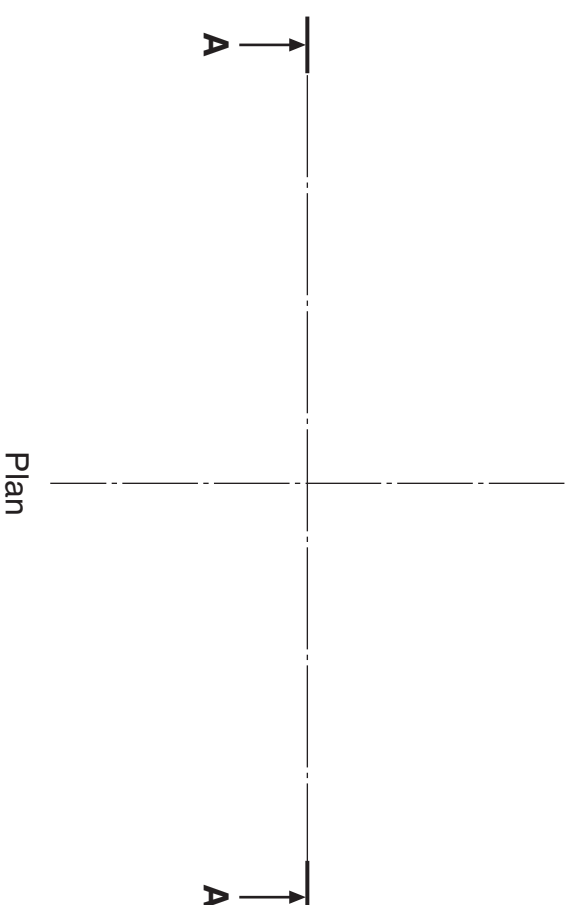

Sectional Elevation A-A

Elevation