

**JUNIOR LYCEUM ANNUAL EXAMINATIONS 2004**  
Educational Assessment Unit - Education Division

**FORM 1**

**TEXTILES STUDIES**

**TIME: 1hr 30mins**

Name: \_\_\_\_\_

Class: \_\_\_\_\_

1a. Name this method of colouring fabric.

Fold the fabric.

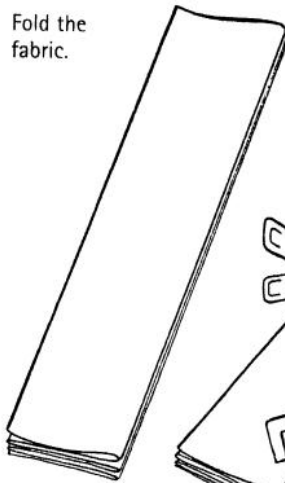

Position bulldog clips diagonally on the edge of the fabric.

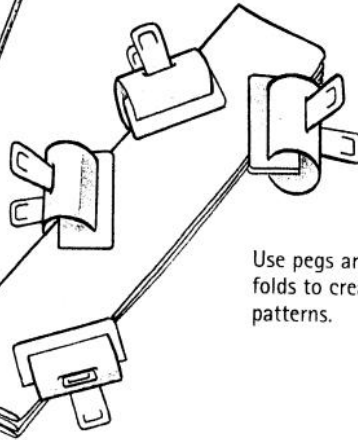

Use pegs and folds to create patterns.

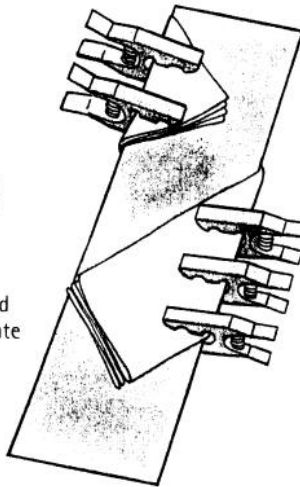

**Random tying**

Simply draw up the fabric using your fingers and tie with thread. Do this randomly over the fabric.

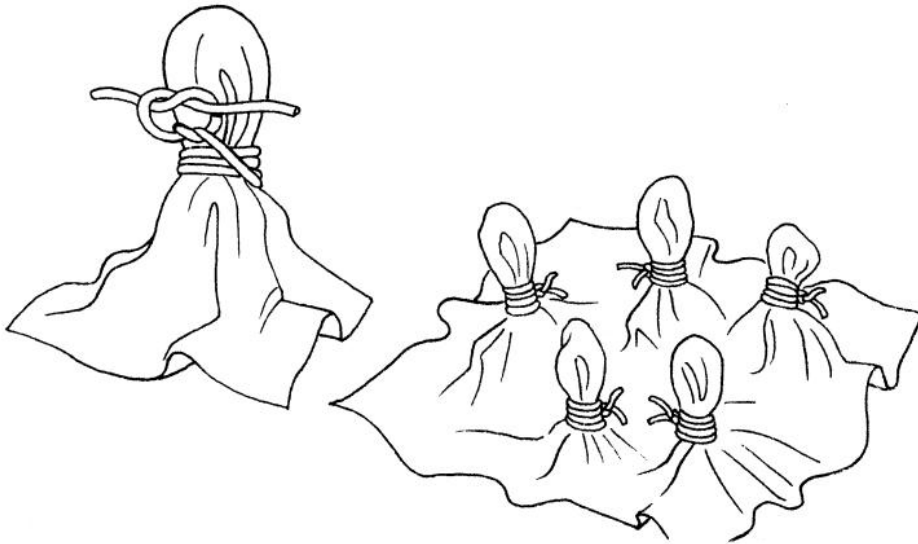

Method: \_\_\_\_\_

(1 mark)

b. Using the diagrams to help you, make a list of **six** things used to make these designs.  
(i) \_\_\_\_\_ (ii) \_\_\_\_\_ (iii) \_\_\_\_\_  
(iv) \_\_\_\_\_ (v) \_\_\_\_\_ (vi) \_\_\_\_\_  
(6 marks)

c. Name **three** things that can be dyed using this method.  
(i) \_\_\_\_\_ (ii) \_\_\_\_\_ (iii) \_\_\_\_\_  
(3 marks)

d. You bought some white fabric to be dyed.  
What kind of fabric would be best for dyeing? Give a reason why.  
**Fabric** \_\_\_\_\_  
**Reason** \_\_\_\_\_ (1, 2 marks)

e. It is advisable to soak the fabric overnight before dyeing. Give a reason for this.  
**Reason** \_\_\_\_\_ (2 marks)

f. Describe how to work the method of dyeing in question 1a.  
**Method** (i) \_\_\_\_\_  
(ii) \_\_\_\_\_  
(iii) \_\_\_\_\_  
(iv) \_\_\_\_\_  
(v) \_\_\_\_\_  
(vi) \_\_\_\_\_  
(6 marks)

g. Name **four** safety rules to be observed when dyeing fabrics.  
(i) \_\_\_\_\_  
(ii) \_\_\_\_\_  
(iii) \_\_\_\_\_  
(iv) \_\_\_\_\_ (4 marks)

h. Fruits, vegetables and other items can be used to colour fabrics. These are called natural dyes.  
Name **three** natural dyes that can be used to colour fabric.  
Ex. curry powder is used to obtain a yellow colour.  
(i) \_\_\_\_\_ (ii) \_\_\_\_\_ (iii) \_\_\_\_\_  
(3 marks)

i. Give **one** advantage and **one** disadvantage of using natural dyes to colour fabrics.  
**Advantage** \_\_\_\_\_  
**Disadvantage** \_\_\_\_\_ (2 marks)

- j. On this diagram mark  
 (i) the warp thread  
 (ii) the weft thread  
 (iii) the selvedge  
 (iv) the bias

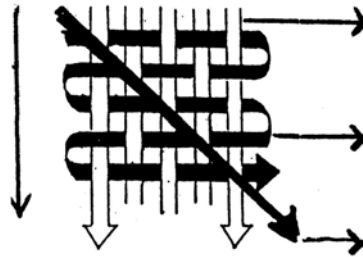

(4 marks)

- k. Name **two** methods of making fabrics.

(i) \_\_\_\_\_ (ii) \_\_\_\_\_ (2 marks)

- 2a. Bathroom accessories need to be cleaned regularly as they are always in use. In a bathroom we find towels, bath robes, rugs or mats and curtains.

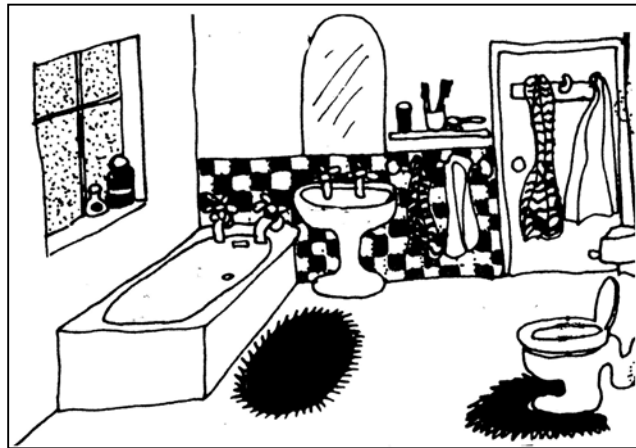

Look at the bathroom in the picture. All accessories are made from cotton. Why is cotton suitable for use in a bathroom? Make a list of **four** properties to prove the suitability of cotton.

**Properties of cotton** (i) \_\_\_\_\_  
 (ii) \_\_\_\_\_  
 (iii) \_\_\_\_\_  
 (iv) \_\_\_\_\_

(4 marks)

- b. Give the symbol and temperature for ironing cotton.

	Symbol	Temperature
<b>Cotton</b>		

(2 marks)

c. This design was used to decorate a curtain for the bathroom in question 2a.

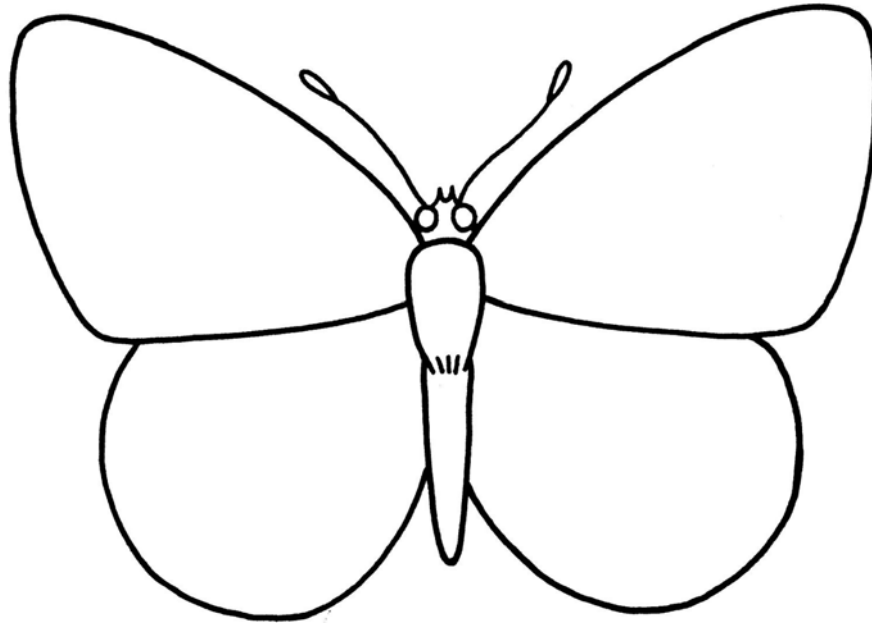

Using applique, fill in the design showing:

- (i) **two** types of fabric.
- (ii) **one** colour of curtain.
- (iii) **three** colours for applique.
- (iv) **five** decorative stitches. (2, 1, 3, 5 marks)

d. Besides applique, what other methods can be used to work this design? Name **two**.

- (i) \_\_\_\_\_
- (ii) \_\_\_\_\_ (2 marks)

e. It is important for curtains to be sunlight resistant. Draw a diagram and describe an experiment to find out if a fabric is sunlight resistant.

**Experiment – Sunlight resistant**

**Diagram**

**Method**

- (i) \_\_\_\_\_
- (ii) \_\_\_\_\_
- (iii) \_\_\_\_\_
- (iv) \_\_\_\_\_
- (v) \_\_\_\_\_

(2, 5 marks)

f. List **four** basic features you, as a consumer, should keep in mind when buying bathroom accessories.

- (i) \_\_\_\_\_
- (ii) \_\_\_\_\_
- (iii) \_\_\_\_\_
- (iv) \_\_\_\_\_

(4 marks)

3a. Draw these stitches.

**Draw**

(i) zigzag	
(ii) three step zigzag	
(iii) herringbone stitch	
(iv) machining ( <i>straight stitch</i> )	
(v) chain stitch	
(vi) hemming	

(6 marks)

b. These stitches are all p\_\_\_\_\_ stitches.

(1 mark)

c. These stitches can be divided into three groups.  
Put these stitches in their proper group.

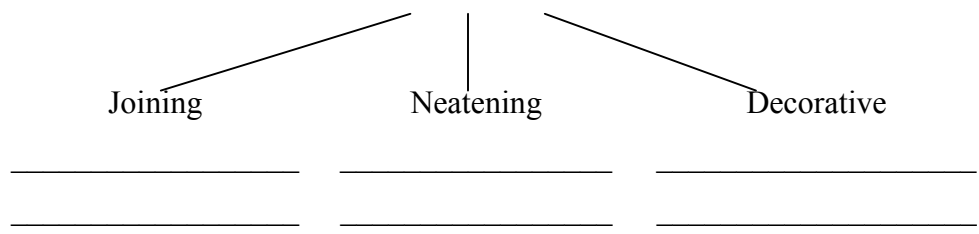

(6 marks)

4a. A steam iron should have these important features. Give a reason for each.

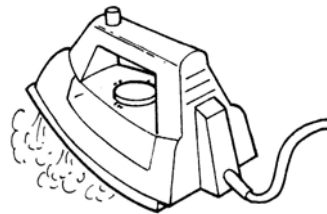

A steam iron should:

(i) have a transparent water tank.

**Reason** \_\_\_\_\_

(ii) be lightweight.

**Reason** \_\_\_\_\_

(iii) have a temperature regulator marked with symbols.

**Reason** \_\_\_\_\_

(3 marks)

b. Name **three** other pressing tools.

(i) \_\_\_\_\_ (ii) \_\_\_\_\_ (iii) \_\_\_\_\_ (3 marks)

c. Give the function of these parts of the sewing machine.

**Function (Use)**

(i) free arm \_\_\_\_\_

(ii) stitch length selector \_\_\_\_\_

(iii) feed dog \_\_\_\_\_

(iv) balance wheel \_\_\_\_\_ (4 marks)

d. A sewing machine always has a tool box. Name **three** important things you should have in the tool box.

(i) \_\_\_\_\_ (ii) \_\_\_\_\_ (iii) \_\_\_\_\_ (3 marks)

e. Name and draw:

**Two** measuring tools.

	Draw	Draw	
Name →			← Name

(2, 2 marks)

**Two** cutting tools.

	Draw	Draw	
Name →			← Name

(2, 2 marks)