



Rewarding Learning

General Certificate of Secondary Education
2014

--	--	--	--	--

Candidate Number

--	--	--	--

StudentBounty.com

Technology and Design

Unit 3: Product Design

[GTD31]

ML

TUESDAY 3 JUNE, AFTERNOON

TIME

1 hour, plus your additional time allowance.

INSTRUCTIONS TO CANDIDATES

Write your Centre Number and Candidate Number in the spaces provided at the top of this page.

Write your answers in the spaces provided in this question paper.

Questions which require drawing or sketching should be completed using an HB pencil. All other questions must be completed in blue or black ink.

Do not write with a gel pen.

Answer **all eight** questions.

INFORMATION FOR CANDIDATES

The total mark for this paper is 80.

Figures in brackets printed down the right-hand side of pages indicate the marks awarded to each question or part question.

2 Manufacturing practices involve the use of machines and power tools.

State **two** applications/uses of each of the following machines.

Circular Saw

1. _____
_____ [1]

2. _____
_____ [1]

Milling Machine

1. _____
_____ [1]

2. _____
_____ [1]

Planer

1. _____
_____ [1]

2. _____
_____ [1]

Lathe

1. _____
_____ [1]

2. _____
_____ [1]

Examiner Only

Marks **Remark**

Total Question 2

[Turn over

(b) State **three** properties of aluminium alloy which make it a suitable material for the ladder.

1. _____
2. _____
3. _____ [3]

(c) State the advantage of buying a ladder with the Kitemark or CE markings.

- _____
- _____ [2]

(d) Outline **two** design features of the ladder which are based on anthropometric data.

1. _____
2. _____ [2]

Examiner Only

Marks Remark

Total Question 3

[Turn over



BLANK PAGE
DO NOT WRITE ON THIS PAGE
(Questions continue overleaf)

(ii) What shape/form of material should the company order for manufacturing the body?

_____ [1]

(iii) Name a manufacturing process which would be used to shape the body.

_____ [2]

Examiner Only	
Marks	Remark
Total Question 5	

[Turn over

6 An outline diagram of a manufactured component is shown in Fig. 3. The diagram also shows **two** key dimensions and their tolerance.

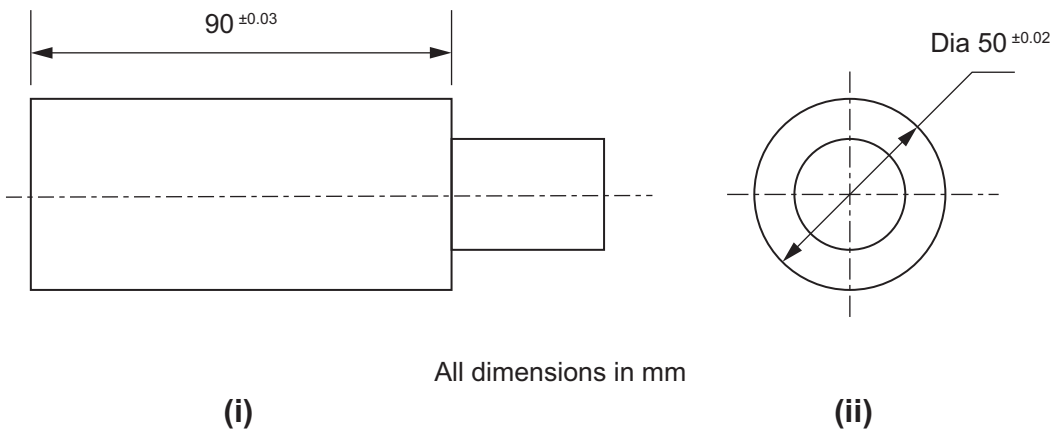

Fig. 3

(a) Calculate the maximum and minimum acceptable values for each of the given dimensions.

(i) Maximum _____ Minimum _____ [1]

(ii) Maximum _____ Minimum _____ [1]

(b) During sample testing of the components it was found that 10% were outside the tolerance.

(i) Explain what is meant by sample testing.

 _____ [2]

Examiner Only	
Marks	Remark

(ii) The quality control department demanded that this percentage should be reduced.

Give **one** reason why the quality control department would want this percentage reduced.

_____ [1]

(iii) Give **one** method the company could use to reduce this percentage.

_____ [1]

(c) Give **two** characteristics of quality assurance.

1. _____ [1]

2. _____ [1]

Examiner Only

Marks Remark

Total Question 6

[Turn over

7 Freehand sketches are frequently used in the communication of design ideas.

(a) (i) Give **one** reason why it is important to produce good freehand sketches.

_____ [1]

(ii) Annotation or notes are often added to sketches.

What is the purpose of adding annotation to freehand sketches?

_____ [1]

(iii) Give **two** advantages of using brief notes for annotation rather than long comments.

1. _____

2. _____
_____ [2]

Examiner Only	
Marks	Remark

(b) The design process also makes use of modelling techniques which include mock-ups, prototypes and computer modelling.

(i) State a benefit of using computer modelling.

_____ [1]

(ii) Explain the difference between mock-ups and prototypes. Your explanation should include how, when and why each would be used by a designer in the design process.

_____ [3]

Examiner Only	
Marks	Remark
Total Question 7	

8 Using an annotated sketch or sketches, design an adjustable desk lamp suitable for a bedside table or unit. The lamp is to be made from materials generally available in a school workshop. The design must satisfy the following:

- The height or angle of the lamp should be easily adjustable. [4]
- Material(s) selection, justification and the economy of material(s) used. [4]
- It must have an on/off switch and its own 9 volt battery supply which must be accessible to replace the battery. Details of circuit/electronic systems are not asked for. [4]
- Must be stable to sit on a bedside table or unit. [4]
- Must be an aesthetically pleasing and functional design. [4]
- Good quality annotated sketches should be used. A minimum of three overall dimensions should be included. [4]

Use the next page for your answer. If you need more space there is an additional page overleaf.

Examiner Only	
Marks	Remark
Total Question 8	

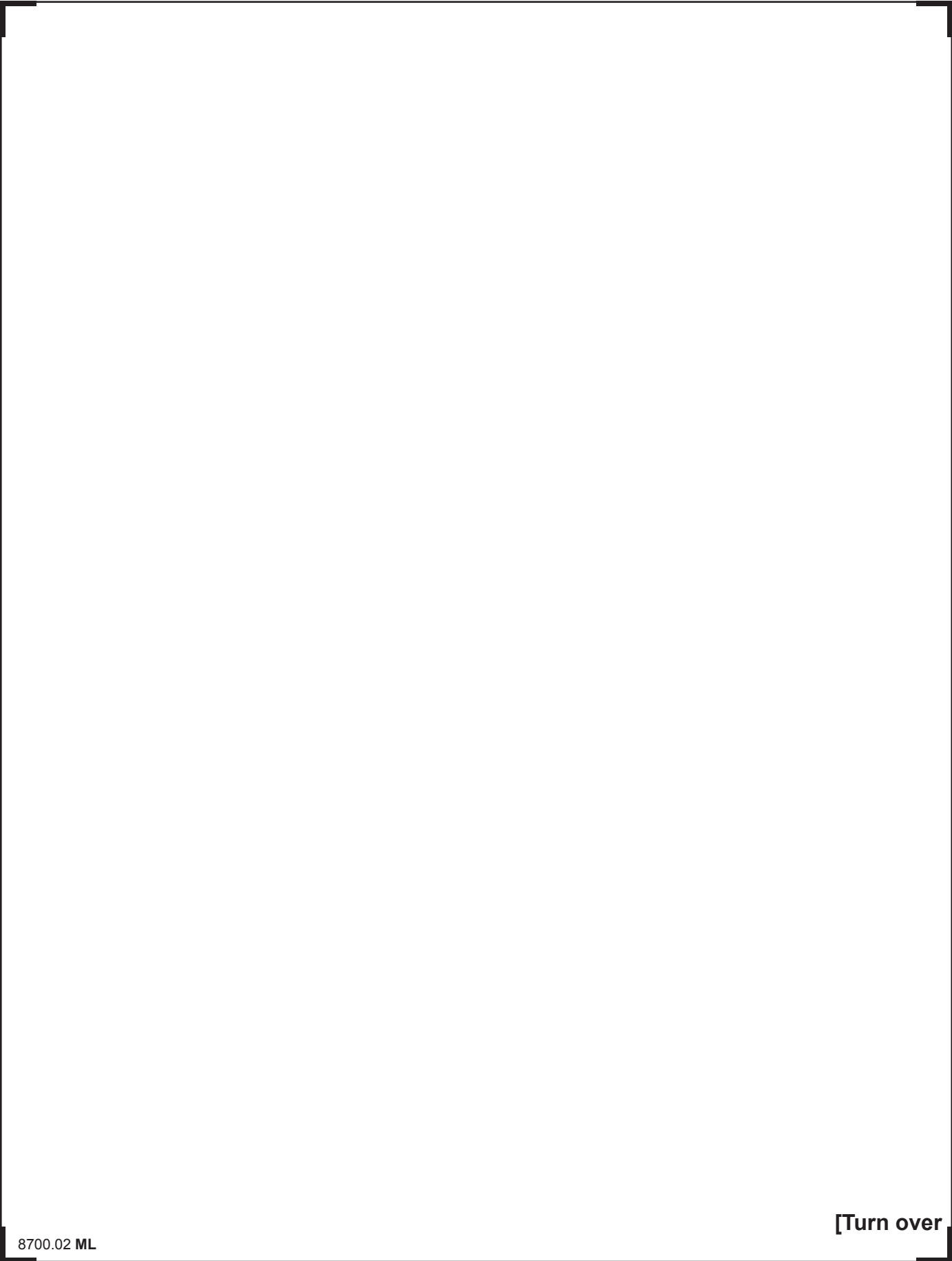

8700.02 ML

[Turn over



8700.02 ML



THIS IS THE END OF THE QUESTION PAPER

8700.02 ML

DO NOT WRITE ON THIS PAGE

8700.02 ML





DO NOT WRITE ON THIS PAGE

8700.02 ML

DO NOT WRITE ON THIS PAGE

For Examiner's use only	
Question Number	Marks
1	
2	
3	
4	
5	
6	
7	
8	

Total Marks	
--------------------	--

Examiner Number

Permission to reproduce all copyright material has been applied for.
In some cases, efforts to contact copyright holders may have been unsuccessful and CCEA
will be happy to rectify any omissions of acknowledgement in future if notified.