



Rewarding Learning

General Certificate of Secondary Education

2009

StudentBounty.com

Centre

71

Candidate Number

## Motor Vehicle and Road User Studies

### Paper 1 Foundation Tier

[G6802]

MONDAY 11 MAY, MORNING



G6802

For Examiner's  
use only

Question Number	Marks
1–20	
21	
22	
23	
24	
25	
26	
27	
28	
29	
30	
31	
32	
33	
34	
35	
36	
37	
38	
39	
40	
41	
42	
43	
44	
45	
46	
47	
48	
49	
50	
51	
52	

Total  
Marks

#### TIME

1 hour 30 minutes.

#### INSTRUCTIONS TO CANDIDATES

Write your Centre Number and Candidate Number in the spaces provided at the top of this page.

Answer **all fifty-two** questions.

Section A – Answer **all twenty** questions. Record your answers by marking the appropriate letter on the answer sheet provided. Use only the spaces numbered 1 to 20. Keep in sequence when answering.

Section B – Answer **all thirty-two** questions. Write your answers in the spaces provided in this question paper.

You are provided with an insert for use with Questions **44** and **48** in this paper. Do not write your answers on this insert.

#### INFORMATION FOR CANDIDATES

The total mark for this paper is 120.

Quality of written communication will be assessed in Questions **51** and **52**.

In Section A, all questions carry equal marks, i.e. **one** mark for each question.

In Section B, the figures in brackets printed down the right-hand side of pages indicate the marks awarded to each question or part question.

You are advised to spend approximately 25 minutes on Section A and 65 minutes on Section B.

You may use an electronic calculator.

**BLANK PAGE**

## Section A

You must answer **all twenty** questions.

Each of the questions or incomplete statements in this section is followed by five possible answers A, B, C, D and E. Choose the best answer for each question. Do this by putting a thick pencil line through the correct letter in the boxes provided on your answer sheet. You should spend approximately **25 minutes** on this section.

**1** The maximum speed limit for a large goods vehicle on a dual carriageway in mph is

- A 30.
- B 40.
- C 50.
- D 60.
- E 70.

**2** Which of the following statements about alcohol is *false*?

- A It is addictive.
- B It can impair vision.
- C It slows reactions.
- D It is a depressant.
- E It is a stimulant.

**3** The legal driving limit for alcohol in breath is

- A 25  $\mu\text{g}/100\text{ml}$ .
- B 30  $\mu\text{g}/100\text{ml}$ .
- C 35  $\mu\text{g}/100\text{ml}$ .
- D 40  $\mu\text{g}/100\text{ml}$ .
- E 45  $\mu\text{g}/100\text{ml}$ .

- 4 A continuous double white line along the centre of a road means
- A do not cross these lines.
  - B do not overtake.
  - C dangerous bend.
  - D overtake with caution.
  - E junction ahead.
- 5 Road signs giving negative instructions are usually
- A circular with a red insert.
  - B circular with a red border.
  - C triangular with a red border.
  - D triangular with a blue border.
  - E rectangular with a blue insert.
- 6 Which one of the following is **not** a factor in determining a driver's reaction time?
- A old age
  - B age of vehicle
  - C alcohol
  - D tiredness
  - E anxiety

- 7 A flashing green man at a pelican crossing means a motorist must
- A stop.
  - B prepare to go.
  - C go.
  - D go if the crossing is clear.
  - E wait until the light turns green.
- 8 Which one of the following is **not** recommended in the fog code?
- A reduce speed.
  - B use dipped headlights.
  - C follow someone else's tail lights.
  - D allow more time for your journey.
  - E use rear fog lamps/lights.
- 9 The amount the insured has to pay before the insurance company makes payment in any claim is
- A indemnity.
  - B excess.
  - C personal liability.
  - D premium.
  - E knock for knock.

**10** Which of the following liabilities is **not** included in Third Party insurance cover?

- A injury to passengers
- B accidents caused by passengers
- C damage caused by fire
- D injuries to other people
- E damage to other people's property caused by the insured vehicle

**11** The only fluid level required by law to be maintained in a motor vehicle is

- A oil.
- B brake fluid.
- C power steering fluid.
- D water in radiator.
- E water in windscreen washer.

**12** The vehicle test (MOT) tests which one of the following?

- A engine oil viscosity
- B strength of anti-freeze in the cooling system
- C acid level in the battery
- D condition of in-line fuses
- E exhaust gas emissions

- 13** A car travelling at 55 mph will cover a distance of 165 miles in
- A  $\frac{1}{2}$  hour.
  - B 1 hour.
  - C  $1\frac{1}{2}$  hours.
  - D 2 hours.
  - E 3 hours.
- 14** On a journey of 100 miles, how many gallons of petrol are used by a car with a fuel consumption of 40 mpg?
- A  $\frac{1}{2}$
  - B  $1\frac{1}{2}$
  - C 2
  - D  $2\frac{1}{2}$
  - E 3
- 15** The first priority on arrival at the scene of a serious traffic accident would be to
- A send for the emergency services.
  - B look for help.
  - C protect the accident scene.
  - D secure the vehicles.
  - E check for injuries.

- 16** In a four-stroke engine, if both valves are closed and the piston is rising, the engine is on the
- A power stroke.
  - B induction stroke.
  - C exhaust stroke.
  - D transfer stroke.
  - E compression stroke.
- 17** The connecting rod connects the
- A big ends to the crankshaft.
  - B pistons to the crankshaft.
  - C cylinder head to the cylinder block.
  - D sump to the cylinder block.
  - E crankshaft to the flywheel.
- 18** In which of the following systems would you find the differential?
- A transmission
  - B electrical
  - C braking
  - D suspension
  - E exhaust



- 19** Most cars have batteries which produce 12 volts. To create a suitable spark at the spark plug this must be boosted to approximately
- A 30 volts.
  - B 300 volts.
  - C 3000 volts.
  - D 30 000 volts.
  - E 300 000 volts.
- 20** Which one of the following allows one rear wheel to turn faster than the other, when cornering?
- A universal joints
  - B back axle
  - C differential
  - D distributor
  - E big end

## Section B

You must answer **all thirty-two** questions.

You should spend approximately **65 minutes** on this section.

- 21** Where would you expect to find this sign?



**Fig. 21.1**

---

 [1]

- 22** Name **one** disadvantage of a jet style helmet.

---

 [1]

- 23** What is the name given to a temporary insurance certificate?

---

 [1]

- 24** Explain briefly why vehicles now have an emissions tax.

---



---

[2]

Examiner Only	
Marks	Remark

**25** When might high-sided vehicles have to drive in the middle of the road?

---



---

[1]

**26** There are many reasons why you should not drive when tired. Name **two**.

1. \_\_\_\_\_
2. \_\_\_\_\_ [2]

**27** Describe briefly the main difference between a single track road and a single carriageway.

---



---

[1]

**28** Describe how to check the pressure of a tyre you suspect to be under inflated, if all the tyres are warm.

---



---

[1]

**29** Why would a driver need to complete a SORN (Statutory Off Road Notification) document?

---



---

[1]

Examiner Only	
Marks	Remark

**30** Explain briefly why lead was removed from petrol.

---



---

[1]

**31** Calculate the distance to the next junction if, driving at 60mph, it will take 22 minutes to get there.

---

miles [1]

**32 (a)** Apart from engine oil and coolant, name **three** engine fluid levels you could check on a motor vehicle.

1. \_\_\_\_\_
2. \_\_\_\_\_
3. \_\_\_\_\_ [3]

**(b)** Explain briefly why the cooling system has a water pump.

---



---

[1]

**33** Apart from being wet, list **two** road surface conditions which could be hazardous for the motorcyclist.

1. \_\_\_\_\_
2. \_\_\_\_\_ [2]

Examiner Only	
Marks	Remark



**37** In which country would you find an *autostrada*?

---

 [1]

**38** List **two** advantages and **two** disadvantages of using a car and a motorcycle as a means of transport.

Car advantage \_\_\_\_\_ [1]

Disadvantage \_\_\_\_\_ [1]

Motorcycle advantage \_\_\_\_\_ [1]

Disadvantage \_\_\_\_\_ [1]

**39 (a)** List **two** ways you could reduce the cost of motoring.

1. \_\_\_\_\_

2. \_\_\_\_\_ [2]

**(b)** Calculate the average speed of a vehicle which travelled 105 miles in  $2\frac{1}{2}$  hours.

---

 [1]

Examiner Only	
Marks	Remark

**40 (a)** Name **three** services you could ask for after coming across the scene of an accident.

3. \_\_\_\_\_ [3]

**(b) Name two ways in which a vehicle can be made secure at an accident scene.**

2. [2]

**41** What is the order of priorities in First Aid known as BBC?

C [3]

42 (a) Describe briefly the function of a universal joint.

---



---

[2]

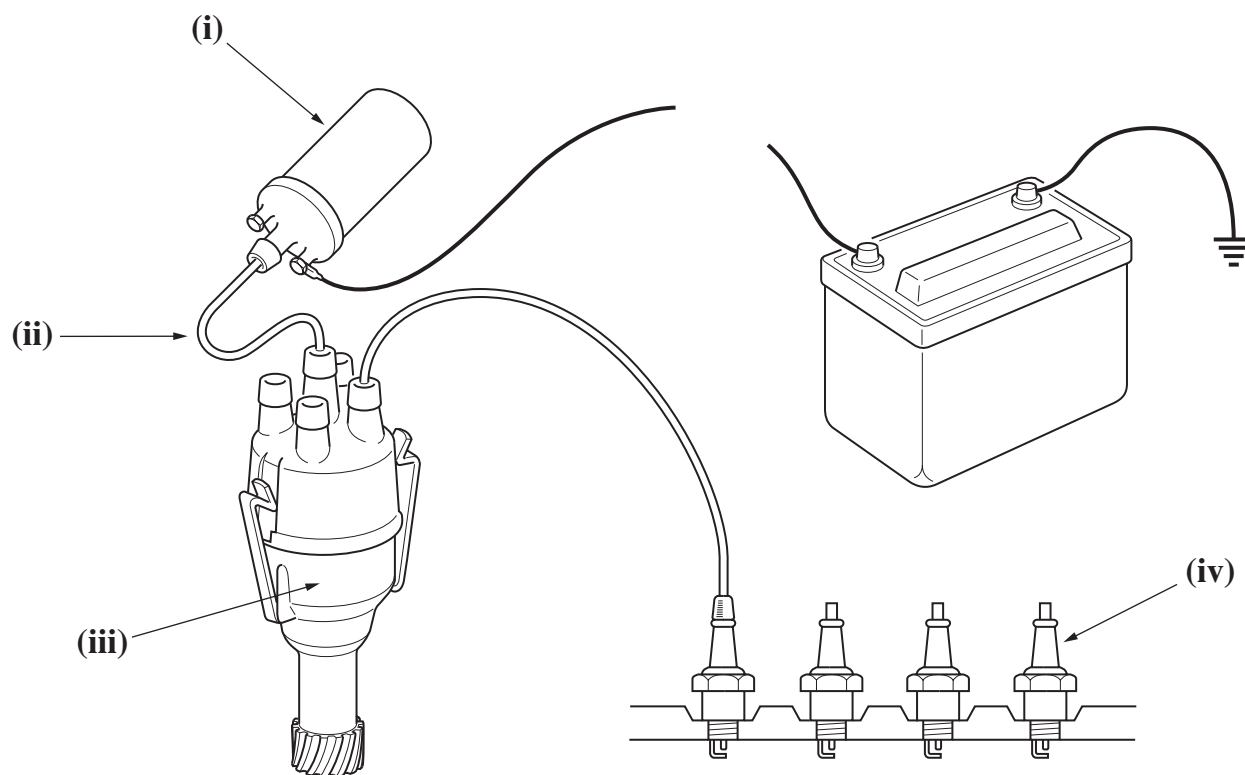

*The Car by E.F. Scott and B. Toby, published by Longman, 1978, ISBN 058222005X. © Pearson Education Ltd, publishers.*

**Fig. 42.1**

(b) Fig. 42.1 shows a car's charging system. Identify the parts marked (i)–(iv).

(i) \_\_\_\_\_ [1]

(ii) \_\_\_\_\_ [1]

(iii) \_\_\_\_\_ [1]

(iv) \_\_\_\_\_ [1]





46 (a) What is the purpose of the lifesaver check?

\_\_\_\_\_ [1]

(b) Outline briefly **two** occasions when you should use a lifesaver check.

\_\_\_\_\_  
\_\_\_\_\_  
\_\_\_\_\_ [2]

47 Name **two** ways in which information about speed limits can be given to the driver.

1. \_\_\_\_\_  
2. \_\_\_\_\_ [2]

Examiner Only	
Marks	Remark

Examiner Only	
Marks	Remark

1. \_\_\_\_\_
2. \_\_\_\_\_ [2]

Give **two** reasons why car sharing is being encouraged because of the construction work on the nearby Westlink in Belfast.

1. \_\_\_\_\_

2. \_\_\_\_\_ [2]

State **two** difficulties a driver could face in this weather.

1. \_\_\_\_\_

2. \_\_\_\_\_ [2]

1. \_\_\_\_\_
2. \_\_\_\_\_ [2]

1. \_\_\_\_\_
2. \_\_\_\_\_ [2]

**51 (a)** Name **two** actions which could identify you as a courteous driver.

1. \_\_\_\_\_
2. \_\_\_\_\_ [2]

**(b)** Explain briefly how being a courteous driver can make you a safer road user.

\_\_\_\_\_

\_\_\_\_\_

\_\_\_\_\_

\_\_\_\_\_

\_\_\_\_\_ [6]

Examiner Only	
Marks	Remark

**52** Young drivers between the age of 17–21 years are at the highest risk of accidents. Explain why this is the case and describe what young drivers could do to reduce the risks.

---

**THIS IS THE END OF THE QUESTION PAPER**

---



# GCSE Motor Vehicle and Road User Studies 2009

## Paper 1 Foundation Tier [G6802]

For use with Question 44



Fig. 44.1



Fig. 44.2



Fig. 44.3



Fig. 44.4

© Crown copyright reproduced under the terms of the Click Use Licence

For use with Question 48



Fig. 48.1



Fig. 48.2



Fig. 48.3



T65687/7

Permission to reproduce all copyright material has been applied for.  
In some cases, efforts to contact copyright holders may have been unsuccessful and CCEA  
will be happy to rectify any omissions of acknowledgement in future if notified.