

Candidate Forename		Candidate Surname	
---------------------------	--	--------------------------	--

Centre Number						Candidate Number				
----------------------	--	--	--	--	--	-------------------------	--	--	--	--

**OXFORD CAMBRIDGE AND RSA EXAMINATIONS
GENERAL CERTIFICATE OF SECONDARY EDUCATION**

B293B

MATHEMATICS B (MEI)

Paper 3 Section B (Higher Tier)

MONDAY 7 JUNE 2010: Afternoon

DURATION: 45 minutes

SUITABLE FOR VISUALLY IMPAIRED CANDIDATES

Candidates answer on the Question Paper

OCR SUPPLIED MATERIALS:

None

OTHER MATERIALS REQUIRED:

Geometrical instruments

Scientific or graphical calculator

Tracing paper (optional)

READ INSTRUCTIONS OVERLEAF

INSTRUCTIONS TO CANDIDATES

- Write your name clearly in capital letters, your Centre Number and Candidate Number in the boxes on the first page.
- Use black ink. Pencil may be used for graphs and diagrams only.
- Read each question carefully and make sure that you know what you have to do before starting your answer.
- Show your working. Marks may be given for a correct method even if the answer is incorrect.
- Answer **ALL** the questions.
- Write your answer to each question in the space provided. Additional paper may be used if necessary but you must clearly show your Candidate Number, Centre Number and question number(s).

INFORMATION FOR CANDIDATES

- The number of marks is given in brackets [] at the end of each question or part question.
- Section B starts with question 10.
- You are expected to use a calculator in Section B of this paper.
- Use the π button on your calculator or take π to be 3.142 unless the question says otherwise.
- The total number of marks for this Section is **36**.

FORMULAE SHEET: HIGHER TIER

Area of trapezium = $\frac{1}{2} (a + b)h$

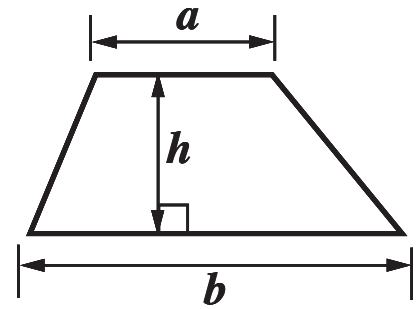

Volume of prism = (area of cross-section) \times length

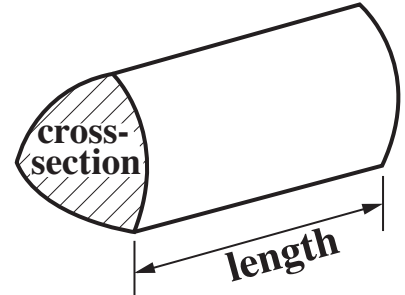

In any triangle ABC

Sine rule $\frac{a}{\sin A} = \frac{b}{\sin B} = \frac{c}{\sin C}$

Cosine rule $a^2 = b^2 + c^2 - 2bc \cos A$

Area of triangle = $\frac{1}{2} ab \sin C$

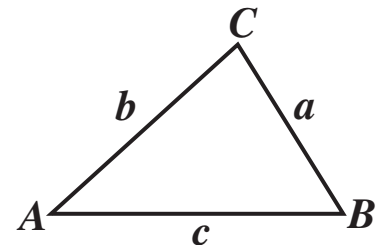

Volume of sphere = $\frac{4}{3}\pi r^3$

Surface area of sphere = $4\pi r^2$

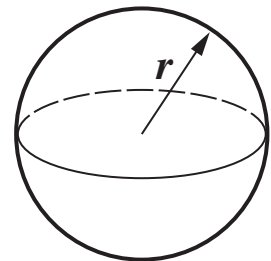

Volume of cone = $\frac{1}{3}\pi r^2 h$

Curved surface area of cone = $\pi r l$

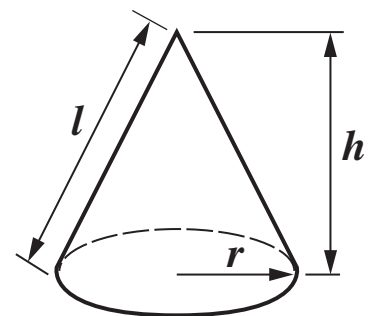

The Quadratic Equation

The solutions of $ax^2 + bx + c = 0$, where $a \neq 0$, are given by

$$x = \frac{-b \pm \sqrt{b^2 - 4ac}}{2a}$$

- 10 Ten runners recorded their times for both a 5 km run and a 10 km run.
Their times are recorded to the nearest minute.**

Runner	A	B	C	D	E	F	G	H	I	J
5 km time (minutes)	22	24	25	26	27	28	30	31	35	35
10 km time (minutes)	46	51	52	57	60	60	62	66	70	72

- (a) Complete the scatter graph of the data on the grid.
The first five points have been plotted for you.
[2 marks]**

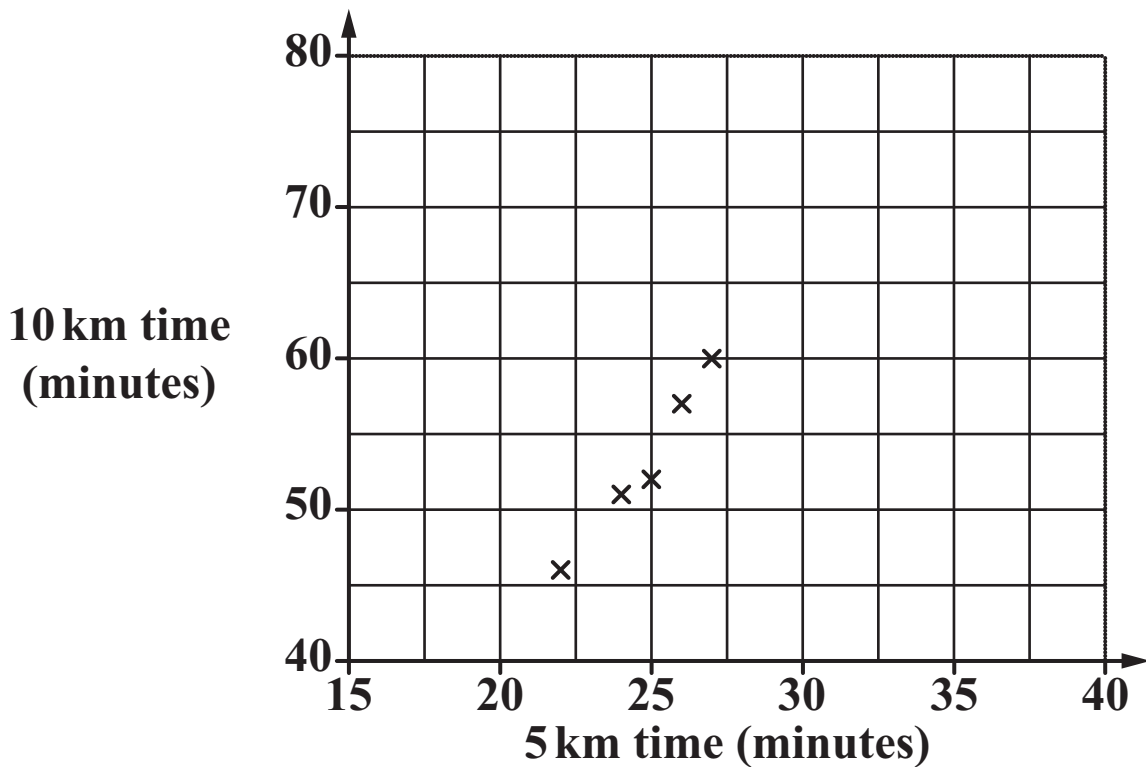

- (b) (i) Draw a line of best fit on the scatter graph.
[1 mark]**

**(ii) Use your line of best fit to predict the 10 km time of a runner who took 33 minutes to run 5 km.
[1 mark]**

(b) (ii) _____ minutes

**(c) Describe the correlation between the times for the 5 km run and the 10 km run.
[1 mark]**

(c) _____

11 (a) This is the floor plan of Ryan's office.

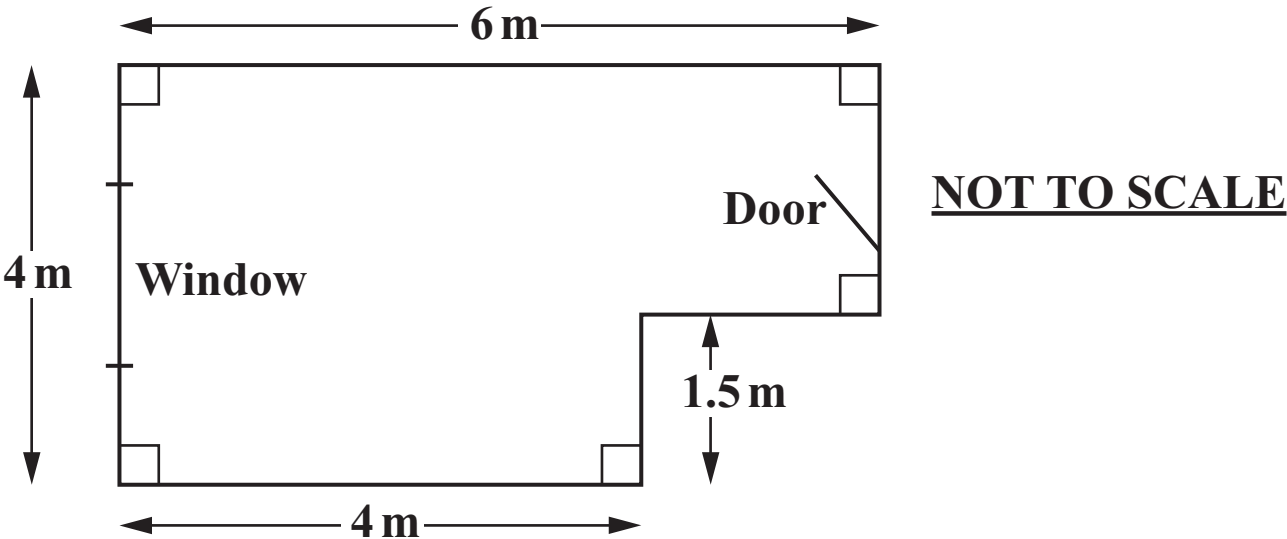

Work out the area of the floor.
[2 marks]

(a) _____ m²

- (b) This is the shape of the window in Ryan's office. The top is a semi-circle and the bottom is a rectangle.

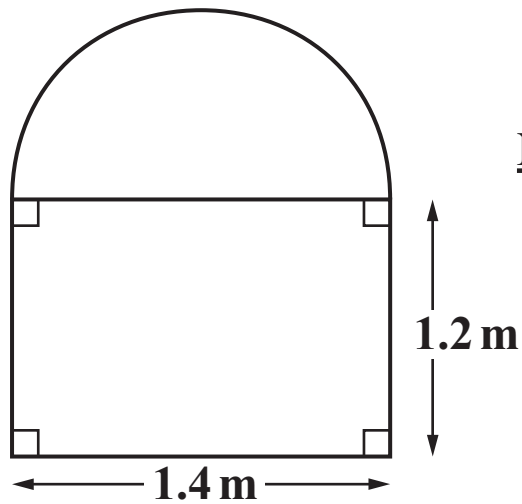

NOT TO SCALE

Work out the area of the window.
[4 marks]

(b) _____ m²

- (c) In an office, the area of the window should be at least 10% of the area of the floor.

Is the area of the window in Ryan's office large enough?

Explain your answer.

[2 marks]

- 12 Find all the integers that satisfy this inequality.

[2 marks]

$$1 < 2n - 3 < 8$$

BLANK PAGE

13 Ken used the following method to find the width of a straight section of canal.

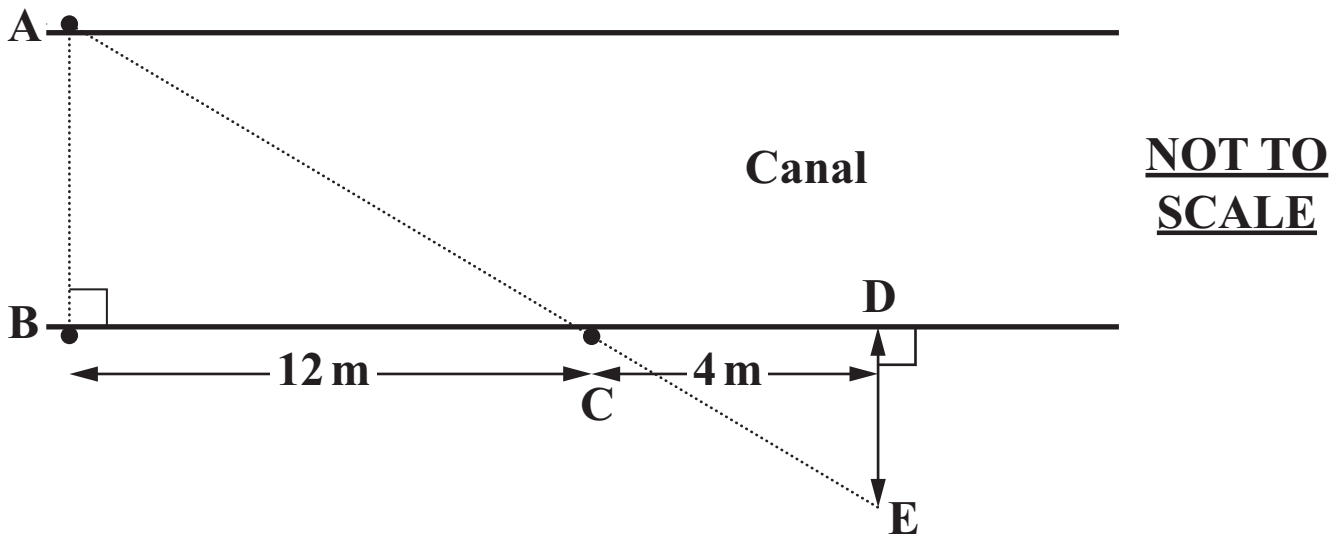

He placed a stake at B on the towpath, directly opposite a tree at A on the other bank.

He walked 12 metres along the path to a point C, where he placed another stake.

He walked a further 4 metres to a point D.

He then walked directly away from the canal to a point E so that E, A and C were in a direct line.

(a) Show that the triangles ABC and EDC are similar.
[3 marks]

(b) The distance DE is 3 metres.

**Calculate the width, AB, of the canal.
[2 marks]**

(b) _____ m

**14 Solve, algebraically, the following simultaneous equations.
[4 marks]**

$$2x + 3y = 7$$

$$3x + 2y = 13$$

$$x = \underline{\hspace{10cm}}$$

$$y = \underline{\hspace{10cm}}$$

BLANK PAGE

15 Tanya often travels to London on business. In the spring she went 40 times.

For each of these journeys, she recorded the number of minutes that the train was late in reaching London. (The train was never early.)

These data are summarised in the table.

MINUTES LATE	FREQUENCY
$0 \leq t < 1$	16
$1 \leq t < 2$	12
$2 \leq t < 3$	10
$3 \leq t < 5$	0
$5 \leq t < 10$	2

- (a) Calculate an estimate of the mean number of minutes that the train was late reaching London.
[4 marks]**

(a) _____ minutes

In the summer she also recorded the number of minutes that the train was late reaching London.

The histogram summarises the data for the summer.

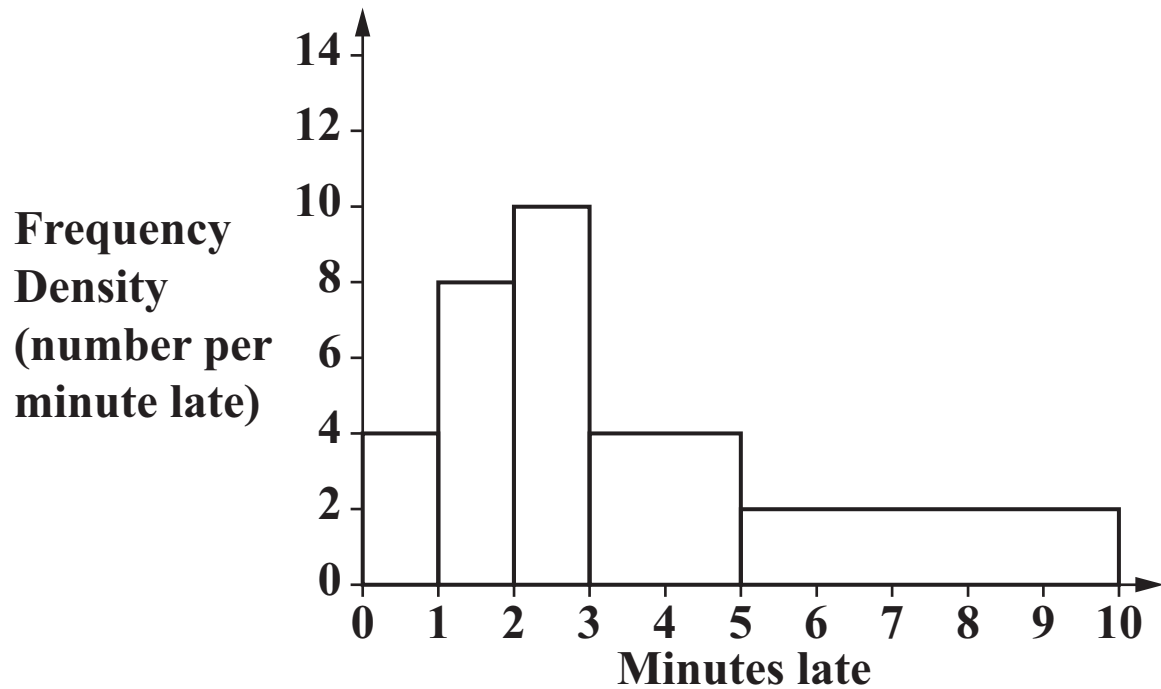

- (b) Use the histogram to work out the number of trains that were between 3 and 5 minutes late.**
[2 marks]

(b) _____

- (c) An estimate of the mean number of minutes late in the summer is 3.65.

Make two comparisons between the punctuality of the trains in the spring and in the summer.

[2 marks]

TURN OVER FOR QUESTION 16

16 The side of a hill is in the form of a triangular prism as shown.

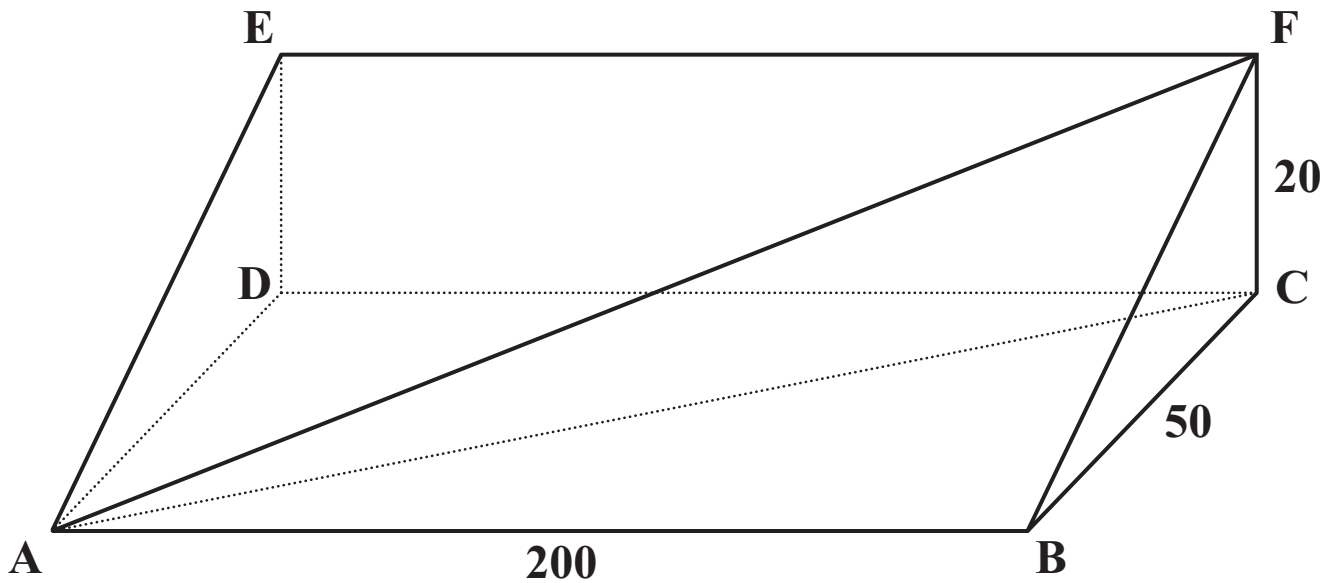

The rectangle ABCD is horizontal with $AB = 200$ m and $BC = 50$ m.

The rectangle CDEF is vertical with $CF = 20$ m.

The line AF represents a footpath that goes in a straight line up the hill from A to F.

**Find the angle the footpath makes with the horizontal.
[4 marks]**





Copyright Information

OCR is committed to seeking permission to reproduce all third-party content that it uses in its assessment materials. OCR has attempted to identify and contact all copyright holders whose work is used in this paper. To avoid the issue of disclosure of answer-related information to candidates, all copyright acknowledgements are reproduced in the OCR Copyright Acknowledgements Booklet. This is produced for each series of examinations, is given to all schools that receive assessment material and is freely available to download from our public website (www.ocr.org.uk) after the live examination series.

If OCR has unwittingly failed to correctly acknowledge or clear any third-party content in this assessment material, OCR will be happy to correct its mistake at the earliest possible opportunity.

For queries or further information please contact the Copyright Team, First Floor, 9 Hills Road, Cambridge CB2 1GE.

OCR is part of the Cambridge Assessment Group; Cambridge Assessment is the brand name of University of Cambridge Local Examinations Syndicate (UCLES), which is itself a department of the University of Cambridge.