

Write your name here

Surname

Other names

Pearson
Edexcel GCSE

Centre Number

--	--	--	--	--

Candidate Number

--	--	--	--	--

Chinese

Paper 3F: Reading and Understanding in Chinese

Foundation Tier

Monday 21 May 2018 – Afternoon

Time: 45 minutes

Paper Reference

5CN03/3F

You do not need any other materials.

Total Marks

Instructions

- Use **black** ink or ball-point pen.
- **Fill in the boxes** at the top of this page with your name, centre number and candidate number.
- On page 2 indicate which set of questions you intend to work from, either **TRADITIONAL** or **SIMPLIFIED** characters.
- Answer **all** questions.
- Answer the questions in the spaces provided
– *there may be more space than you need.*
- You must **not** use a dictionary.

Information

- The total mark for this paper is 40.
- The marks for **each** question are shown in brackets
– *use this as a guide as to how much time to spend on each question.*

Advice

- Read each question carefully before you start to answer it.
- Try to answer every question.
- Check your answers if you have time at the end.

Turn over ►

P57746A

©2018 Pearson Education Ltd.

1/1/1/1/



Pearson

Use of Chinese Characters

All passages and questions are printed twice, once in traditional/full characters and once in simplified characters.

Questions in traditional/full characters begin on page 3.

Questions in simplified characters begin on page 17.

You may work from whichever version you wish. Please indicate which set of questions you intend to work from by putting a cross in one box below:

TRADITIONAL/FULL 繁體字	<input type="checkbox"/>
SIMPLIFIED 简体字	<input type="checkbox"/>



DO NOT WRITE IN THIS AREA

DO NOT WRITE IN THIS AREA

DO NOT WRITE IN THIS AREA

繁體字

TRADITIONAL/FULL CHARACTER VERSION

(Simplified Character Version begins on page 17)



TRADITIONAL/FULL CHARACTERS

Answer ALL questions.

Some questions must be answered with a cross in a box ☒. If you change your mind about an answer, put a line through the box ☒ and then mark your new answer with a cross ☒.

My belongings

1 Here are some of David's belongings.

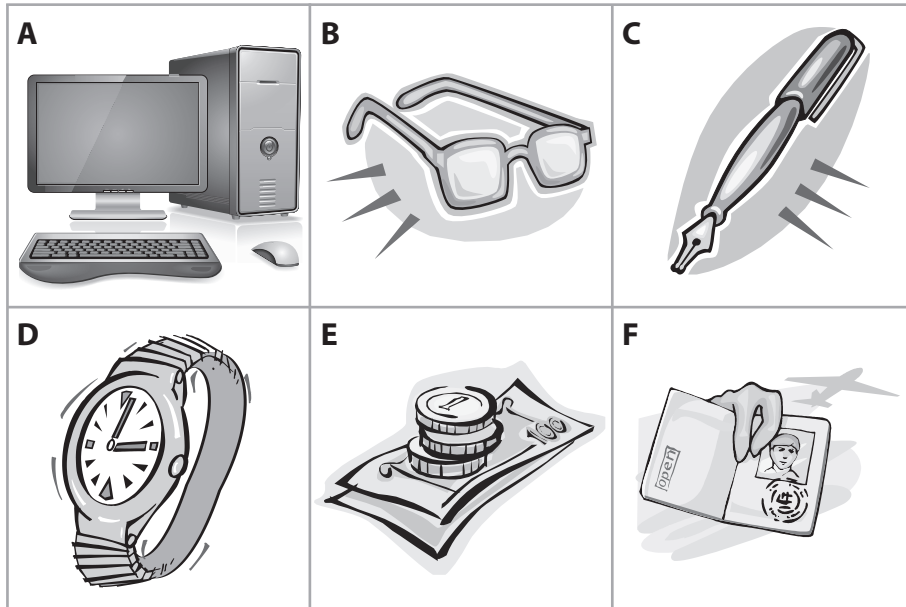

Match the pictures to the correct items.

Put a cross ☒ in the correct box.

	A	B	C	D	E	F
Example: 眼鏡	<input type="checkbox"/>	<input checked="" type="checkbox"/>	<input type="checkbox"/>	<input type="checkbox"/>	<input type="checkbox"/>	<input type="checkbox"/>
(i) 錢	<input type="checkbox"/>	<input type="checkbox"/>	<input type="checkbox"/>	<input type="checkbox"/>	<input type="checkbox"/>	<input type="checkbox"/>
(ii) 手錶	<input type="checkbox"/>	<input type="checkbox"/>	<input type="checkbox"/>	<input type="checkbox"/>	<input type="checkbox"/>	<input type="checkbox"/>
(iii) 護照	<input type="checkbox"/>	<input type="checkbox"/>	<input type="checkbox"/>	<input type="checkbox"/>	<input type="checkbox"/>	<input type="checkbox"/>
(iv) 筆	<input type="checkbox"/>	<input type="checkbox"/>	<input type="checkbox"/>	<input type="checkbox"/>	<input type="checkbox"/>	<input type="checkbox"/>

(Total for Question 1 = 4 marks)

DO NOT WRITE IN THIS AREA

DO NOT WRITE IN THIS AREA

DO NOT WRITE IN THIS AREA



TRADITIONAL/FULL CHARACTERS

Weather

2 A group of friends describe their plans for different weather conditions.

A hot	B raining	C cloudy
D snowing	E windy	F cold

Match the statements with the correct weather conditions.

Put a cross ☒ in the correct box.

	A	B	C	D	E	F
Example: 今天很冷，我要穿毛衣。	<input type="checkbox"/>	<input type="checkbox"/>	<input type="checkbox"/>	<input type="checkbox"/>	<input type="checkbox"/>	<input checked="" type="checkbox"/>
(i) 冬天下大雪，我要去滑雪。	<input type="checkbox"/>	<input type="checkbox"/>	<input type="checkbox"/>	<input type="checkbox"/>	<input type="checkbox"/>	<input type="checkbox"/>
(ii) 夏天很熱，我要去游泳。	<input type="checkbox"/>	<input type="checkbox"/>	<input type="checkbox"/>	<input type="checkbox"/>	<input type="checkbox"/>	<input type="checkbox"/>
(iii) 秋天風大，我要去放風箏。	<input type="checkbox"/>	<input type="checkbox"/>	<input type="checkbox"/>	<input type="checkbox"/>	<input type="checkbox"/>	<input type="checkbox"/>
(iv) 春天多雨，我要穿雨衣。	<input type="checkbox"/>	<input type="checkbox"/>	<input type="checkbox"/>	<input type="checkbox"/>	<input type="checkbox"/>	<input type="checkbox"/>

(Total for Question 2 = 4 marks)

DO NOT WRITE IN THIS AREA

DO NOT WRITE IN THIS AREA

DO NOT WRITE IN THIS AREA



TRADITIONAL/FULL CHARACTERS

Places to go

3 Where should each person go?

- A 美美要買一份英文報紙。
- B 大偉想和家人一起去看足球比賽。
- C 王勇想買一個照相機。
- D 明明要買火車票去北京。
- E 麗麗想和同學一起去看國畫展覽。
- F 馬田想買一杯咖啡。

Match the correct letter to the location by putting a in the correct box.

	A	B	C	D	E	F
Example: department store	<input checked="" type="checkbox"/>	<input checked="" type="checkbox"/>	<input checked="" type="checkbox"/>	<input checked="" type="checkbox"/>	<input checked="" type="checkbox"/>	<input checked="" type="checkbox"/>
(i) newsagent	<input type="checkbox"/>	<input type="checkbox"/>	<input type="checkbox"/>	<input type="checkbox"/>	<input type="checkbox"/>	<input type="checkbox"/>
(ii) coffee shop	<input type="checkbox"/>	<input type="checkbox"/>	<input type="checkbox"/>	<input type="checkbox"/>	<input type="checkbox"/>	<input type="checkbox"/>
(iii) ticket office	<input type="checkbox"/>	<input type="checkbox"/>	<input type="checkbox"/>	<input type="checkbox"/>	<input type="checkbox"/>	<input type="checkbox"/>
(iv) art gallery	<input type="checkbox"/>	<input type="checkbox"/>	<input type="checkbox"/>	<input type="checkbox"/>	<input type="checkbox"/>	<input type="checkbox"/>

(Total for Question 3 = 4 marks)

DO NOT WRITE IN THIS AREA

DO NOT WRITE IN THIS AREA

DO NOT WRITE IN THIS AREA



DO NOT WRITE IN THIS AREA

DO NOT WRITE IN THIS AREA

DO NOT WRITE IN THIS AREA

BLANK PAGE



TRADITIONAL/FULL CHARACTERS

My work

4 The following passage describes my daily routine and future plans.

每天早上我七點起床，去打太極拳，八點吃早餐。我喜歡喝牛奶、吃雞蛋和水果。八點半，我坐地鐵去博物館上班。我在博物館工作了四年。現在我想在銀行工作，當銀行經理。

Put a cross ☒ in the correct box.

Example: What time do I get up?

<input checked="" type="checkbox"/>	A 7.00am
<input type="checkbox"/>	B 7.30am
<input type="checkbox"/>	C 8.00am

(i) What do I like to drink with my breakfast?

<input type="checkbox"/>	A water
<input type="checkbox"/>	B milk
<input type="checkbox"/>	C tea

(ii) How do I travel to work?

<input type="checkbox"/>	A bicycle
<input type="checkbox"/>	B car
<input type="checkbox"/>	C underground

DO NOT WRITE IN THIS AREA

DO NOT WRITE IN THIS AREA

DO NOT WRITE IN THIS AREA



TRADITIONAL/FULL CHARACTERS

(iii) Where do I work?

<input type="checkbox"/>	A museum
<input type="checkbox"/>	B school
<input type="checkbox"/>	C shopping centre

(iv) What job would I like to do?

<input type="checkbox"/>	A bank manager
<input type="checkbox"/>	B sports teacher
<input type="checkbox"/>	C scientist

(Total for Question 4 = 4 marks)

DO NOT WRITE IN THIS AREA

DO NOT WRITE IN THIS AREA

DO NOT WRITE IN THIS AREA



TRADITIONAL/FULL CHARACTERS

Favourite pastimes

5 A group of friends describe what they like to do in their free time.

- A 大勇: 我喜歡看雜誌。
- B 馬田: 我喜歡玩電子遊戲。
- C 美美: 我喜歡在電影院看電影。
- D 東東: 我喜歡在公園打籃球。
- E 麗麗: 我喜歡上網聽音樂。

Match the item to the person.

Put a cross ☒ in the correct box.

	A	B	C	D	E
(i) play electronic games	<input type="checkbox"/>	<input type="checkbox"/>	<input type="checkbox"/>	<input type="checkbox"/>	<input type="checkbox"/>
(ii) listen to music	<input type="checkbox"/>	<input type="checkbox"/>	<input type="checkbox"/>	<input type="checkbox"/>	<input type="checkbox"/>
(iii) play basketball	<input type="checkbox"/>	<input type="checkbox"/>	<input type="checkbox"/>	<input type="checkbox"/>	<input type="checkbox"/>
(iv) watch films	<input type="checkbox"/>	<input type="checkbox"/>	<input type="checkbox"/>	<input type="checkbox"/>	<input type="checkbox"/>

(Total for Question 5 = 4 marks)

DO NOT WRITE IN THIS AREA

DO NOT WRITE IN THIS AREA

DO NOT WRITE IN THIS AREA



TRADITIONAL/FULL CHARACTERS

Weekend

6 What does my family do at the weekend?

- A 哥哥在圖書館看書。
- B 妹妹在床上睡覺。
- C 弟弟在花園裡踢足球。
- D 姐姐在書房裡寫電子郵件。
- E 爸爸在廚房做飯。
- F 媽媽在學習開車。

Write the correct letter in each box.

Example: learning to drive	F
(i) cooking	
(ii) reading	
(iii) playing football	
(iv) sleeping	

(Total for Question 6 = 4 marks)

DO NOT WRITE IN THIS AREA



TRADITIONAL/FULL CHARACTERS

Lili and Anna

7 The following passage is about Lili and Anna.

Read the text and write the correct letter to complete the sentences.

上個月，麗麗和安娜開始上中學，每天都要騎自行車去上學。麗麗有一輛藍色的自行車，安娜的是紅色的。

每個星期六，麗麗騎自行車到美術館學習畫畫。但是，安娜喜歡到河邊去跑步。

星期天晚上，麗麗喜歡去跳舞。安娜喜歡和朋友去唱歌。

A	B	C	D	E	F
cycling	jogging	walking	dancing	painting	singing

Write the correct letter in the box.

Example: Anna and Lili get to school by...	A
(i) Every Saturday Lili studies...	
(ii) By the river, Anna likes...	
(iii) On Sunday evening Lili likes...	
(iv) Anna and her friends like to go...	

(Total for Question 7 = 4 marks)

DO NOT WRITE IN THIS AREA

DO NOT WRITE IN THIS AREA

DO NOT WRITE IN THIS AREA



TRADITIONAL/FULL CHARACTERS

Occupations

8 A group of friends are describing their occupations.

- A 我是護士，在醫院工作。
- B 我是工程師，在工廠工作。
- C 我是老師，在小學工作。
- D 我是司機，在公共汽車公司工作。
- E 我是運動員，打網球。
- F 我是售貨員，在書店工作。

Write the correct letter in each box to match the occupations to the people.

Example: sportsman	E
(i) engineer	
(ii) nurse	
(iii) bus driver	
(iv) teacher	

(Total for Question 8 = 4 marks)

DO NOT WRITE IN THIS AREA

DO NOT WRITE IN THIS AREA

DO NOT WRITE IN THIS AREA



TRADITIONAL/FULL CHARACTERS

In a house

9 Here are some items that can be found in a house.

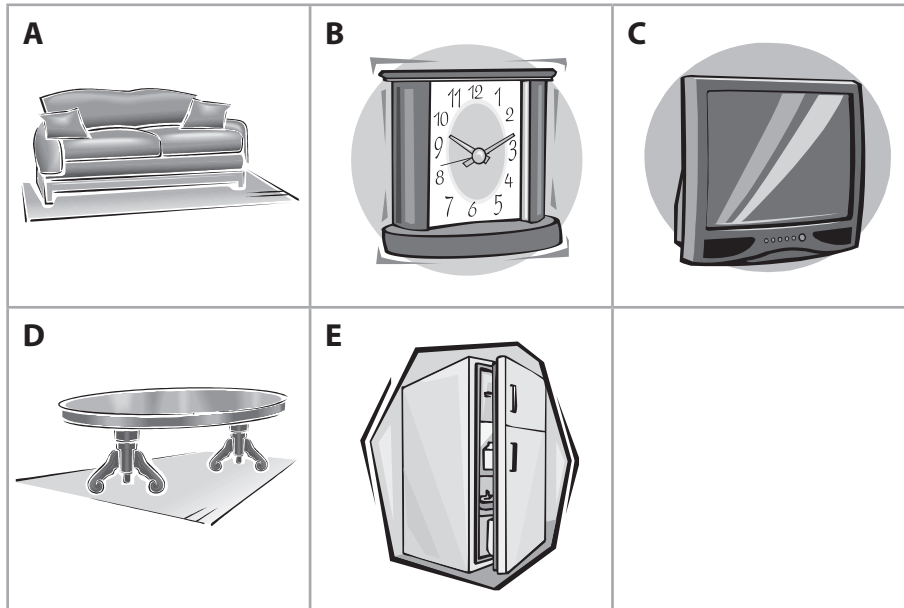

Match the pictures to the correct items.

Put a cross ☒ in the correct box.

	A	B	C	D	E
(i) 沙發	<input type="checkbox"/>	<input type="checkbox"/>	<input type="checkbox"/>	<input type="checkbox"/>	<input type="checkbox"/>
(ii) 電視	<input type="checkbox"/>	<input type="checkbox"/>	<input type="checkbox"/>	<input type="checkbox"/>	<input type="checkbox"/>
(iii) 桌子	<input type="checkbox"/>	<input type="checkbox"/>	<input type="checkbox"/>	<input type="checkbox"/>	<input type="checkbox"/>
(iv) 鐘	<input type="checkbox"/>	<input type="checkbox"/>	<input type="checkbox"/>	<input type="checkbox"/>	<input type="checkbox"/>

(Total for Question 9 = 4 marks)

DO NOT WRITE IN THIS AREA

DO NOT WRITE IN THIS AREA

DO NOT WRITE IN THIS AREA



TRADITIONAL/FULL CHARACTERS

A visit

10 This is a story about Ma Tian.

上個星期，馬田去看他的朋友，他朋友住在山上。山上有很多黃色的花兒。他有很多寵物，有小狗、小貓、馬和小牛。

Answer the following questions **in English**.

(a) Who did Ma Tian go to visit? (1)

(b) Where is this person's house? (1)

(c) What colour are the flowers? (1)

(d) What pets does he have? Give **one** detail. (1)

(Total for Question 10 = 4 marks)

TOTAL FOR PAPER: 40 MARKS

DO NOT WRITE IN THIS AREA

DO NOT WRITE IN THIS AREA

DO NOT WRITE IN THIS AREA



DO NOT WRITE IN THIS AREA

DO NOT WRITE IN THIS AREA

DO NOT WRITE IN THIS AREA

BLANK PAGE



DO NOT WRITE IN THIS AREA

DO NOT WRITE IN THIS AREA

DO NOT WRITE IN THIS AREA

简体字

SIMPLIFIED CHARACTER VERSION

(Traditional/Full Character Version begins on page 3)



P 5 7 7 4 6 A 0 1 7 3 2

SIMPLIFIED CHARACTERS

Answer ALL questions.

Some questions must be answered with a cross in a box ☒. If you change your mind about an answer, put a line through the box ☒ and then mark your new answer with a cross ☒.

My belongings

1 Here are some of David's belongings.

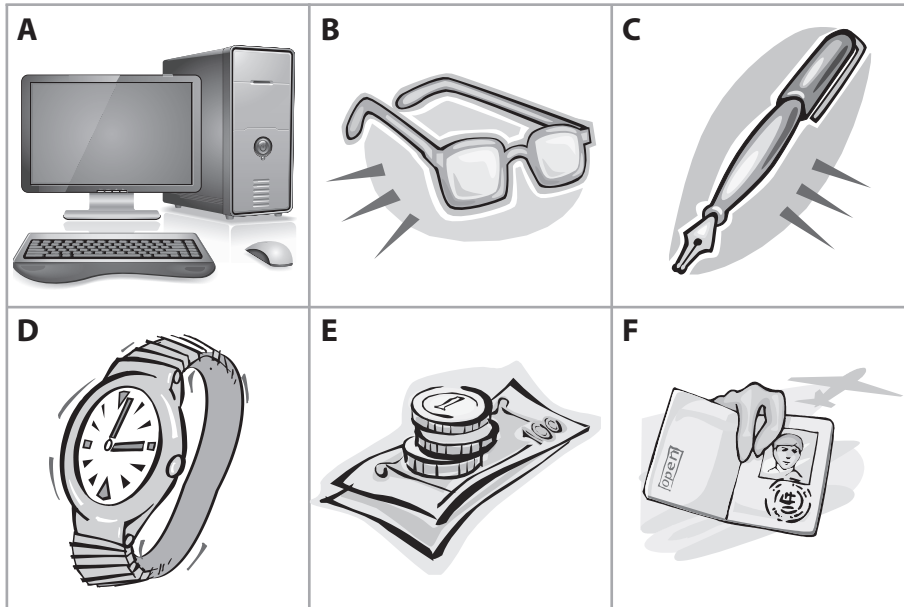

Match the pictures to the correct items.

Put a cross ☒ in the correct box.

	A	B	C	D	E	F
Example: 眼镜	☒	☒	☒	☒	☒	☒
(i) 钱	☒	☒	☒	☒	☒	☒
(ii) 手表	☒	☒	☒	☒	☒	☒
(iii) 护照	☒	☒	☒	☒	☒	☒
(iv) 笔	☒	☒	☒	☒	☒	☒

(Total for Question 1 = 4 marks)

DO NOT WRITE IN THIS AREA

DO NOT WRITE IN THIS AREA

DO NOT WRITE IN THIS AREA



SIMPLIFIED CHARACTERS

Weather

2 A group of friends describe their plans for different weather conditions.

A hot	B raining	C cloudy
D snowing	E windy	F cold

Match the statements with the correct weather conditions.

Put a cross ☒ in the correct box.

	A	B	C	D	E	F
Example: 今天很冷，我要穿毛衣。	<input type="checkbox"/>	<input type="checkbox"/>	<input type="checkbox"/>	<input type="checkbox"/>	<input type="checkbox"/>	<input checked="" type="checkbox"/>
(i) 冬天下大雪，我要去滑雪。	<input type="checkbox"/>	<input type="checkbox"/>	<input type="checkbox"/>	<input type="checkbox"/>	<input type="checkbox"/>	<input type="checkbox"/>
(ii) 夏天很热，我要去游泳。	<input type="checkbox"/>	<input type="checkbox"/>	<input type="checkbox"/>	<input type="checkbox"/>	<input type="checkbox"/>	<input type="checkbox"/>
(iii) 秋天风大，我要去放风筝。	<input type="checkbox"/>	<input type="checkbox"/>	<input type="checkbox"/>	<input type="checkbox"/>	<input type="checkbox"/>	<input type="checkbox"/>
(iv) 春天多雨，我要穿雨衣。	<input type="checkbox"/>	<input type="checkbox"/>	<input type="checkbox"/>	<input type="checkbox"/>	<input type="checkbox"/>	<input type="checkbox"/>

(Total for Question 2 = 4 marks)

DO NOT WRITE IN THIS AREA



SIMPLIFIED CHARACTERS

Places to go

3 Where should each person go?

- A 美美要买一份英文报纸。
- B 大伟想和家人一起去看足球比赛。
- C 王勇想买一个照相机。
- D 明明要买火车票去北京。
- E 丽丽想和同学一起去看国画展览。
- F 马田想买一杯咖啡。

Match the correct letter to the location by putting a in the correct box.

	A	B	C	D	E	F
Example: department store	<input checked="" type="checkbox"/>	<input checked="" type="checkbox"/>	<input checked="" type="checkbox"/>	<input checked="" type="checkbox"/>	<input checked="" type="checkbox"/>	<input checked="" type="checkbox"/>
(i) newsagent	<input type="checkbox"/>	<input type="checkbox"/>	<input type="checkbox"/>	<input type="checkbox"/>	<input type="checkbox"/>	<input type="checkbox"/>
(ii) coffee shop	<input type="checkbox"/>	<input type="checkbox"/>	<input type="checkbox"/>	<input type="checkbox"/>	<input type="checkbox"/>	<input type="checkbox"/>
(iii) ticket office	<input type="checkbox"/>	<input type="checkbox"/>	<input type="checkbox"/>	<input type="checkbox"/>	<input type="checkbox"/>	<input type="checkbox"/>
(iv) art gallery	<input type="checkbox"/>	<input type="checkbox"/>	<input type="checkbox"/>	<input type="checkbox"/>	<input type="checkbox"/>	<input type="checkbox"/>

(Total for Question 3 = 4 marks)

DO NOT WRITE IN THIS AREA

DO NOT WRITE IN THIS AREA

DO NOT WRITE IN THIS AREA



DO NOT WRITE IN THIS AREA

DO NOT WRITE IN THIS AREA

DO NOT WRITE IN THIS AREA

BLANK PAGE



P 5 7 7 4 6 A 0 2 1 3 2

SIMPLIFIED CHARACTERS

My work

4 The following passage describes my daily routine and future plans.

每天早上我七点起床，去打太极拳，八点吃早餐。我喜欢喝牛奶、吃鸡蛋和水果。八点半，我坐地铁去博物馆上班。我在博物馆工作了四年。现在我想在银行工作，当银行经理。

DO NOT WRITE IN THIS AREA

DO NOT WRITE IN THIS AREA

DO NOT WRITE IN THIS AREA

Put a cross ☒ in the correct box.

Example: What time do I get up?

<input checked="" type="checkbox"/>	A 7.00am
<input type="checkbox"/>	B 7.30am
<input type="checkbox"/>	C 8.00am

(i) What do I like to drink with my breakfast?

<input type="checkbox"/>	A water
<input type="checkbox"/>	B milk
<input type="checkbox"/>	C tea

(ii) How do I travel to work?

<input type="checkbox"/>	A bicycle
<input type="checkbox"/>	B car
<input type="checkbox"/>	C underground



SIMPLIFIED CHARACTERS

(iii) Where do I work?

<input type="checkbox"/>	A museum
<input type="checkbox"/>	B school
<input type="checkbox"/>	C shopping centre

(iv) What job would I like to do?

<input type="checkbox"/>	A bank manager
<input type="checkbox"/>	B sports teacher
<input type="checkbox"/>	C scientist

(Total for Question 4 = 4 marks)

DO NOT WRITE IN THIS AREA

DO NOT WRITE IN THIS AREA

DO NOT WRITE IN THIS AREA



SIMPLIFIED CHARACTERS

Favourite pastimes

5 A group of friends describe what they like to do in their free time.

- A 大勇: 我喜欢看杂志。
B 马田: 我喜欢玩电子游戏。
C 美美: 我喜欢在电影院看电影。
D 东东: 我喜欢在公园打篮球。
E 丽丽: 我喜欢上网听音乐。

Match the item to the person.

Put a cross ☒ in the correct box.

	A	B	C	D	E
(i) play electronic games	<input type="checkbox"/>	<input type="checkbox"/>	<input type="checkbox"/>	<input type="checkbox"/>	<input type="checkbox"/>
(ii) listen to music	<input type="checkbox"/>	<input type="checkbox"/>	<input type="checkbox"/>	<input type="checkbox"/>	<input type="checkbox"/>
(iii) play basketball	<input type="checkbox"/>	<input type="checkbox"/>	<input type="checkbox"/>	<input type="checkbox"/>	<input type="checkbox"/>
(iv) watch films	<input type="checkbox"/>	<input type="checkbox"/>	<input type="checkbox"/>	<input type="checkbox"/>	<input type="checkbox"/>

(Total for Question 5 = 4 marks)



SIMPLIFIED CHARACTERS

Weekend

6 What does my family do at the weekend?

- A 哥哥在图书馆看书。
- B 妹妹在床上睡觉。
- C 弟弟在花园里踢足球。
- D 姐姐在书房里写电子邮件。
- E 爸爸在厨房做饭。
- F 妈妈在学习开车。

Write the correct letter in each box.

Example: learning to drive	F
(i) cooking	
(ii) reading	
(iii) playing football	
(iv) sleeping	

(Total for Question 6 = 4 marks)

DO NOT WRITE IN THIS AREA

DO NOT WRITE IN THIS AREA

DO NOT WRITE IN THIS AREA



SIMPLIFIED CHARACTERS

Lili and Anna

7 The following passage is about Lili and Anna.

Read the text and write the correct letter to complete the sentences.

上个月，丽丽和安娜开始上中学，每天都要骑自行车去上学。丽丽有一辆蓝色的自行车，安娜的是红色的。

每个星期六，丽丽骑自行车到美术馆学习画画。但是，安娜喜欢到河边去跑步。

星期天晚上，丽丽喜欢去跳舞。安娜喜欢和朋友去唱歌。

A	B	C	D	E	F
cycling	jogging	walking	dancing	painting	singing

Write the correct letter in the box.

Example: Anna and Lili get to school by...	A
(i) Every Saturday Lili studies...	
(ii) By the river, Anna likes...	
(iii) On Sunday evening Lili likes...	
(iv) Anna and her friends like to go...	

(Total for Question 7 = 4 marks)



SIMPLIFIED CHARACTERS

Occupations

8 A group of friends are describing their occupations.

- A 我是护士，在医院工作。
- B 我是工程师，在工厂工作。
- C 我是老师，在小学工作。
- D 我是司机，在公共汽车公司工作。
- E 我是运动员，打网球。
- F 我是售货员，在书店工作。

Write the correct letter in each box to match the occupations to the people.

Example: sportsman	E
(i) engineer	
(ii) nurse	
(iii) bus driver	
(iv) teacher	

(Total for Question 8 = 4 marks)

DO NOT WRITE IN THIS AREA

DO NOT WRITE IN THIS AREA

DO NOT WRITE IN THIS AREA



SIMPLIFIED CHARACTERS

In a house

9 Here are some items that can be found in a house.

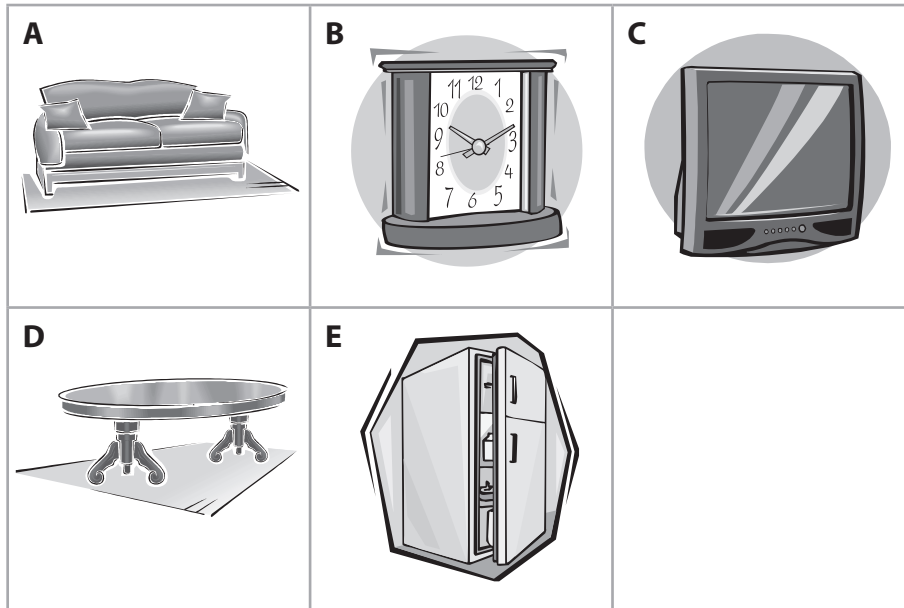

Match the pictures to the correct items.

Put a cross ☒ in the correct box.

	A	B	C	D	E
(i) 沙发	<input type="checkbox"/>	<input type="checkbox"/>	<input type="checkbox"/>	<input type="checkbox"/>	<input type="checkbox"/>
(ii) 电视	<input type="checkbox"/>	<input type="checkbox"/>	<input type="checkbox"/>	<input type="checkbox"/>	<input type="checkbox"/>
(iii) 桌子	<input type="checkbox"/>	<input type="checkbox"/>	<input type="checkbox"/>	<input type="checkbox"/>	<input type="checkbox"/>
(iv) 钟	<input type="checkbox"/>	<input type="checkbox"/>	<input type="checkbox"/>	<input type="checkbox"/>	<input type="checkbox"/>

(Total for Question 9 = 4 marks)

DO NOT WRITE IN THIS AREA

DO NOT WRITE IN THIS AREA

DO NOT WRITE IN THIS AREA



SIMPLIFIED CHARACTERS

A visit

10 This is a story about Ma Tian.

上个星期，马田去看他的朋友，他朋友住在山上。山上有很多黄色的花儿。他有很多宠物，有小狗、小猫、马和小牛。

Answer the following questions **in English**.

(a) Who did Ma Tian go to visit?

(1)

(b) Where is this person's house?

(1)

(c) What colour are the flowers?

(1)

(d) What pets does he have? Give **one** detail.

(1)

(Total for Question 10 = 4 marks)

TOTAL FOR PAPER: 40 MARKS

DO NOT WRITE IN THIS AREA



DO NOT WRITE IN THIS AREA

DO NOT WRITE IN THIS AREA

DO NOT WRITE IN THIS AREA

BLANK PAGE



DO NOT WRITE IN THIS AREA

DO NOT WRITE IN THIS AREA

DO NOT WRITE IN THIS AREA

BLANK PAGE



P 5 7 7 4 6 A 0 3 1 3 2

DO NOT WRITE IN THIS AREA

DO NOT WRITE IN THIS AREA

DO NOT WRITE IN THIS AREA

BLANK PAGE

Images used within this paper may be from www.clipart.com.

