

**Pearson BTEC Level 3 Nationals Extended Certificate,
Foundation Diploma, Diploma, Extended Diploma**

Monday 30 November 2020

Paper Reference **31646H**

Animal Management

Unit 3: Animal Welfare and Ethics

Part A

You do not need any other materials.

Instructions

- **Part A** contains material for the completion of the preparatory work for the set task.
- **Part A** may be given to learners as soon as it is received so that learners can start the preparatory period in advance of the supervised assessment period.
- **Part A** is specific to each series and this material must only be issued to learners who have been entered to undertake the task in the relevant series.
- **Part B** materials for the set task will be issued prior to the start of the supervised assessment period according to the guidance in the specification.

Turn over ►

W67720A

©2020 Pearson Education Ltd.

1/1/1/1/1



Pearson

Instructions to Teachers/Tutors

Centres should refer to the BTEC Nationals Instructions for Conducting External Assessments (ICEA) document for full information on the correct conduct of monitored and formally supervised assessment. See Pearson website for details.

This set task has a preparatory period. **Part A** sets out how learners should prepare for the completion of the task under supervised conditions.

Part B contains unseen material and is issued to learners at the start of the formal supervised assessment session specified by Pearson.

For **Part A**, learners should be monitored over **three scheduled hours** provided by the centre to read **Part A**, carry out research and compile notes. During this time they may only have access to research materials including books, journals, the internet and notes from prior learning. Learners must work independently and must not be given guidance or feedback on the completion of the preparatory work. Learners must not prepare potential responses, and only notes produced in monitored sessions may be used during the formal assessment. Learners may produce up to **two sides** of A4 notes, which should be handwritten or typed in 12pt font. Notes should be short, bullet-point style information, and cannot contain long narrative pieces of text.

Learner notes produced under monitored conditions must be checked by teachers/tutors to ensure that they comply with the limitations.

Learner notes should be retained by the centre between the monitored sessions and the formal supervised assessment.

Learner notes should be retained by the centre after the completion of the assessment and may be requested by Pearson.

Instructions for Learners

Read the set task information carefully.

Part A contains the information you need to prepare for the **Part B** set task.

You will be given **three hours** of monitored preparation. Your teacher/tutor will advise you of the scheduled sessions for this work.

During this session you will prepare summary notes to support you during the supervised assessment. Your notes should:

- be individually and independently prepared by you
- contain a maximum of two sides of A4, either handwritten or typed in a 12pt font
- use short, bullet-point style information, and cannot contain long narrative pieces of text.

Your notes will be checked by your centre and retained after the completion of the formal supervised assessment.

You must work independently and must not share your work with other learners.

Your teacher/tutor cannot give you feedback during the preparation period.

Set Task Brief

You are required to carry out research into industry standards and practice in relation to:

Valeshire Pets – a pet shop selling small mammals, birds, reptiles and fish.

During the recent licensing inspection by the local authority, issues have been identified that require attention.

In preparation for the next licensing inspection you have been asked to conduct a welfare appraisal and produce an action plan for Valeshire Pets.

Pearson BTEC Level 3 Nationals Extended Certificate,
Foundation Diploma, Diploma, Extended Diploma

January 2021

Supervised hours: 3 hours

Paper Reference **31646H**

Animal Management

Unit 3: Animal Welfare and Ethics

Stimulus Material Booklet

Do not return this Booklet with the question paper.

Instructions

- This booklet contains the stimulus material for use in **Part B** set task.
- This **Stimulus Material Booklet** is specific to each series and this material must only be issued to learners who have been entered to undertake the task in the relevant series.
- This booklet should be kept secure until the start of the 3-hour supervised assessment period.

Turn over ►

P67711A

©2021 Pearson Education Ltd.

1/1/1/1/1/1/1





Pearson

Part B Stimulus Material for Activities 1–3

In preparation for the welfare appraisal, the following documentation has been collected for you within this booklet:

1. Valeshire Pets layout
2. Valeshire Pets species list
3. Valeshire Pets staff rota
4. Valeshire Pets sale of animals procedure
5. Valeshire Pets staff qualifications and training
6. Valeshire Pets typical daily plan
7. Hopeville Council guidance for licensing of activities involving selling animals as pets

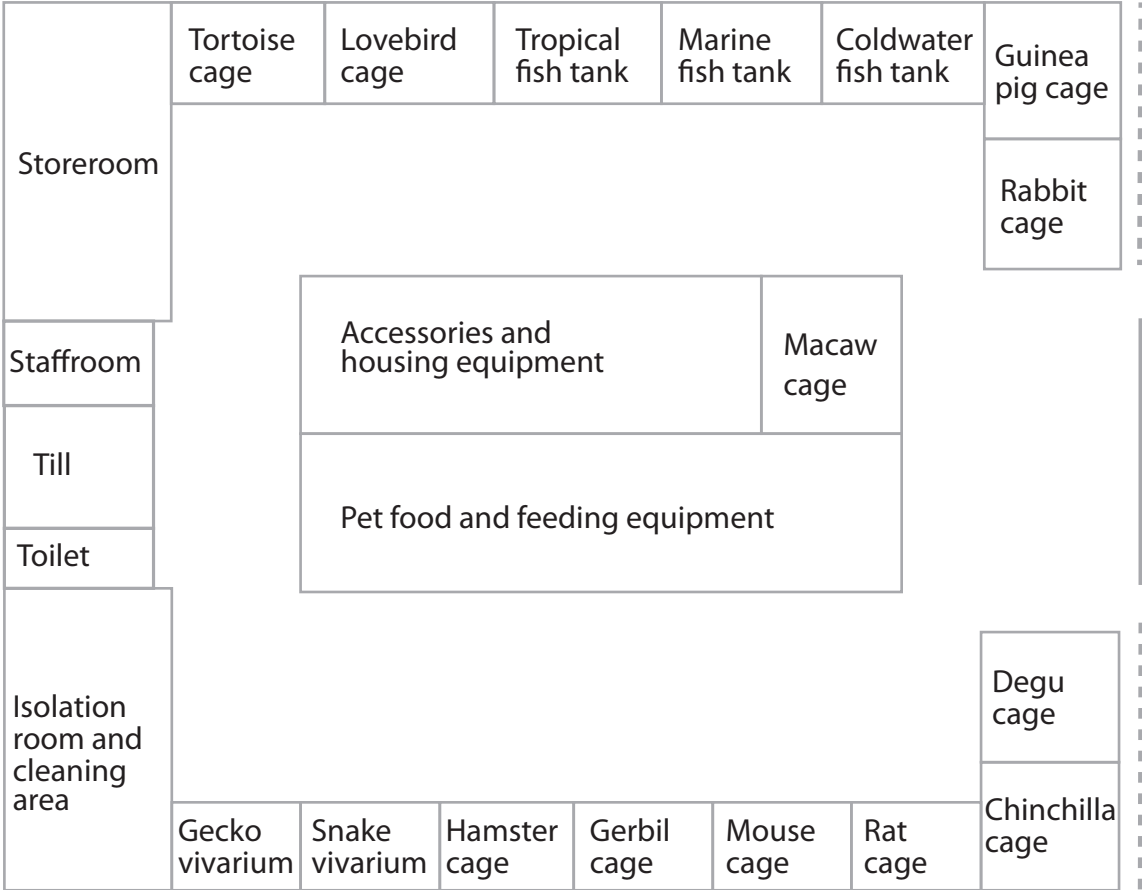
Valeshire Pets layout



Key
 ——— Door
 - - - - Window

Valeshire Pets species list

- 2 male and 2 female geckos
- 2 male corn snakes
- 6 male and 2 female Syrian hamsters
- 1 female gerbil
- 5 male mice
- 1 female rat
- 3 male and 2 female chinchillas
- 2 female degus
- 3 male and 3 female rabbits
- 7 male and 3 female guinea pigs
- 1 male lovebird
- 3 male Hermann's tortoises
- 1 male Scarlet macaw

Valeshire Pets staff rota

Staff members	Mon	Tues	Weds	Thurs	Fri	Sat	Sun
Alex (manager)	✓	✓		✓		✓	Closed no staff
Kim			✓			✓	
Brad						✓	
Lucca	✓		✓	✓	✓		

Valeshire Pets sale of animals procedure

1. All animals must be health checked before they are sold.
2. All animals must be sold with a suitable cage/accommodation.
3. All animals must be sold with the correct food.
4. All animals sold must have their records updated stating the date they were sold.
5. As soon as an animal is sold another must be ordered to make sure stock is always available.
6. All animals should be sold as individuals not in pairs or groups.
7. All customers that are buying fish should be advised of how sensitive fish are, so all sales are final.
8. All customers that are buying hamsters and chinchillas should be advised that they are nocturnal.

Valeshire Pets staff qualifications and training

Staff members	Qualifications	Staff training
Alex (manager)	A level Biology A level Maths Level 2 Animal Care	Feline behaviour online course First aid training
Kim	HNC Environmental Studies	Staff induction training
Brad	Studying at college Level 1 Animal Care	
Lucca	Level 3 Retail and Customer Service	Staff induction training

Valeshire Pets typical daily plan

DAILY PLAN

9AM	HEALTH CHECK ANIMALS
9.30	SHOP OPENS
10AM	STOCK UP SHELVES
10.30	FEED ANIMALS
11AM	GROOM RABBITS + GUINEA PIGS
11-30	GIVE BIRDS, CHINCHILLA'S + DEGLUS BATHS
12 PM	LUNCH
1-30	ALL ANIMALS FULL CLEAN + PARTIAL WATER CHANGE FISH
4PM	HEALTH CHECK + FRESH WATER
5PM	SHOP CLOSES



Hopeville Council guidance for Licensing of Activities Involving Animals selling animals as pets.

1. A copy of the licence must be on the wall.
2. Copies of all animals' records must be filled in daily and kept for three years.
3. There must be an isolation room so any ill and new animals can be kept there.
4. No animal must be sold unless there is a member of staff at the shop with a Level 2 Animal Care qualification.
5. Staff should have animal healthcare guides and policies to follow.
6. All staff caring for animals must have a Level 2 Animal Care qualification.
7. All animal housing must be well constructed, and checked for damage to stop any injury, illness, disease or escape.
8. Accommodation must provide suitable:
 - space, cleanliness, ventilation and temperature
 - noise levels – must not cause animals stress
 - light levels – must be suited to the animals' natural cycle.
9. Animals must be kept in a way that meets their behavioural needs:
 - predator and prey species must be out of sound and smell of each other
 - they must be able to show normal behaviour patterns.
10. All animals must be fed a suitable diet.
11. Water and food bowls must be checked and cleaned daily and disinfected weekly.
12. All animals must have suitable enrichment.
13. All animals in the shop must be able to exercise.



BLANK PAGE



BLANK PAGE



BLANK PAGE



Please check the examination details below before entering your candidate information

Candidate surname	Other names	
Pearson BTEC Level 3 Nationals Extended Certificate, Foundation Diploma, Diploma, Extended Diploma	Centre Number <input style="width: 20px; height: 20px;" type="text"/> <input style="width: 20px; height: 20px;" type="text"/> <input style="width: 20px; height: 20px;" type="text"/> <input style="width: 20px; height: 20px;" type="text"/> <input style="width: 20px; height: 20px;" type="text"/> <input style="width: 20px; height: 20px;" type="text"/>	Learner Registration Number <input style="width: 20px; height: 20px;" type="text"/> <input style="width: 20px; height: 20px;" type="text"/> <input style="width: 20px; height: 20px;" type="text"/> <input style="width: 20px; height: 20px;" type="text"/> <input style="width: 20px; height: 20px;" type="text"/> <input style="width: 20px; height: 20px;" type="text"/> <input style="width: 20px; height: 20px;" type="text"/>
Wednesday 13 January 2021		
Supervised hours: 3 hours	Paper Reference 31646H	
Animal Management Unit 3: Animal Welfare and Ethics Part B		
You must have: Stimulus Material Booklet (enclosed)	Total Marks	

Instructions

- You will need your research notes from **Part A**.
- **Part B** contains material for the completion of the set task under supervised conditions. You will need the information in the separate **Stimulus Material Booklet** (enclosed) to complete the activities in **Part B**.
- Learners will take **Part B** under supervised conditions in a single 3-hour session within the 1-day period timetabled by Pearson.
- **Part B** is specific to each series and this material must only be issued to learners who have been entered to undertake the task in that series.
- **Part B** should be kept securely until the start of the supervised assessment session.
- You are not required to submit your research notes.
- Use **black** ink or ball-point pen.
- Fill in the boxes at the top of this page with your name, centre number and learner registration number.
- Complete **all** activities.
- Answer the activities in the spaces provided
– *there may be more space than you need.*

Information

- The total mark for this paper is 60.
- The marks for **each** question are shown in brackets
– *use this as a guide as to how much time to spend on each question.*

Advice

- Read each question carefully before you start to answer it.
- Try to answer every question.
- Check your answers if you have time at the end.

Turn over ►

P67711A

©2021 Pearson Education Ltd.
1/1/1/1/1/1/1



Instructions to Teachers/Tutors and/or Invigilators

This booklet must be read in conjunction with the unit information in the specification and the *BTEC Nationals Instructions for Conducting External Assessments* (ICEA) document. See the Pearson website for details.

The set task should be carried out under supervised conditions.

Work should be completed in this task booklet. There is a separate **Stimulus Material Booklet**, which should also be given to learners alongside this task booklet.

All learner work must be completed independently before being authenticated and submitted to Pearson by the teacher/tutor and/or invigilator.

Centres are free to arrange the supervised assessment period how they wish provided the three hours for producing final outcomes are under the level of supervision specified, and in accordance with the conduct procedures.

Refer carefully to the instructions in this task booklet and the *BTEC Nationals Instructions for Conducting External Assessments* (ICEA) document to ensure that the assessment is supervised correctly. An authentication statement will be required confirming that learner work has been completed as directed.

Learners must not bring anything into the supervised environment or take anything out without teacher/tutor and/or invigilator approval.

Centres are responsible for putting in place appropriate checks to ensure that only permitted material is introduced into the supervised environment.

Maintaining security

- Supervised assessment areas must only be accessible to the individual learners and to named members of staff.
- Learners can only access their work under supervision.
- Any work learners produce under supervision must be kept securely.

Outcomes for submission

A completed task booklet will need to be submitted by each learner.

A fully completed authentication sheet must be submitted by each learner; the prepared notes do not need to be submitted with the final outcomes to Pearson.

DO NOT WRITE IN THIS AREA

DO NOT WRITE IN THIS AREA

DO NOT WRITE IN THIS AREA

DO NOT WRITE IN THIS AREA

DO NOT WRITE IN THIS AREA

DO NOT WRITE IN THIS AREA



Instructions for Learners

Read the set task information carefully.

Complete all your work in this task booklet.

You must plan your time accordingly and be prepared to submit all the required evidence by the date specified.

You will need to refer to any preparatory work from **Part A**, and the separate **Stimulus Material Booklet**, to complete the set task in **Part B**.

You will complete this set task under supervision and your work will be kept securely during any breaks taken.

You must work independently throughout the supervised assessment period and must not share your work with other learners.

Outcomes for submission

You will need to submit this task booklet on completion of the supervised assessment period.

A fully completed authentication sheet must also be submitted; any prepared notes do not need to be submitted with the final outcomes to Pearson.



Set Task

You must complete ALL the activities in this task booklet.
Activities 1, 2 and 3 are about 'Valeshire Pets'. Activity 4 is about the ethical issues surrounding the use of animals in education.

Activity 1

Write an appraisal report of Valeshire Pets using the additional information provided in the **Stimulus Material Booklet**.

In your report you should address the following:

- quality of care provided at Valeshire Pets in relation to the five welfare needs
- legislative and welfare issues at Valeshire Pets.

(Total for Activity 1 = 20 marks)

Activity 2

To what extent does the information provided in the **Stimulus Material Booklet** allow for a comprehensive appraisal to be conducted?

In your answer you must make reference to additional information that will be needed in order to complete a comprehensive appraisal report.

(Total for Activity 2 = 10 marks)

Activity 3

Produce an action plan for Valeshire Pets to address the issues identified in your appraisal. Your action plan must include:

- actions required in order of priority
- reasons for the actions
- timescales for the actions to be completed.

(Total for Activity 3 = 10 marks)

Activity 4

Explore the ethical issues surrounding the use of animals in education.

(Total for Activity 4 = 20 marks)

TOTAL FOR TASK = 60 MARKS

DO NOT WRITE IN THIS AREA

DO NOT WRITE IN THIS AREA

DO NOT WRITE IN THIS AREA

DO NOT WRITE IN THIS AREA

DO NOT WRITE IN THIS AREA

DO NOT WRITE IN THIS AREA



Part A Set Task Information

You are required to carry out research into industry standards and practice in relation to:

Valeshire Pets – a pet shop selling small mammals, birds, reptiles and fish.

During the recent licensing inspection by the local authority, issues have been identified that require attention.

In preparation for the next licensing inspection you have been asked to conduct a welfare appraisal and produce an action plan for Valeshire Pets.

Part B Set Task Information

You must complete ALL the activities in this task booklet. Activities 1, 2 and 3 are about 'Valeshire Pets'. Activity 4 is about the ethical issues surrounding the use of animals in education.

In preparation for the appraisal, the following documentation has been collected for you:

1. Valeshire Pets layout
2. Valeshire Pets species list
3. Valeshire Pets staff rota
4. Valeshire Pets sale of animals procedure
5. Valeshire Pets staff qualifications and training
6. Valeshire Pets typical daily plan
7. Hopeville Council guidance for licensing of activities involving selling animals as pets.

This documentation can be found in the separate **Stimulus Material Booklet**.

The scenario for Activity 4 can be found on page 16 of this task booklet.



DO NOT WRITE IN THIS AREA

DO NOT WRITE IN THIS AREA

DO NOT WRITE IN THIS AREA

DO NOT WRITE IN THIS AREA

DO NOT WRITE IN THIS AREA

DO NOT WRITE IN THIS AREA

Large writing area with horizontal dotted lines.



Lined writing area with horizontal dashed lines.

DO NOT WRITE IN THIS AREA

DO NOT WRITE IN THIS AREA

DO NOT WRITE IN THIS AREA

DO NOT WRITE IN THIS AREA

DO NOT WRITE IN THIS AREA

DO NOT WRITE IN THIS AREA



DO NOT WRITE IN THIS AREA

DO NOT WRITE IN THIS AREA

DO NOT WRITE IN THIS AREA

DO NOT WRITE IN THIS AREA

DO NOT WRITE IN THIS AREA

DO NOT WRITE IN THIS AREA

Handwriting practice area with 20 horizontal dotted lines.

(Total for Activity 1 = 20 marks)



Activity 2

To what extent does the information provided in the **Stimulus Material Booklet** allow for a comprehensive appraisal to be conducted?

In your answer you must make reference to additional information that will be needed in order to complete a comprehensive appraisal report.

(10)

Area with horizontal dotted lines for writing the answer.

DO NOT WRITE IN THIS AREA

DO NOT WRITE IN THIS AREA

DO NOT WRITE IN THIS AREA

DO NOT WRITE IN THIS AREA

DO NOT WRITE IN THIS AREA

DO NOT WRITE IN THIS AREA



DO NOT WRITE IN THIS AREA

DO NOT WRITE IN THIS AREA

DO NOT WRITE IN THIS AREA

DO NOT WRITE IN THIS AREA

DO NOT WRITE IN THIS AREA

DO NOT WRITE IN THIS AREA

Large writing area with horizontal dotted lines.



Lined writing area for activity response.

DO NOT WRITE IN THIS AREA

DO NOT WRITE IN THIS AREA

DO NOT WRITE IN THIS AREA

DO NOT WRITE IN THIS AREA

DO NOT WRITE IN THIS AREA

DO NOT WRITE IN THIS AREA

(Total for Activity 2 = 10 marks)



Lined writing area with horizontal dashed lines.

DO NOT WRITE IN THIS AREA

DO NOT WRITE IN THIS AREA

DO NOT WRITE IN THIS AREA

DO NOT WRITE IN THIS AREA

DO NOT WRITE IN THIS AREA

DO NOT WRITE IN THIS AREA



DO NOT WRITE IN THIS AREA

DO NOT WRITE IN THIS AREA

DO NOT WRITE IN THIS AREA

DO NOT WRITE IN THIS AREA

DO NOT WRITE IN THIS AREA

DO NOT WRITE IN THIS AREA

Handwriting practice area with 20 horizontal dotted lines.

(Total for Activity 3 = 10 marks)



Activity 4

Scenario

Many pet shops now offer educational workshops showing how to look after pets. Animals are also used for teaching purposes in primary schools. These may be classroom pets or animals being brought into schools.

Explore the ethical issues surrounding the use of animals in education.

(20)

Area with horizontal dotted lines for writing.

DO NOT WRITE IN THIS AREA

DO NOT WRITE IN THIS AREA

DO NOT WRITE IN THIS AREA

DO NOT WRITE IN THIS AREA

DO NOT WRITE IN THIS AREA

DO NOT WRITE IN THIS AREA



DO NOT WRITE IN THIS AREA

DO NOT WRITE IN THIS AREA

DO NOT WRITE IN THIS AREA

DO NOT WRITE IN THIS AREA

DO NOT WRITE IN THIS AREA

DO NOT WRITE IN THIS AREA

Large writing area with horizontal dotted lines.



Handwriting practice area with 20 horizontal dotted lines.

DO NOT WRITE IN THIS AREA

DO NOT WRITE IN THIS AREA

DO NOT WRITE IN THIS AREA

DO NOT WRITE IN THIS AREA

DO NOT WRITE IN THIS AREA

DO NOT WRITE IN THIS AREA



DO NOT WRITE IN THIS AREA

DO NOT WRITE IN THIS AREA

DO NOT WRITE IN THIS AREA

DO NOT WRITE IN THIS AREA

DO NOT WRITE IN THIS AREA

DO NOT WRITE IN THIS AREA

Handwriting practice area with 20 horizontal dotted lines.

(Total for Activity 4 = 20 marks)

TOTAL FOR TASK = 60 MARKS





DO NOT WRITE IN THIS AREA

DO NOT WRITE IN THIS AREA

DO NOT WRITE IN THIS AREA

DO NOT WRITE IN THIS AREA

DO NOT WRITE IN THIS AREA

DO NOT WRITE IN THIS AREA

BLANK PAGE

