

UNIVERSITY OF CAMBRIDGE INTERNATIONAL EXAMINATIONS  
General Certificate of Education  
Advanced Subsidiary Level and Advanced Level

**GEOGRAPHY**

**9696/01**

Paper 1 Core Geography

October/November 2004

INSERT

**3 hours**

**READ THESE INSTRUCTIONS FIRST**

This insert contains all the Figures referred to in the questions.

If you answer Question 9 detach Fig. 6 from this Insert and attach it to your answer booklet/answer paper.

This document consists of 7 printed pages and 1 blank page.



Fig.1 for Question 1

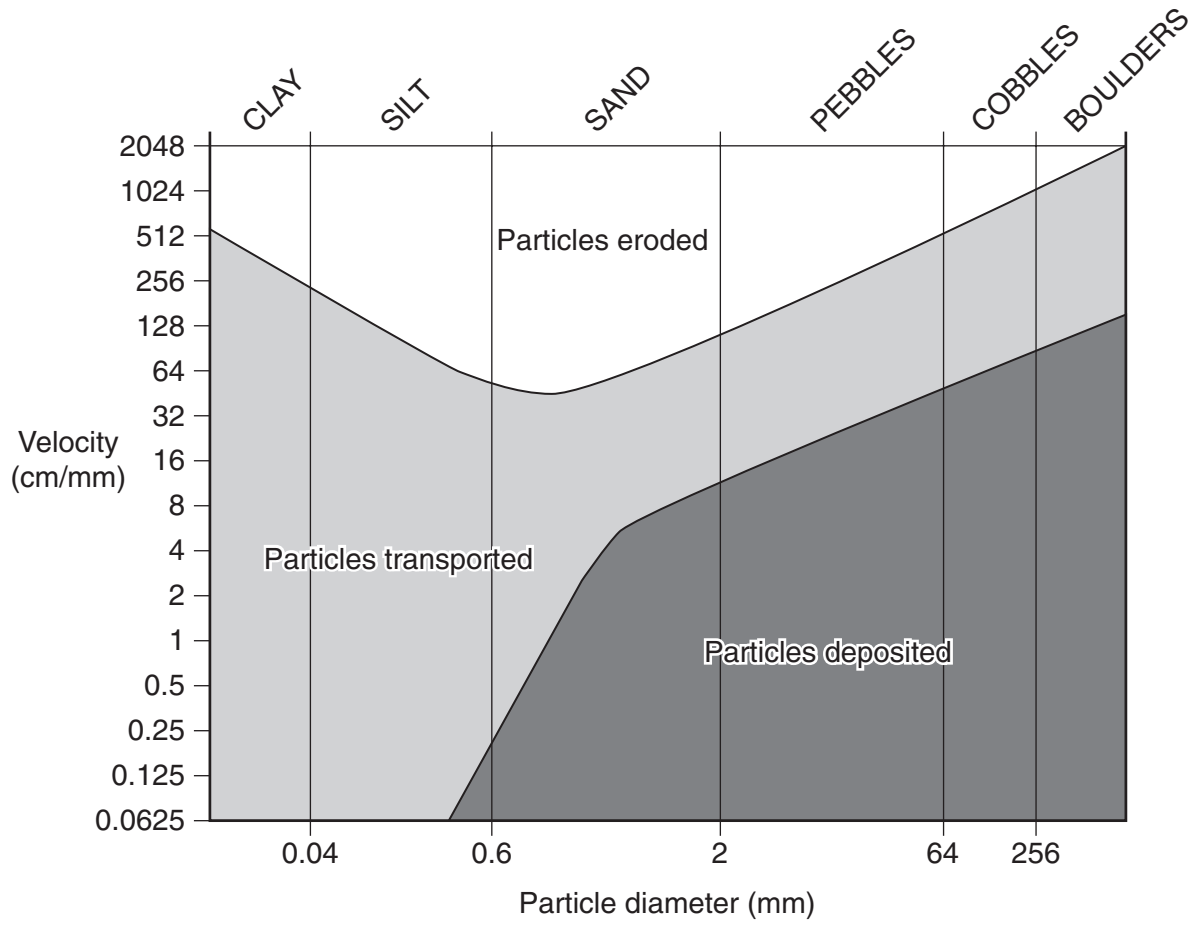

Fig. 2 for Question 2

Mean (average) temperatures (°C) in July

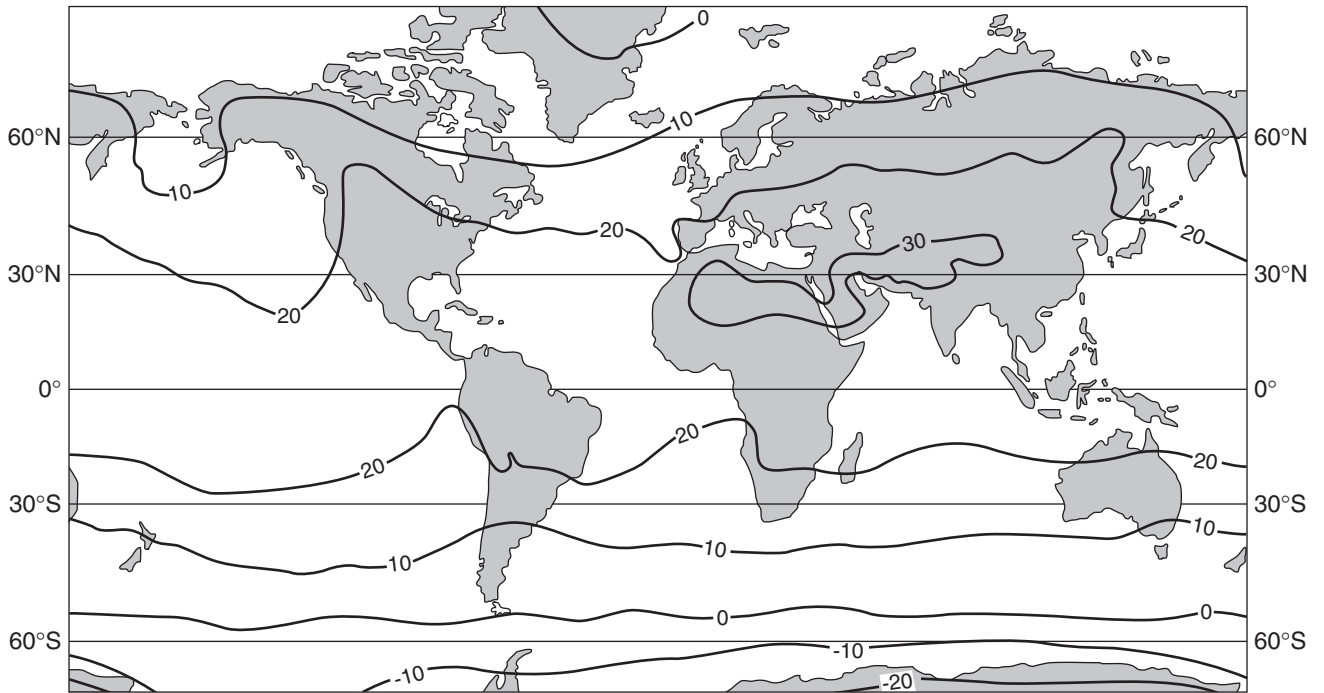

Fig. 3 for Question 3

Average rate of physical weathering in relation to average annual precipitation and temperature

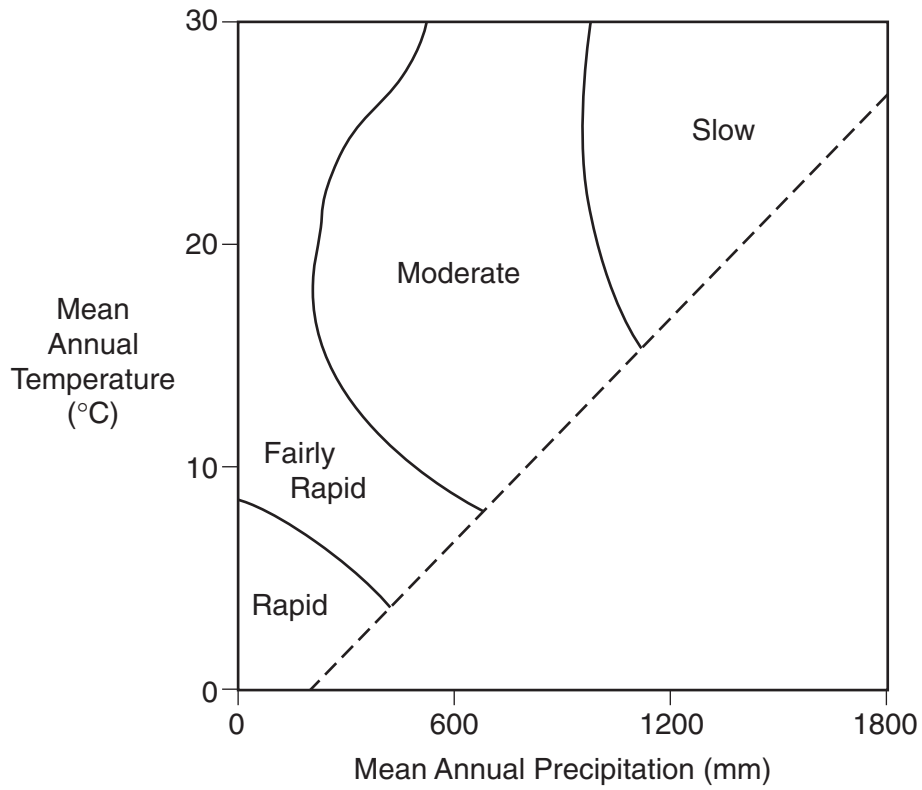

Fig. 4 for Question 4

Changing fertility and percentages of women in the work force in South America

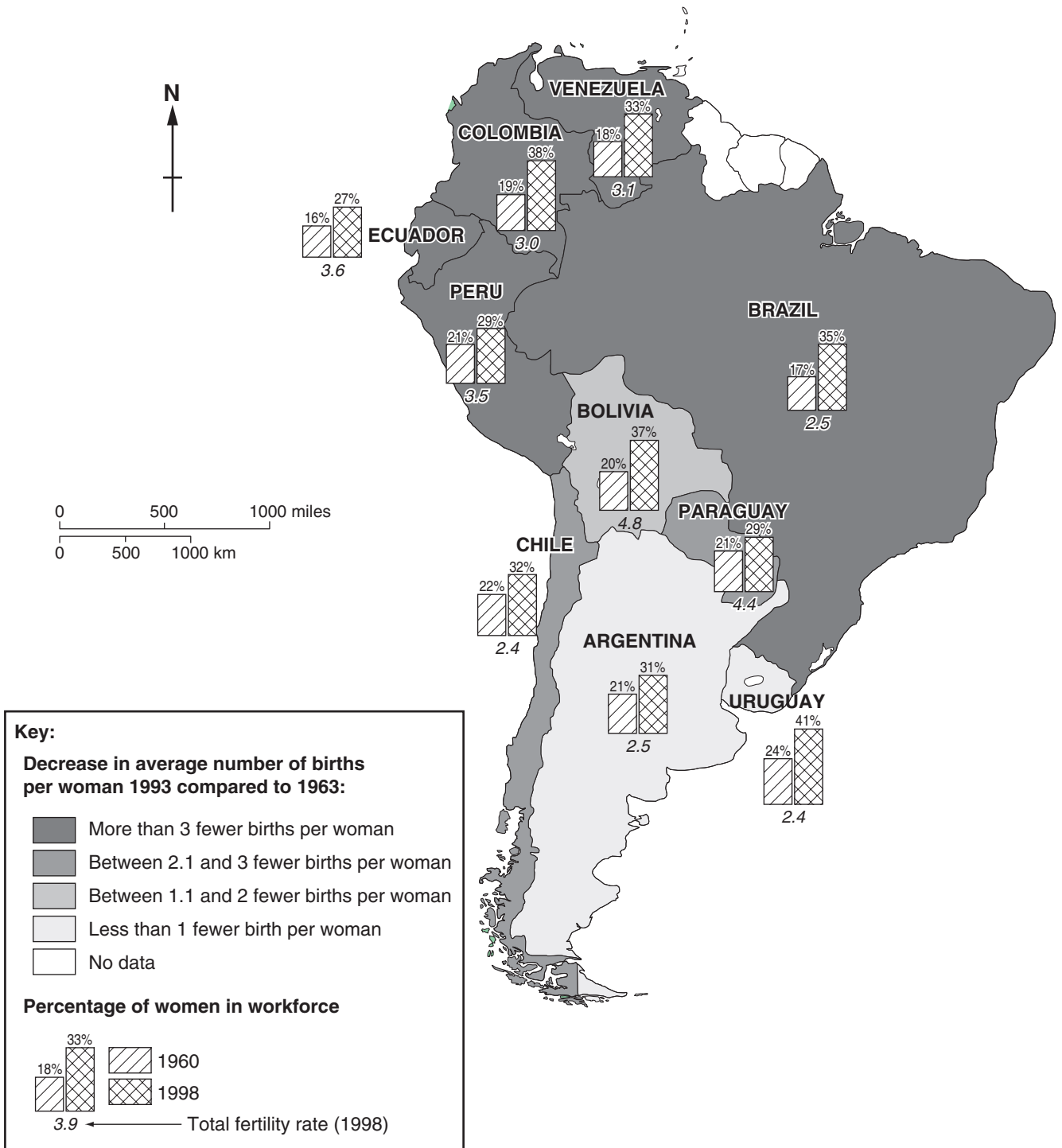
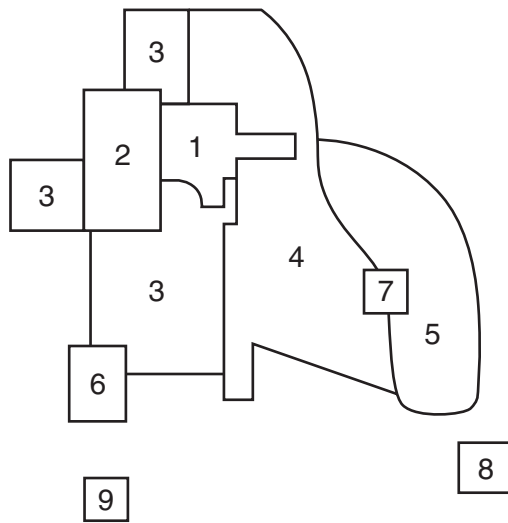

Fig. 5 for Question 5

## The multiple nuclei model of urban structure

**Key:**

- 1 Central business district
- 2 Wholesale light manufacturing
- 3 Low income residential
- 4 Medium income residential
- 5 High income residential
- 6 Heavy manufacturing
- 7 Outlying business district
- 8 Residential suburb
- 9 Industrial suburb

Centre Number	Candidate Number	Name
---------------	------------------	------

Fig. 6 for Question 9

## The demographic transition model

