

**ADVANCED GCE
CLASSICAL CIVILISATION (JACT)**

Archaeology 3

MONDAY 9 JUNE 2008

2753

Afternoon
Time: 1 hour 30 minutes

Additional materials (enclosed): None

Additional materials (required):
Answer Booklet (8 page)



INSTRUCTIONS TO CANDIDATES

- Write your name in capital letters, your Centre Number and Candidate Number in the spaces provided on the Answer Booklet.
- Read each question carefully and make sure you know what you have to do before starting your answer.
- You must answer **one** question from Section A and **one** question from Section B.
- Start your answer to each question on a new page.
- Use an 8 page answer booklet followed by a 4 page booklet if extra paper is required.

INFORMATION FOR CANDIDATES

- The number of marks for each question is given in brackets [] at the end of each question or part question.
- All questions are worth 50 marks in total including 5 marks for quality of written communication.
- The total number of marks for this paper is **100**.
- In this paper you are encouraged to use sketches, diagrams etc., where appropriate, to illustrate your answers.

This document consists of **4** printed pages.

Section A

Answer **one** question from this section.

A1 Study the illustration below and answer the questions that follow.

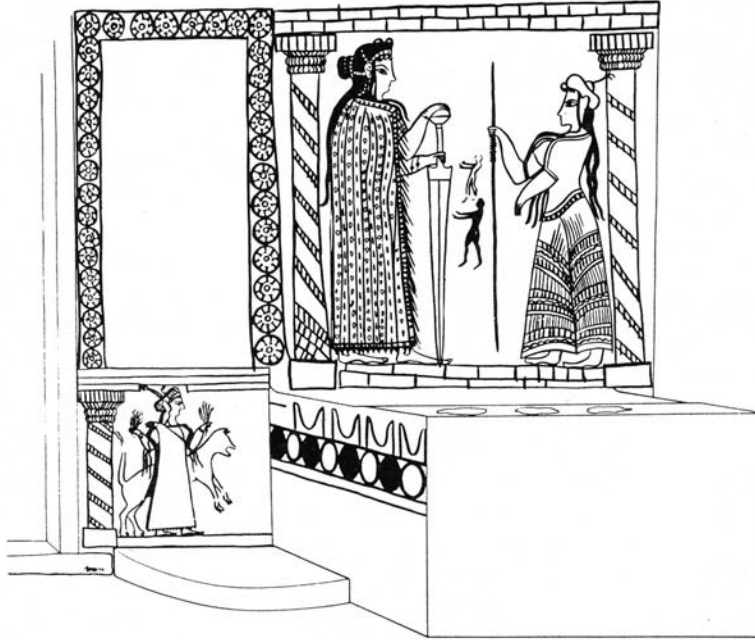

- (a) Identify and describe the illustration shown above. Where was it found and what date has been assigned to it? [10]
- (b) Explain what this illustration shows us about Mycenaean religion. To what extent is this backed up by other evidence? [15]
- (c) How useful is art in teaching us about aspects of ancient daily life, apart from religion? In your answer you should refer to specific pieces of art, including Mycenaean art. [20]

[Quality of Written Communication: 5 marks]

[Total: 50 marks]

A2 Study the plan below and answer the questions that follow.

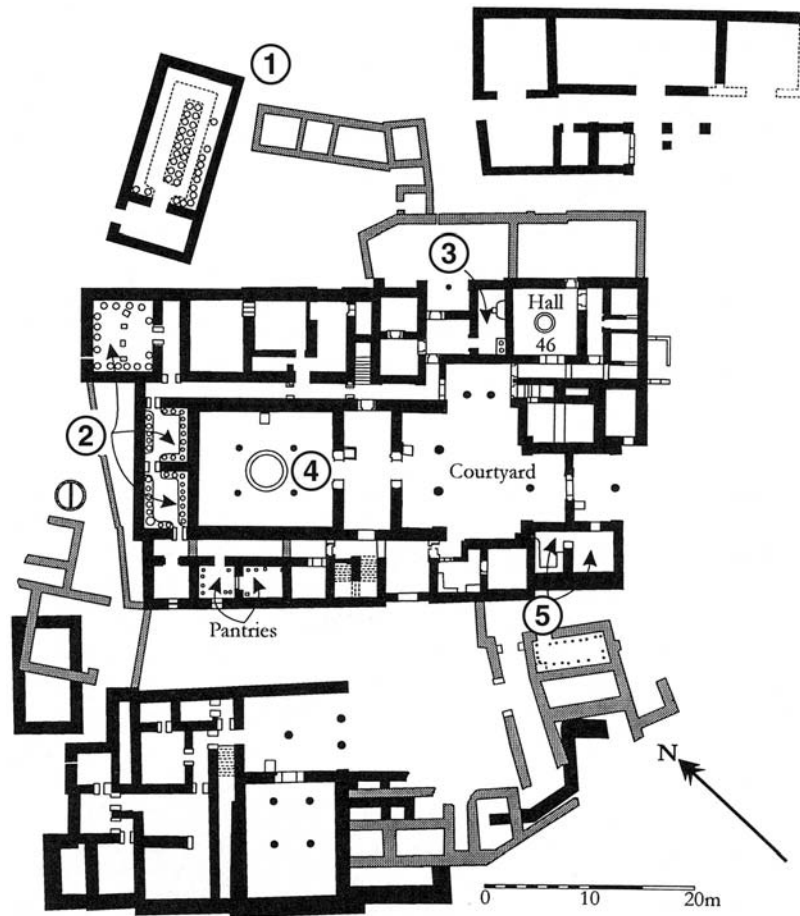

- (a) (i) Identify the site shown above and state precisely where in Greece it is located.
- (ii) Identify the areas on the diagram labelled 1–5. [10]
- (b) How useful have the buildings and other structures at this site been for students of Mycenaean archaeology? [15]
- (c) How is surviving written evidence from the ancient past useful to archaeologists today? In your answer you should refer to evidence from the ancient world, including Mycenaean Greece. [20]

[Quality of Written Communication: 5 marks]
[Total: 50 marks]

Section B

Answer **one** question from this section.

Start your answer on a new page.

- B3** 'Mycenae is enormously useful to archaeologists, while Tiryns is just a big heap of stones.' Explain to what extent you agree with this statement. [50]
- B4** 'There is nothing an archaeologist likes more than finding a corpse.' Including reference to Mycenaean Greece, explain how graves can be useful to an archaeologist. [50]
- B5** 'In many cases, only archaeologists can work out how and why an ancient civilisation came to an end.' Including reference to Mycenaean Greece, explain to what extent you agree with this statement. [50]

Copyright Acknowledgements:

A1 and A2 illustrations From K. A. Wardle and D. Wardle, *The Mycenaean World*, pp. 20, 111, Bristol Classical Press, 1998. Reproduced by permission of K. A. Wardle.

Permission to reproduce items where third-party owned material protected by copyright is included has been sought and cleared where possible. Every reasonable effort has been made by the publisher (OCR) to trace copyright holders, but if any items requiring clearance have unwittingly been included, the publisher will be pleased to make amends at the earliest possible opportunity.

OCR is part of the Cambridge Assessment Group. Cambridge Assessment is the brand name of University of Cambridge Local Examinations Syndicate (UCLES), which is itself a department of the University of Cambridge.