



General Certificate of Education
Advanced Subsidiary Examination
June 2013

Classical Civilisation

CIV2E

Unit 2E Roman Architecture and Town Planning

Wednesday 22 May 2013 9.00 am to 10.30 am

For this paper you must have:

- an AQA 12-page answer book.

Time allowed

- 1 hour 30 minutes

Instructions

- Use black ink or black ball-point pen.
- Write the information required on the front of your answer book. The **Paper Reference** is CIV2E.
- Answer questions from **two** options.
Choose **one** option from Section 1 and **one** option from Section 2.
Answer **all** questions from the options you have chosen.
- Do all rough work in your answer book. Cross through any work that you do not want to be marked.
Do **not** tear out any part of the book. All work must be handed in.
- If you use more than one book, check that you have written the information required on each book.

Information

- The marks for questions are shown in brackets.
- The maximum mark for this paper is 65.
- You will be marked on your ability to:
 - use good English
 - organise information clearly
 - use specialist vocabulary where appropriate.

Section 1

Choose **either** Option A **or** Option B.

Answer **all** questions from the option you have chosen.

You may use drawings and diagrams in your answers.

EITHER

Option A

Study the plan below and answer Questions 01 to 04 which follow. The plan shows the Stabian Baths in Pompeii.

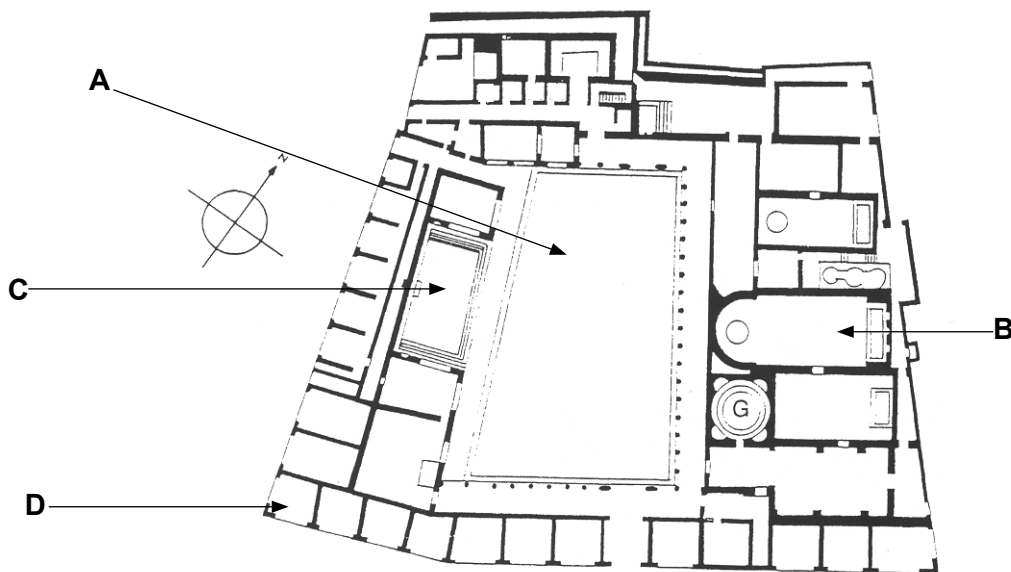

0 1 What was the **original** source of water for the Stabian Baths? (1 mark)

0 2 Identify the areas marked **A, B, C** and **D** on the plan. (4 marks)

0 3 How well did the Stabian Baths suit the needs of the inhabitants of Pompeii? (10 marks)

0 4 'The Baths of Caracalla were as much a political monument as a bathing complex.'

How far do you agree? Give reasons for your answer.

You might include discussion of:

- reasons why the Baths of Caracalla were built
- the scale of the project
- materials and techniques of construction used
- external and internal decoration
- facilities provided.

(20 marks)

OR

Option B

Study the photograph below and answer Questions 05 to 09 which follow. The photograph shows the Capitulum at Pompeii.



0 5 At about what date was the Capitulum at Pompeii **first** built? (1 mark)

0 6 To which **three** deities was the Capitulum dedicated? (3 marks)

0 7 To which order of architecture did the columns shown in the photograph belong? (1 mark)

0 8 How imposing were the appearance of the Capitulum at Pompeii **and** its position in the forum? (10 marks)

0 9 'Temples outside Rome all looked the same as each other.'

How far do you agree? Give reasons for your answer and refer to specific examples of temples from outside Rome.

You might include discussion of:

- the Temple of Apollo at Pompeii and temples at Cosa, Ostia and Nimes
- their dates
- their position and layout
- their external and internal appearance
- materials and techniques of construction used.

(20 marks)

Turn over ▶

Section 2

Choose **either** Option C **or** Option D and answer the question below.

You may use drawings and diagrams in your answer.

EITHER**Option C**

1	0
---	---

How effective were the theatres and amphitheatres you have studied **both** in providing entertainment **and** in demonstrating the political power of the people who commissioned them? Give reasons for your answer and refer to at least **two** theatres and **two** amphitheatres.

You might include discussion of:

- who commissioned each building, when and why
- position and size of each
- materials used and attention to external and internal appearance
- comfort, safety and facilities provided.

(30 marks)

OR**Option D**

1	1
---	---

'Despite the very different natures of Pompeii and Ostia, the development of their town plans **and** the range of public buildings were very similar.'

To what extent do you agree with this statement? Give reasons for your answer and refer to specific similarities and differences between the two.

You might include discussion of:

- each town's historical background
- the development of street plans
- how commercial, political and religious needs were met
- how population growth was managed
- water supply
- provision of leisure facilities.

(30 marks)

END OF QUESTIONS

ACKNOWLEDGEMENT OF COPYRIGHT-HOLDERS AND PUBLISHERS

Option B photograph © A Potter.

Copyright © 2013 AQA and its licensors. All rights reserved.