



General Certificate of Education
Advanced Subsidiary Examination
June 2010

Classical Civilisation

CIV2E

Unit 2E Roman Architecture and Town Planning

Tuesday 25 May 2010 1.30 pm to 3.00 pm

For this paper you must have:

- an AQA 16-page answer book.

Time allowed

- 1 hour 30 minutes

Instructions

- Use black ink or black ball-point pen. Do **not** use pencil or gel pen.
- Write the information required on the front of your answer book.
The **Paper Reference** for this paper is **C I V 2 E**.
- Answer questions from **two** options.
Choose **one** option from Section One and **one** option from Section Two.
Answer **all** questions from the options you have chosen.
- Use both sides of the paper.
- Write the question number in the boxes provided in the left-hand margin at the start of each question, e.g. **0 1**.
- Leave a space between each answer.
- Do all rough work in your answer book. Cross through any work that you do not want to be marked.
Do **not** tear out any part of the book. All work must be handed in.
- If you use more than one book, check that you have written the information required on each book.

Information

- The marks for questions are shown in brackets.
- The maximum mark for this paper is 65.
- You will be marked on your ability to:
 - use good English
 - organise information clearly
 - use specialist vocabulary where appropriate.

Section One

Choose **either** Option A **or** Option B.

Answer **all** questions from the option you have chosen.

You may use drawings and diagrams to illustrate your answer.

EITHER

Option A

Study the plan below and answer Questions 01 to 04 which follow.

Plan A House of the Menander, Pompeii in about 50 AD

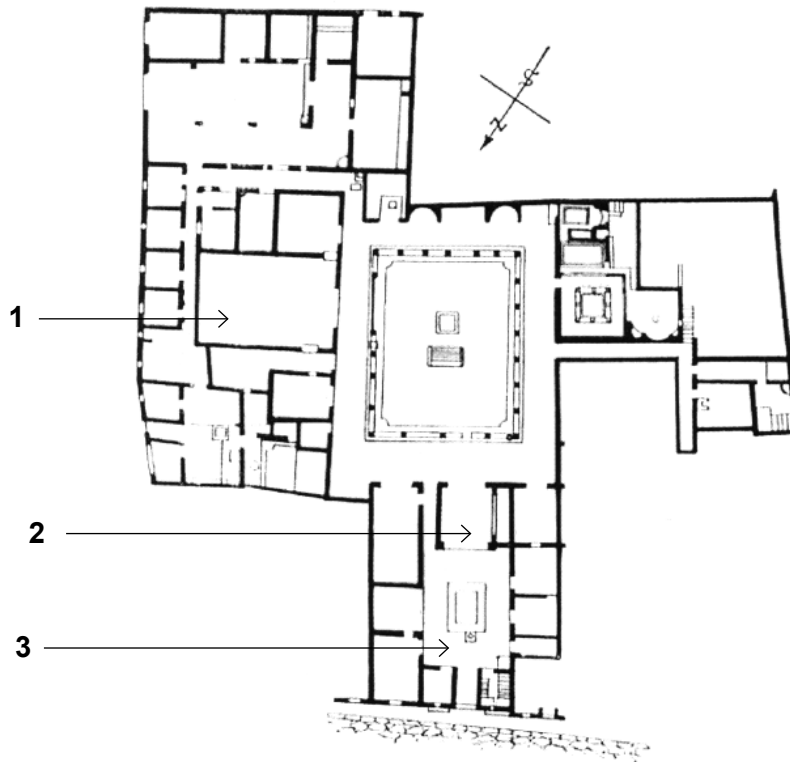

- | | | | |
|----------|----------|---|------------|
| 0 | 1 | Identify the areas marked 1 , 2 and 3 on Plan A . | (3 marks) |
| 0 | 2 | Name two other buildings or areas associated with the House of the Menander. | (2 marks) |
| 0 | 3 | To what extent was the expansion of the House of the Menander and its decoration typical of the way Pompeian <i>domus</i> developed? | (10 marks) |
| 0 | 4 | <p>How effectively did the the development of housing in Ostia meet the changing needs of its inhabitants? Refer to specific examples of housing in your answer.</p> <p>You might include discussion of</p> <ul style="list-style-type: none"> • the circumstances in which <i>insulae</i> appeared in Ostia • what <i>insulae</i> offered that the standard <i>domus</i> did not • differences in the design of <i>insulae</i> • when and why <i>domus</i> reappeared in Ostia. | (20 marks) |

OR

Option B

Study the plan below and answer Questions 05 to 09 which follow.

Plan B Forum Baths, Ostia

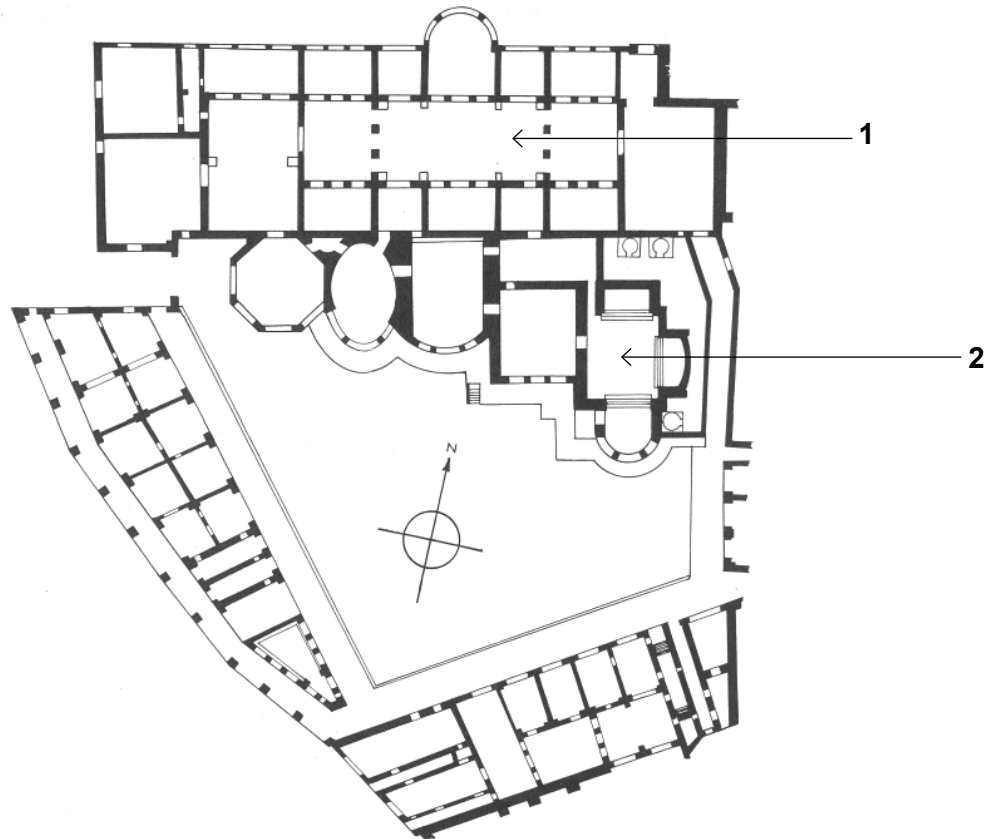

0 5 Give the approximate date when the Forum Baths at Ostia were first built. (1 mark)

0 6 Name the areas marked **1** and **2** on **Plan B**. (2 marks)

0 7 How was water supplied to the Forum Baths? Give **two** details. (2 marks)

0 8 How well did the design and decoration of the Forum Baths at Ostia meet the comfort and other needs of the users? Give specific details. (10 marks)

0 9 How effectively did the Baths of Caracalla in Rome fulfil their purposes?

You might include discussion of

- the reasons why Caracalla began the Baths
- the layout of the Baths themselves and of the complex as a whole
- the materials and structural techniques used
- the decoration of the Baths
- the range of facilities and amenities.

(20 marks)

Turn over ►

Section Two

Choose **either** Option C **or** Option D and answer the question below.

You may use drawings and diagrams to illustrate your answer.

EITHER

Option C

1	0
---	---

To what extent did the theatres **and** amphitheatres you have studied reflect the needs of those who commissioned them **and** to what extent did other factors play a part in their design? Refer to specific examples you have studied.

You might include discussion of

- why and when particular theatres and amphitheatres were built
- differences and similarities between theatres in layout, materials, structure and decoration
- differences and similarities between the amphitheatre at Pompeii and the Colosseum in Rome
- how far the design of theatres and amphitheatres provided for the needs of spectators and performers. (30 marks)

OR

Option D

1	1
---	---

'A forum, with its associated buildings, reflected the particular needs of its city.'

To what extent was this true of Pompeii, Ostia and Rome?

You might include discussion of

- when and why the forums in these cities were built
- the layout of each forum and the buildings associated with it
- how social factors influenced the development of the forums
- the influence of political changes on the development of the forums. (30 marks)

END OF QUESTIONS

ACKNOWLEDGEMENT OF PUBLISHERS AND COPYRIGHT-HOLDERS

Plan A *Wohnen in der Antike*, E BRÖDNER, Wissenschaftliche Buchgesellschaft, 1989

Plan B Figure 75, page 131, *Roman Architecture*, FRANK SEAR. © Cornell University Press, 1993

Copyright © 2010 AQA and its licensors. All rights reserved.