



General Certificate of Education
Advanced Subsidiary Examination
June 2014

Archaeology

ARCH2

Unit 2 Archaeological Skills and Methods

Sources Booklet

A

Sources for use in answering the questions in Section A

Introduction: The Rocks, Sydney

The Rocks is a neighbourhood in Sydney, Australia. The archaeological excavations of the Cumberland Street/Gloucester Street area of the Rocks were carried out in the mid 1990s. They allowed archaeologists a glimpse into the development of this area from Aboriginal occupation through the settlement by convicts from 1788, to the working class neighbourhood of the nineteenth century.

The project involved nine archaeologists, a project historian and 400 volunteers. The excavations took 20 weeks and focussed on an area that covered two half-city blocks and contained the remains of 42 houses. The site produced over 750 000 artefacts and the results of the excavation have been interpreted and presented in both the Big Dig Archaeology Education Centre and the Rocks Discovery Museum.

Map 1 Map showing the location of Sydney



Figure 1 Plan of the position of the areas of excavation between Cumberland Street and Gloucester Street

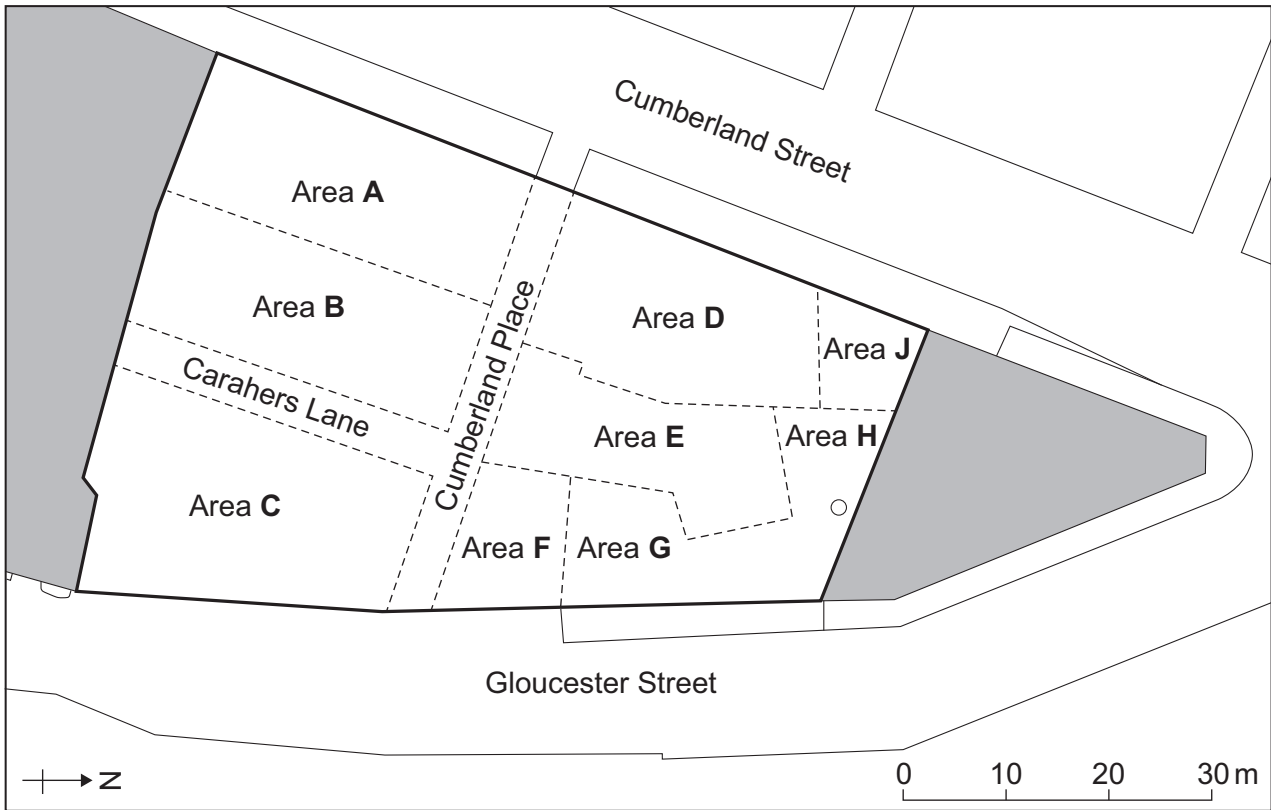

Figure 2 A view over the site to the north-east during the early stages of excavation



Turn over ►

Figure 3 Photograph of Cumberland Place which connects Cumberland Street and Gloucester Street in 1901



Figure 4 The excavations at the Cumberland Street/Gloucester Street site at a later stage than Figure 2



Figure 5 Members of the local community excavating at the Cumberland Street/ Gloucester Street site



Turn over ▶

Figure 6(a) Backroom, doorway and yard of 93 Gloucester Street under excavation



Figure 6(b) Plans of 83, 85 and 87 Gloucester Street shortly before demolition in 1902

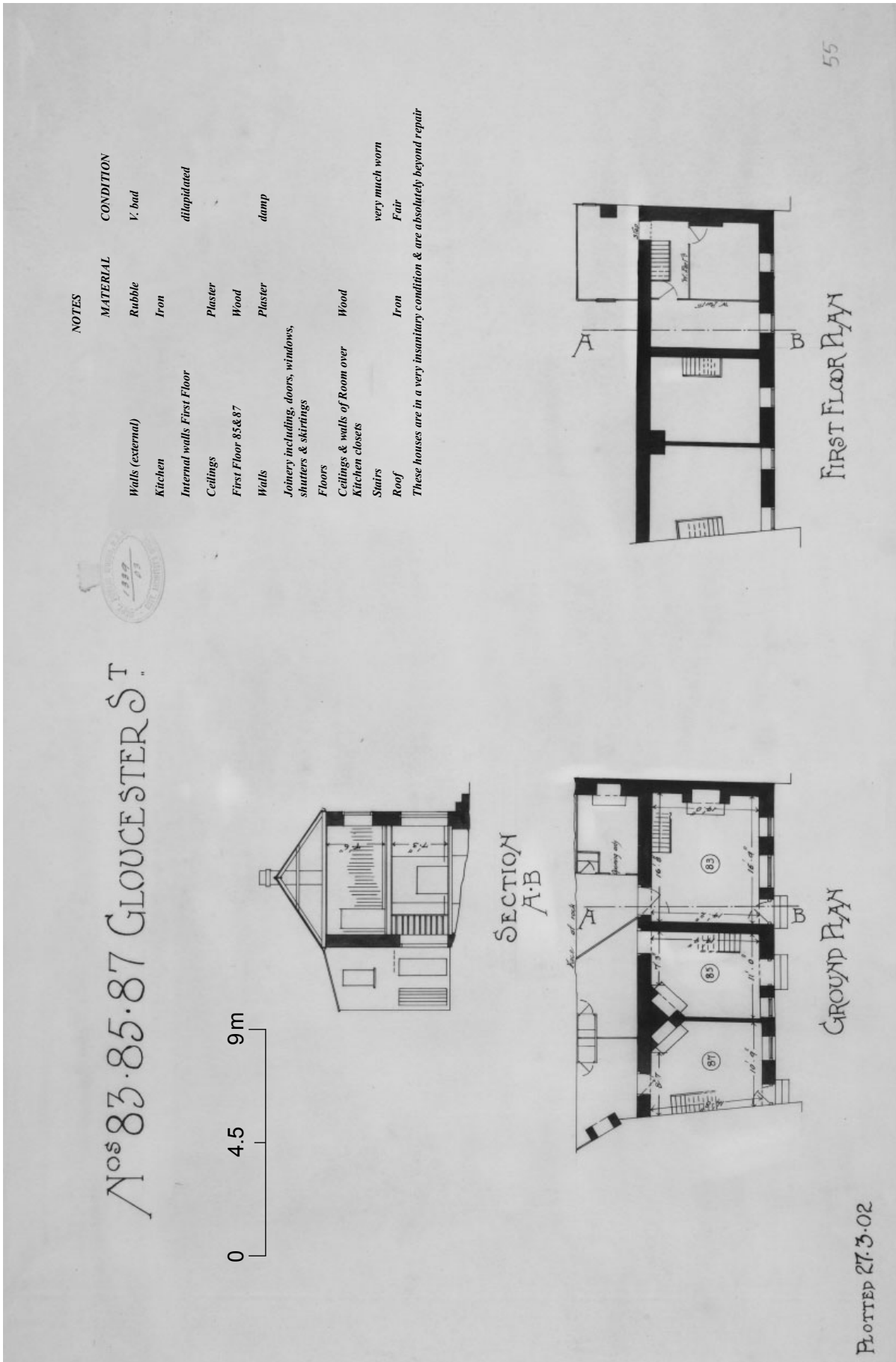

Turn over ▶

Figure 7 Cattle horn cores and pelvis in Area A of the plan in Figure 1 (scale shows centimetre intervals)

Glossary: horn core - the bony parts of the cattle skull that horns grow over.



Figure 8(a) Sherds from transfer printed ware dinner and tea sets

Glossary: transfer printed ware - cheap, mass produced pottery, examples of which include blue and white willow pattern.



Figure 8(b) Large earthenware storage jar (scale shows 10 centimetre intervals)

Glossary: earthenware - a type of low quality pottery.



Turn over for the next source

Turn over ▶

Figure 9 Greenstone ornament found on site, probably a small imported Maori earring from New Zealand



END OF SOURCES

There are no sources printed on this page

There are no sources printed on this page

Acknowledgement of copyright-holders and publishers

Permission to reproduce all copyright material has been applied for. In some cases, efforts to contact copyright-holders have been unsuccessful and AQA will be happy to rectify any omissions of acknowledgements in future papers if notified.

Source: Grace Karskens, *Inside The Rocks*, Hale and Iremonger Pty Ltd, 1999.

Figure 1 © Godden Mackay Logan Pty Ltd, based on an illustration by Angela Lober.

Figures 2, 4, 5, 6a, 7, 8a © Patrick Grant, 1994, courtesy of Godden Mackay Logan Pty Ltd.

Figure 6b © Adapted from historical plan, Patrick Grant, 1994, courtesy of Godden Mackay Logan Pty Ltd and State Library of New South Wales.

Figure 3 © State Records NSW.

Figure 8b © Richard Mackay, 1994, courtesy of Godden Mackay Logan Pty Ltd.

Figure 9 © Ionas Kaltenbach, 1995.

Copyright © 2014 AQA and its licensors. All rights reserved.