

ADVANCED SUBSIDIARY GCE
HEALTH AND SOCIAL CARE
Unit 4: Health and Safety in Care Settings

F913

Candidates answer on the Question Paper

OCR Supplied Materials:
None

Other Materials Required:
None

Friday 15 January 2010
Morning

Duration: 1 hour 30 minutes



Candidate Forename		Candidate Surname	
--------------------	--	-------------------	--

Centre Number						Candidate Number				
---------------	--	--	--	--	--	------------------	--	--	--	--

INSTRUCTIONS TO CANDIDATES

- Write your name clearly in capital letters, your Centre Number and Candidate Number in the boxes above.
- Use black ink. Pencil may be used for graphs and diagrams only.
- Read each question carefully and make sure that you know what you have to do before starting your answer.
- Answer **all** the questions.
- Do **not** write in the bar codes.
- Write your answer to each question in the space provided, however additional paper may be used if necessary.

INFORMATION FOR CANDIDATES

- The number of marks is given in brackets [] at the end of each question or part question.
- The total number of marks for this paper is **100**.
- You will be awarded marks for the quality of written communication where an answer requires a piece of extended writing.
- This document consists of **16** pages. Any blank pages are indicated.

1 (a) Identify the **four** warning signs shown below. For each sign describe how it can reduce the risk of harm.

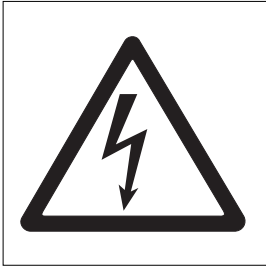

A

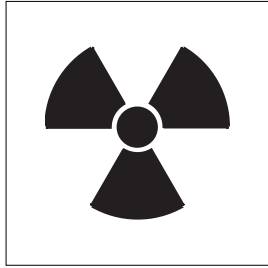

B



C



D

A

.....

.....

.....

B

.....

.....

.....

C

.....

.....

.....

D

.....

.....

..... [8]

(b) (i) Name the legislation that controls the use of dangerous chemicals (date not required).

..... [1]

(ii) Identify **three** substances that are regulated by this legislation. Describe how each should be stored.

1

.....

.....

.....

2

.....

.....

.....

3

.....

.....

..... [6]

[Total: 15]

2 (a) Identify **three** legal requirements for First Aid provision in a care setting.

1

.....

2

.....

3

..... [3]

(b) Identify **three** pieces of information which are required when completing an accident report. For each one give a **different** reason why it is important.

1

.....

.....

.....

.....

2

.....

.....

.....

.....

3

.....

.....

..... [6]

- (c) (i) Give the **full** name of the legislation that controls the reporting of accidents at work (date not required).

..... [1]

- (ii) Outline the key features of this legislation.

.....
.....
.....
.....
.....
.....
.....
.....
.....
.....
.....
.....
.....
.....
.....
.....
.....
.....
.....
.....
.....
.....
..... [5]

[Total: 15]

Plan of Smiley's Nursery

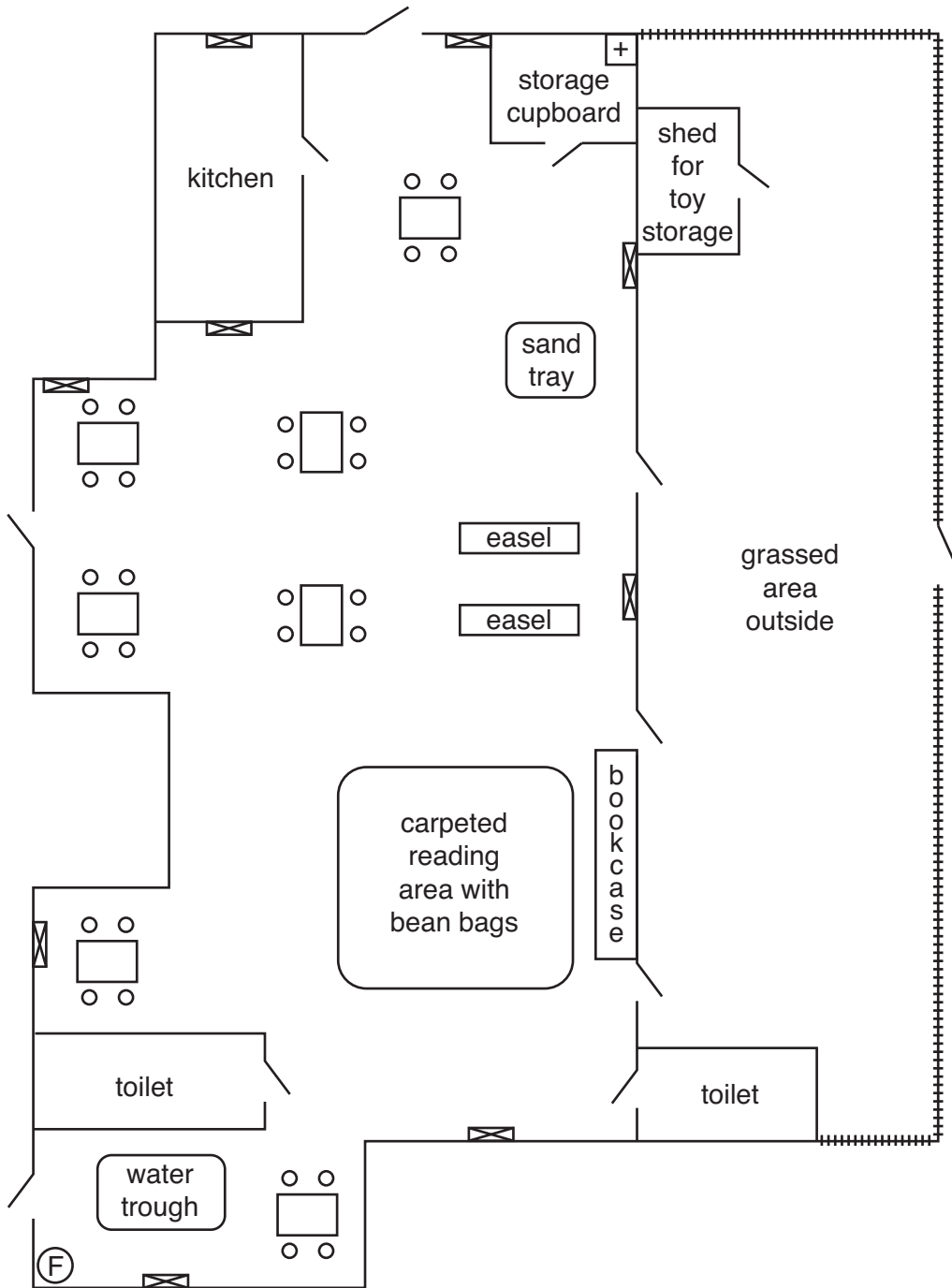

Key:

- door/gate
- chair
- table
- ⊕ first aid kit
- ⊘ plug socket
- ++++ wooden fence
- ⓕ fire extinguisher

..... [15]

(b) The fourth stage of risk assessment is to record the findings. Analyse the importance of this stage to practitioners in a care setting.

..... [5]

[Total : 20]

BLANK PAGE

PLEASE DO NOT WRITE ON THIS PAGE

4 (a) Identify **three** different types of fire extinguisher and describe the situations in which each would be used.

1

.....

.....

.....

2

.....

.....

.....

3

.....

.....

..... [6]

(b) Identify **three** actions and/or pieces of equipment, other than fire extinguishers, that could help reduce the spread of fire in a care setting. For each one explain how it prevents fire from spreading.

1

.....

.....

.....

2

.....

.....

.....

3

.....

.....

..... [6]

PLEASE DO NOT WRITE ON THIS PAGE



Copyright Information

OCR is committed to seeking permission to reproduce all third-party content that it uses in its assessment materials. OCR has attempted to identify and contact all copyright holders whose work is used in this paper. To avoid the issue of disclosure of answer-related information to candidates, all copyright acknowledgements are reproduced in the OCR Copyright Acknowledgements Booklet. This is produced for each series of examinations, is given to all schools that receive assessment material and is freely available to download from our public website (www.ocr.org.uk) after the live examination series.

If OCR has unwittingly failed to correctly acknowledge or clear any third-party content in this assessment material, OCR will be happy to correct its mistake at the earliest possible opportunity.

For queries or further information please contact the Copyright Team, First Floor, 9 Hills Road, Cambridge CB2 1GE.

OCR is part of the Cambridge Assessment Group; Cambridge Assessment is the brand name of University of Cambridge Local Examinations Syndicate (UCLES), which is itself a department of the University of Cambridge.