



General Certificate of Education
Advanced Subsidiary Examination
June 2014

Classical Civilisation

CIV2E

Unit 2E Roman Architecture and Town Planning

Friday 6 June 2014 9.00 am to 10.30 am

For this paper you must have:

- an AQA 12-page answer book.

Time allowed

- 1 hour 30 minutes

Instructions

- Use black ink or black ball-point pen.
- Write the information required on the front of your answer book. The **Paper Reference** is CIV2E.
- Answer questions from **two** options.
Choose **one** option from Section 1 and **one** option from Section 2.
Answer **all** questions from the options you have chosen.
- Do all rough work in your answer book. Cross through any work that you do not want to be marked.
Do **not** tear out any part of the book. All work must be handed in.
- If you use more than one book, check that you have written the information required on each book.

Information

- The marks for questions are shown in brackets.
- The maximum mark for this paper is 65.
- You will be marked on your ability to:
 - use good English
 - organise information clearly
 - use specialist vocabulary where appropriate.

Section 1

Choose **either** Option A **or** Option B.

Answer **all** questions from the option you have chosen.

You may use drawings and diagrams in your answers.

Either

Option A

Study the plan below and answer Questions 01 to 04 which follow. The plan shows the House of the Vettii in Pompeii.

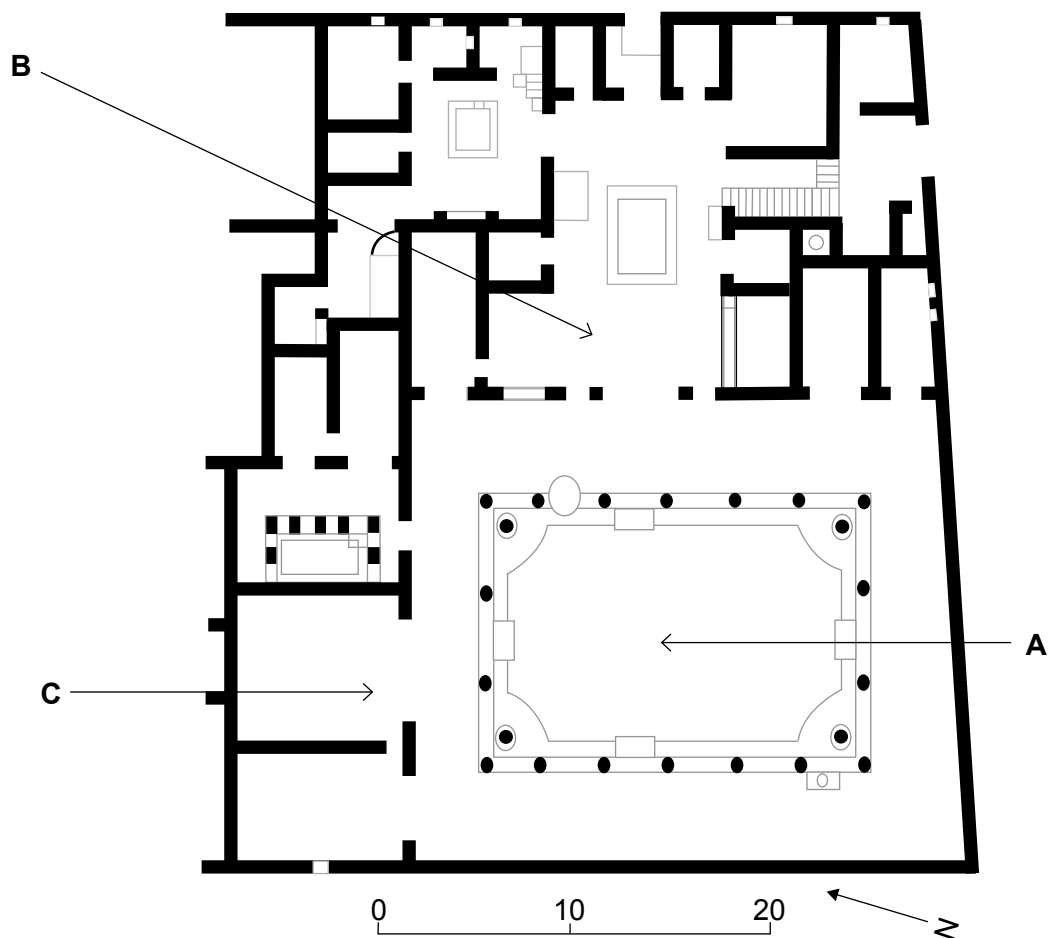

0 | 1 Identify the areas marked **A**, **B** and **C** on the plan.

[3 marks]

0 | 2 Name **two** of the basic materials used to construct a *domus* at Pompeii.

[2 marks]

0	3
---	---

To what extent do the design **and** decoration of the House of the Vettii suggest that its owners were wealthy?

[10 marks]

0	4
---	---

To what extent do **other** *domus* at Pompeii and Herculaneum show variety in their designs and decorations?

Give reasons for your answer and refer to at least **three** examples of *domus*. Do **not** discuss the House of the Vettii.

You might include discussion of:

- position, size and original layout
- materials and techniques of construction
- any changes over time
- gardens
- decoration.

[20 marks]

Turn over for Option B

Turn over ▶

or

Option B

Study the diagram below and answer Questions 05 to 09 which follow. The diagram shows a section of the Colosseum in Rome.

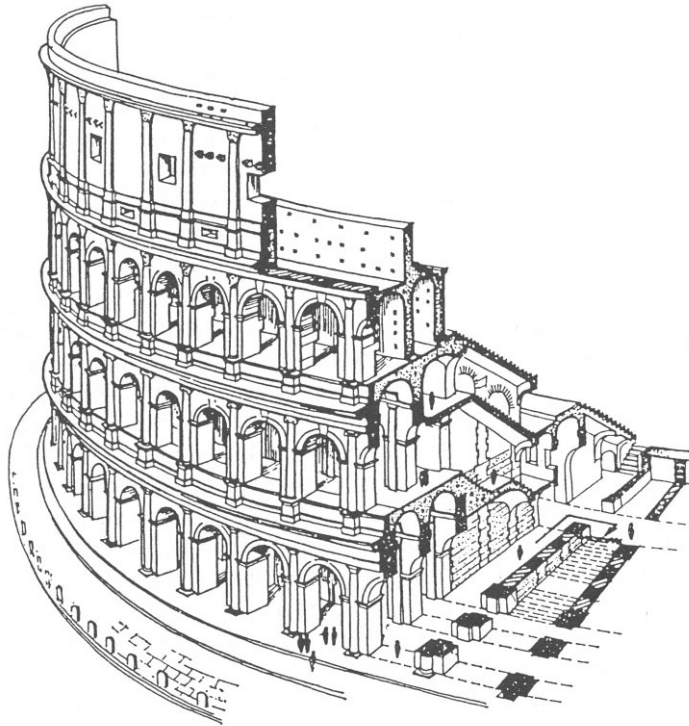

0 5

At about what date was the Colosseum completed?

[1 mark]

0 6

Name **three** materials used in the construction of the Colosseum.

[3 marks]

0 7

What was the shape of the Colosseum?

[1 mark]

0 8

How successful, in your opinion, was the **external** design of the Colosseum?

[10 marks]

0	9
---	---

'The amphitheatre at Pompeii fulfilled its functions less effectively than the Colosseum in Rome did.'

To what extent do you agree? Give reasons for your answer and refer to both amphitheatres.

You might include discussion of:

- the social and political reasons for their construction
- their siting and appearance
- their design, use of materials and construction techniques
- health and safety
- provision of different kinds of facilities and entertainment.

[20 marks]

Turn over for Section 2

Turn over ►

Section 2

Choose **either** Option C **or** Option D and answer the question below.

You may use drawings and diagrams in your answer.

Either

Option C

1 0

'The design and uses of the forum at Pompeii were very different from those of the Forum of Augustus and the Forum of Trajan in Rome.'

To what extent do you agree? Give reasons for your answer and refer to these forums and their associated buildings.

You might include discussion of:

- when, where and why each forum was built
- the layout of each forum and its associated buildings
- business and social uses
- religious and political uses.

[30 marks]

or

Option D

1 1

'Temples within the city of Rome were very different from those in other Roman cities.'

To what extent do you agree? Give reasons for your answer and refer to at least **two** temples from the city of Rome **and two** from other cities.

You might include discussion of:

- when and why each temple was built
- size and position
- design, materials and construction techniques
- religious, social and political uses.

[30 marks]

END OF QUESTIONS

There are no questions printed on this page

There are no questions printed on this page

Acknowledgement of copyright-holders and publishers

Permission to reproduce all copyright material has been applied for. In some cases efforts to contact copyright-holders have been unsuccessful and AQA will be happy to rectify any omissions of acknowledgements in future papers if notified.

Option A/B, *Roman Domestic Buildings* edited by Ian M Barton (University of Exeter Press 1996, 2003) © Liverpool University Press. Image © Ian M Barton.

Copyright © 2014 AQA and its licensors. All rights reserved.