

OXFORD CAMBRIDGE AND RSA EXAMINATIONS
AS GCE
F913/01
HEALTH AND SOCIAL CARE
Health and Safety in Care Settings
WEDNESDAY 20 MAY 2015: Morning
DURATION: 1 hour 30 minutes
plus your additional time allowance
MODIFIED ENLARGED 24pt

Candidate forename						Candidate surname				
Centre number						Candidate number				

Candidates answer on the Question Paper.

OCR SUPPLIED MATERIALS:

None

OTHER MATERIALS REQUIRED:

None

READ INSTRUCTIONS OVERLEAF

INSTRUCTIONS TO CANDIDATES

Write your name, centre number and candidate number in the boxes on the first page. Please write clearly and in capital letters.

Use black ink. HB pencil may be used for graphs and diagrams only.

Answer ALL the questions.

Read each question carefully. Make sure you know what you have to do before starting your answer.

Write your answer to each question in the space provided. If additional space is required, you should use the lined pages at the end of this booklet. The question number(s) must be clearly shown.

INFORMATION FOR CANDIDATES

The number of marks is given in brackets [] at the end of each question or part question.

The total number of marks for this paper is 100.

The quality of written communication will be assessed in your answers to questions marked with an asterisk (*).

Any blank pages are indicated.

BLANK PAGE

1 Both of these warning signs are often seen in hospital.

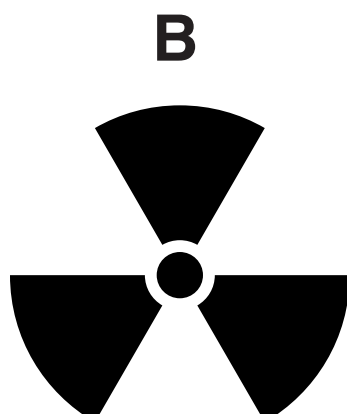
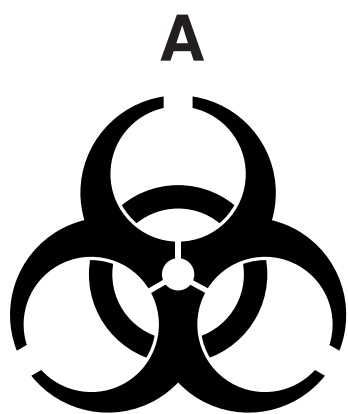

(a) Identify each of the two signs.

A _____

B _____

[2]

(b) For each sign explain the risk of harm to staff that is likely to be caused by the hazard concerned.

A _____

B _____

[4]

(c) Explain ONE measure which should be put in place for each danger to reduce the risk of harm.

A _____

B _____

[4]

(d) Identify the legislation that controls the use of warning signs such as those shown.

[1]

(e) (i) Give the FULL name of the organisation responsible for enforcing this legislation.

[1]

(ii) State THREE ways in which this organisation could enforce legislation.

[3]

[TOTAL: 15 MARKS]

BLANK PAGE

2 One important piece of Health and Safety legislation is known as RIDDOR.

(a) Give the full title of this legislation.

[1]

(b)* Explain how safety in a care setting is improved by the enforcement of this legislation.

[5]

(c) Define the term ‘Standard Precautions’.

[2]

[illegible]

9

3 Plan of a Medical Centre

KEY

- door
- chair
- F

fire extinguisher
- CR

consulting room
- FE

fire exit
- TB

toy box
- steps

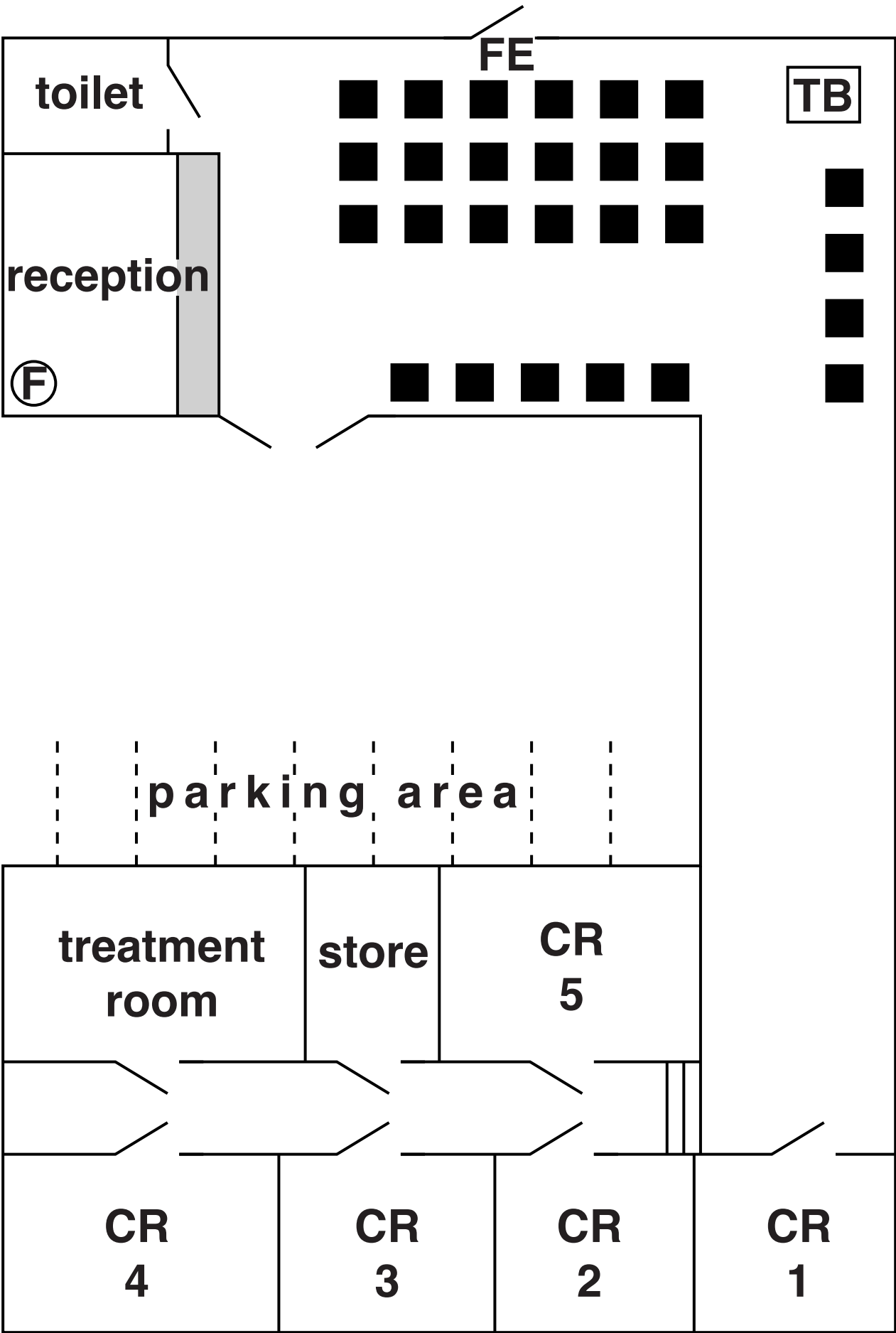

[illegible]

[5]

[TOTAL: 20 MARKS]

4 (a) Give the full name of TWO pieces of legislation controlling the moving and handling of people who use services.

[2]

(b)* Describe how legislation controlling moving and handling aims to reduce the risk of harm to a care worker.

[6]

[illegible]

[illegible]

[TOTAL: 20 MARKS]

This image shows a blank sheet of white paper with horizontal ruling lines. The lines are evenly spaced and run across the width of the page. In the bottom right corner, there is a small black box containing the number "7".

[illegible]

[TOTAL: 15 MARKS]

[illegible]

[illegible]

END OF QUESTION PAPER

ADDITIONAL ANSWER SPACE

If additional answer space is required, you should use the following lined page(s). The question number(s) must be clearly shown in the margins.

[illegible]

Copyright Information

OCR is committed to seeking permission to reproduce all third-party content that it uses in its assessment materials. OCR has attempted to identify and contact all copyright holders whose work is used in this paper. To avoid the issue of disclosure of answer-related information to candidates, all copyright acknowledgements are reproduced in the OCR Copyright Acknowledgements Booklet. This is produced for each series of examinations and is freely available to download from our public website (www.ocr.org.uk) after the live examination series.

If OCR has unwittingly failed to correctly acknowledge or clear any third-party content in this assessment material, OCR will be happy to correct its mistake at the earliest possible opportunity.

For queries or further information please contact the Copyright Team, First Floor, 9 Hills Road, Cambridge CB2 1GE.

OCR is part of the Cambridge Assessment Group; Cambridge Assessment is the brand name of University of Cambridge Local Examinations Syndicate (UCLES), which is itself a department of the University of Cambridge.

